

ACCESSORI PER SCORREVOLI

Accessories for sliding units

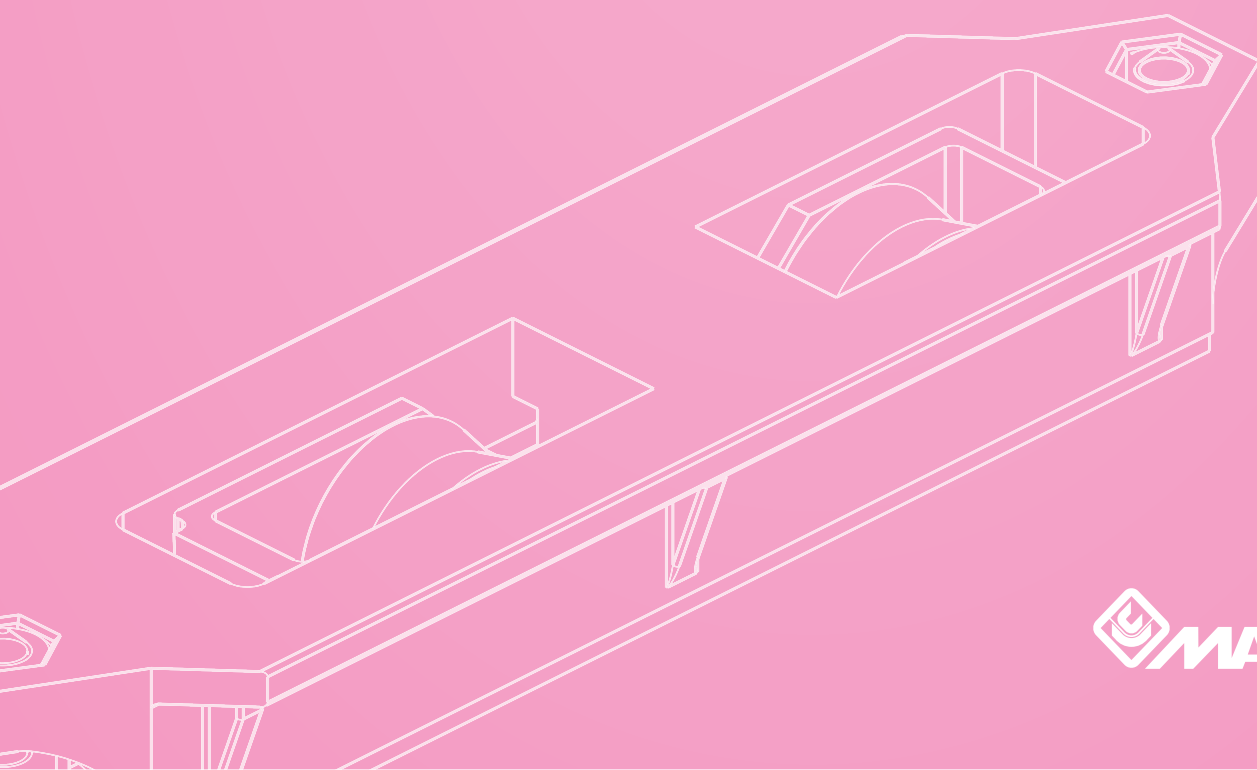

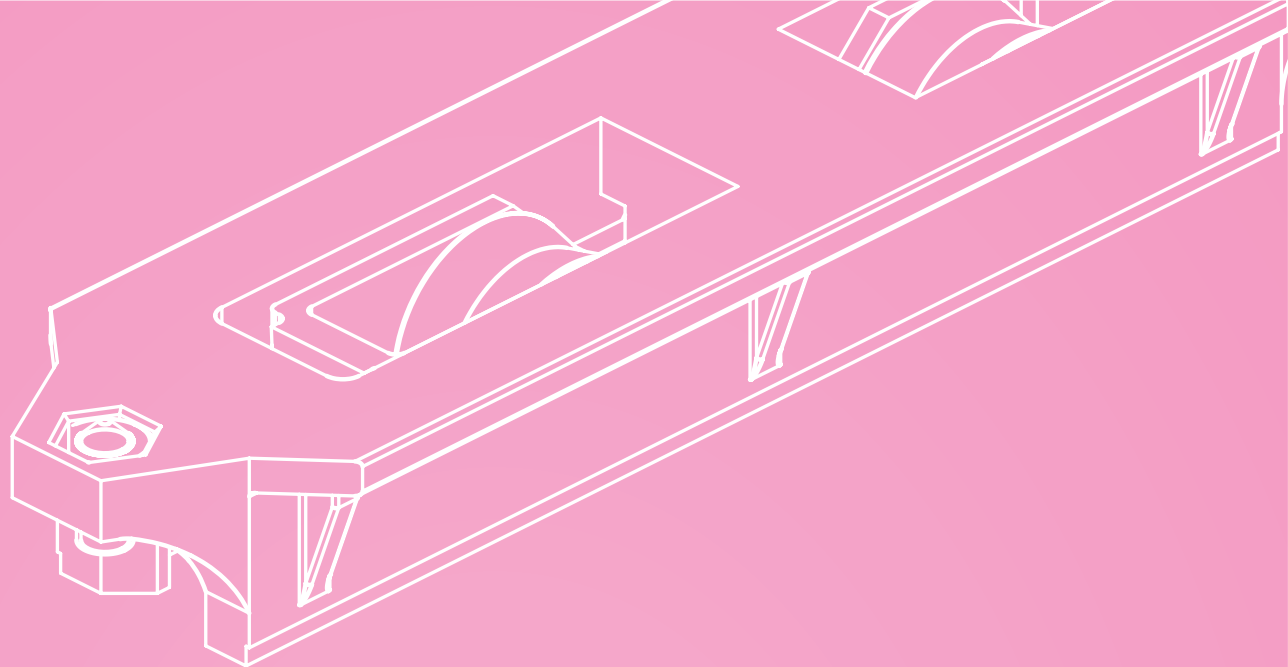

ACCESSORI PER SCORREVOLI

Accessories for sliding units

VIPER

PARACOLPI PER SISTEMI SCORREVOLI AD APPLICARE

PARACOLPI PER SISTEMI SCORREVOLI AD APPLICARE | DOOR BUMPER FOR SLIDING
BUTÉE DE COULISSANT | AMORTIGUADOR PARA CORREDERAS



Corpo in alluminio
pressofuso; gommino
paracolpi in TPE; vite
TSPCR autofilettante in
acciaio inox.



Die-cast aluminum body;
bumper plug in TSPCR;
stainless steel self-
threading screw TSPCR.



Corps en aluminium
moulé sous pression;
tampon en TPE; vis
TSPCR autotaradeuse en
acier inox.



Cuerpo en aluminio de
fundición; amortiguador
de goma en TPE; tornillo
auto-roscante TSPCR en
acero inoxidable.



CONFEZIONAMENTO E FINITURE | PACKAGE AND FINISHINGS | CONDITIONNEMENT ET FINITIONS | EMBALAJE Y ACABADOS

ART.	6844.1					
Imballo Package Conditionnement Embalaje	40 Pz					
Finiture disponibili Available finishes Finitions disponibles Acabados disponibles	1	2	3	4	5	6

SERIE SERIES	ART.
Universale Universal	6844.1

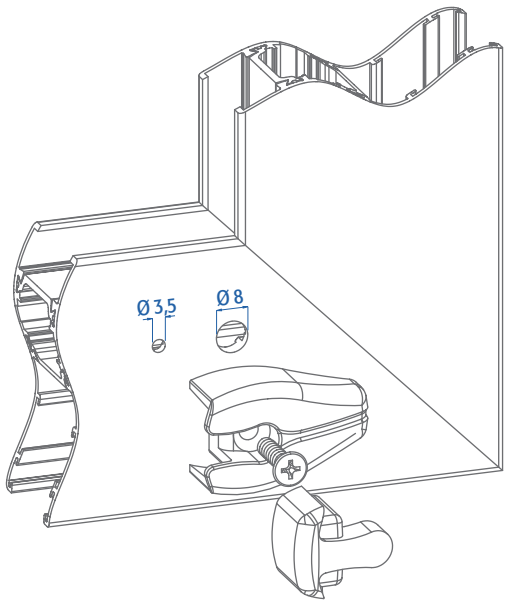
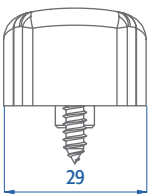
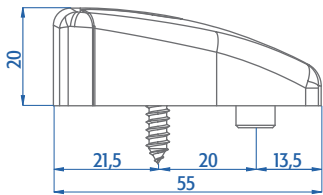

MIDKIT

LINEA QUALITÀ PER SERIE SCORREVOLE

KIT DI ASSEMBLAGGIO | ASSEMBLING KIT
KIT D'ASSEMBLAGE | KIT DE MONTAJE



Squadrette di allineamento in nylon o alluminio; tasselli ammortizzatore, tappi coprilavorazione e boccole di drenaggio in nylon; tassello tenuta centrale in alluminio estruso; carrelli con supporto esterno in nylon, supporto interno in acciaio zincato e cuscinetti a sfera in acciaio temprato rivestito in nylon con fibra di vetro. Portata carrelli: 90 kg per anta.



Alignment corners in nylon or aluminium; nylon shock-absorber elements, plugs and drainage bushes; extruded aluminium central sealing element, roller with nylon external support, galvanized steel internal support and bearing in tempered steel covered by nylon with glass fiber. Load of the roller: 90 kg per sash.



Equerres d'alignement en nylon ou aluminium; tasseaux amortisseur, bouchons cache-usinage et clapet d'évacuation en nylon; tasseau étanchéité en aluminium extrudé; chariots avec support extérieur en nylon, support intérieur en acier zingué et roulements à billes en acier trempé revêtus en nylon avec fibre de verre. Portée chariots: 90 kg chaque vantail.



Escuadras de alineación en nylon o aluminio; tacos amortiguadores, tapas y tapas de salida de agua en nylon; taco retenedor central en aluminio extruido; ruedas con exterior en nylon y interior en acero galvanizado, y bolas en acero templado cubrido con fibra de vidrio. Carga máxima de las ruedas: 90 kg por hoja.

CONFEZIONAMENTO E FINITURE | PACKAGING AND FINISHES | CONDITIONNEMENT ET FINITIONS | EMBALAJE Y ACABADOS

ART.	6601.11A	6601.1 6601.2 6601.3 6601.4 6601.5 6601.7
Imballo Package Conditionnement Embalaje	10 Kit	20 Kit
Finiture disponibili Available finishes Finitions disponibles Acabados disponibles	1 2 3 4 5 6	1 2 3 4 5 6

ESTRUSORE EXTRUDER	SERIE SERIES	ART.
ALCAN	Abithal Runner	6601.4
ALL.CO	Export 60 S	6601.1
EKU Sistemi (Gruppo Profilati)	PE 60 slide	6601.1
EQUIPE	Sistemi 8000 S	6601.1
ETNALL	40000	6601.3
HYDRO	Domal 40 S	6601.4
INDINVEST	Alpha 650 S	6601.1
METRA	NC 60 Int.	6601.3
OCMA	FC 70 Parigi	6601.4
PASSERINI	Skeit 60	6601.2
	Skeit 60 super anta da 32	6601.11A
	Skeit 70	6601.7
RALOX	Ayrton 60	6601.5

CONTINUA | CONTINUES | CONTINUE | CONTINÚA >

< SEGUE DALLA PAGINA PRECEDENTE | CONTINUED FROM PREVIOUS PAGE | SUIT DE LA PAGE PRECEDENTE | CONTINÚA DE LA PÁGINA ANTERIOR

RIF.	DESCRIZIONE DESCRIPTION	NUM.
1	Squadrette di allineamento Alignment corner joints	16
2	Carrelli Roller	4
3	Tasselli ammortizzatore antiscarrucolamento Safety shock-absorber block	4
4	Tappi coprilavorazione Cover plugs	4
5	Tasselli tenuta centrale con spazzolino Block with center seal and brush	2
6	Boccole di drenaggio Drainage bushes	3

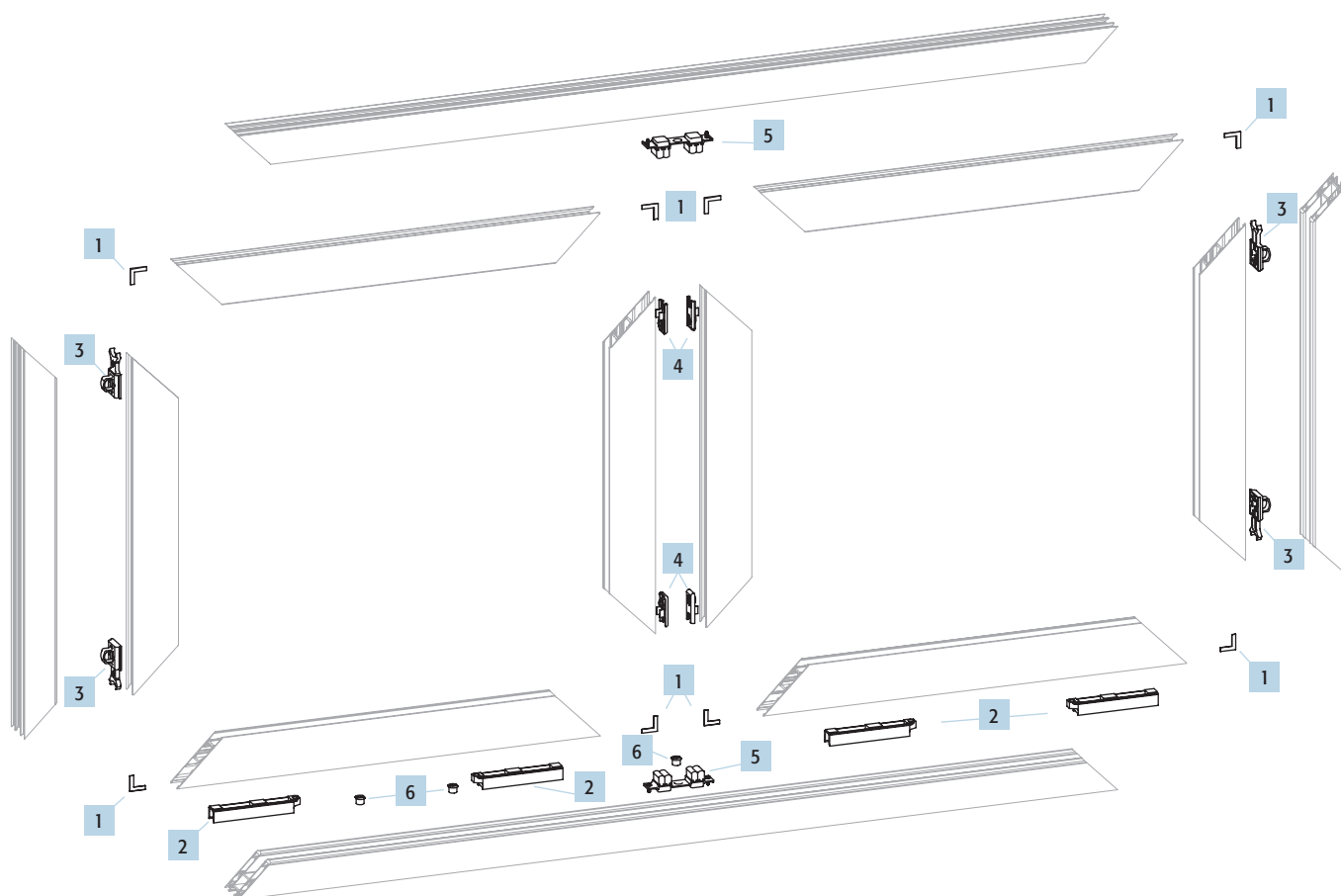

MIDKIT

LINEA QUALITÀ PER SERIE SCORREVOLE

KIT DI ASSEMBLAGGIO CON MANIGLIE E SQUADRETTE | ASSEMBLING KIT WITH HANDLES AND CORNERS | KIT D'ASSEMBLAGE AVEC POIGNEES ET EQUERRES | KIT DE MONTAJE CON MANILLAS Y ESCUADRAS



Squadrette di allineamento in nylon o alluminio; tasselli ammortizzatore, tappi coprilavorazione, boccole di drenaggio in nylon; tassello tenuta centrale in alluminio estruso; carrelli con supporto esterno in nylon, supporto interno in acciaio zincato e cuscinetti a sfera in acciaio temprato rivestito in nylon con fibra di vetro; squadrette in alluminio pressofuso; maniglie in nylon; kit di chiusura in acciaio zincato. Portata carrelli: 90 kg per anta.



Alignment corners in nylon or aluminium, nylon shock-absorber elements, plugs and drainage bushes; extruded aluminium central sealing element, roller with nylon external support, galvanized steel internal support and bearing in tempered steel covered by nylon with glass fiber; die-cast aluminium corners; nylon handles; galvanized steel closing kit. Load of the roller: 90 kg per sash.



Equerres d'alignement en nylon ou aluminium; tasseaux amortisseur, bouchons cache-usinage, clapet d'évacuation en nylon; tasseau d'étanchéité en aluminium extrudé; chariots avec support extérieur en nylon, support intérieur en acier zingué et roulements à billes en acier trempé revêtus en nylon avec fibre de verre; équerres en aluminium moulé sous pression; poignées en nylon; kit de fermeture en acier zingué. Portée chariots: 90 kg chaque vantail.



Escuadras de alineación en nylon o aluminio, tacos amortiguadores, tapas y tapas de salida de agua en nylon; taco retenedor central en aluminio extruido; ruedas con exterior en nylon y interior en acero galvanizado, y bolas en acero temperado cubrido con fibra de vidrio; escuadras en aluminio de fundición; manillas en nylon; kit de cierre en acero cincado. Carga máxima de las ruedas: 90 kg por hoja.

CONFEZIONAMENTO E FINITURE | PACKAGE AND FINISHINGS | CONDITIONNEMENT ET FINITIONS | EMBALAJE Y ACABADOS

ART.	TUTTI ALL TOUS TODOS					
Imballo Package Conditionnement Embalaje	1 Kit					
Finiture disponibili Available finishes Finitions disponibles Acabados disponibles	1	2	3	4	5	6

ESTRUSORE EXTRUDER	SERIE SERIES	ART.	ART. KIT DI ASSEMBLAGGIO SENZA MANIGLIE ASSEMBLING KIT WITHOUT HANDLES
ALCAN	Abithal Runner	6620.5	
ALL.CO	Export 60 S	6620.2	6620.10
EKU Sistemi (Gruppo Profilati)	PE 60 slide	6620.2	6620.10
EQUIPE	Sistemi 8000 S	6620.1	6620.9
ETNALL	40000	6620.4	6620.12
HYDRO	Domal 40 S	6620.7	6620.15
INDINVEST	Alpha 650 S	6620.6	
METRA	NC 60 Int.	6620.4	6620.12
OCMA	FC 70 Parigi	6620.5	
PASSERINI	Skeit 60	6620.3	6620.11
	Skeit 60 super anta da 32	6620.21A	
	Skeit 70	6620.24	
RALOX	Ayrton 60	6620.8	6620.16

CONTINUA | CONTINUES | CONTINUE | CONTINÚA >

< SEGUE DALLA PAGINA PRECEDENTE | CONTINUED FROM PREVIOUS PAGE | SUIT DE LA PAGE PRECEDENTE | CONTINÚA DE LA PÁGINA ANTERIOR

RIF.	DESCRIZIONE DESCRIPTION	NUM.
1	Squadrette di allineamento Alignment corner joints	16
2	Carrelli Roller	4
3	Tasselli ammortizzatore antiscarrucolamento Safety shock-absorber block	4
4	Tappi coprilavorazione Cover plugs	4
5	Tasselli tenuta centrale con spazzolino Block with center seal and brush	2
6	Boccole di drenaggio Drainage bushes	3
7	Maniglie ad incasso Embedded handles	2
8	Kit di chiusura Closing kit	2
9	Squadrette telaio Frame corner joints	4 8 *
10	Squadrette anta Sash corner joints	8

* In alcuni kit ci sono 8 squadrette | In some kits there are 8 corner joints

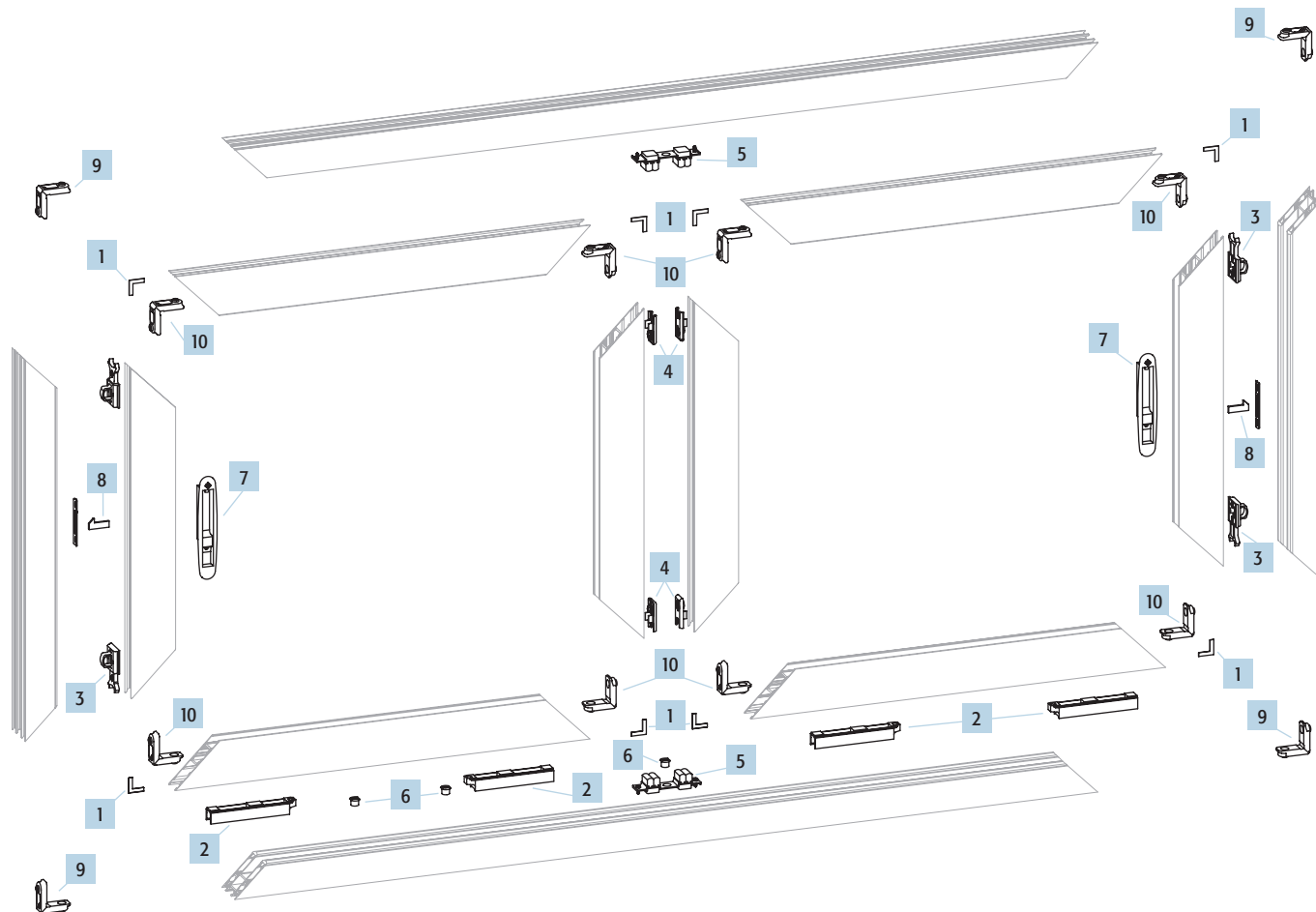

TOPKIT

LINEA FORTE PER SERIE SCORREVOLE

KIT DI ASSEMBLAGGIO | ASSEMBLING KIT
KIT D'ASSEMBLAGE | KIT DE MONTAJE



Squadrette di allineamento in nylon o alluminio; tasselli ammortizzatore, tappi coprilavorazione in nylon; tassello tenuta centrale in alluminio estruso; carrelli con supporto esterno in nylon, supporto interno in zama zincata e cuscinetti a sfera in acciaio temprato rivestito in nylon con fibra di vetro. Portata carrelli: 100 kg per anta.



Nylon or aluminium alignment corners, nylon shock-absorber elements and plugs; extruded aluminium central sealing element; rollers with nylon external support, galvanized zamak internal support and bearing in tempered steel covered by nylon with glass fiber. Load of the roller: 100 kg per sash.



Equerres d'alignement en nylon ou aluminium; tasseaux amortisseur, bouchons cache-usinage en nylon; tasseau étanchéité en aluminium extrudé; chariots avec support extérieur en nylon, support intérieur en zamak zinguée et roulements à billes en acier trempé revêtus en nylon avec fibre de verre. Portée chariots: 100 kg chaque vantail.



Escuadras de alineación en nylon o aluminio, tacos amortiguadores y tapas en nylon; taco retenedor central en aluminio extruido; ruedas con exterior en nylon y interior en zamac galvanizada, y bolas en acero templado cubrido en nylon con fibra de vidrio. Carga máxima de las ruedas; 100 kg por hoja.

CONFEZIONAMENTO E FINITURE | PACKAGING AND FINISHES | CONDITIONNEMENT ET FINITIONS | EMBALAJE Y ACABADOS

ART.	6601Z.1 6601Z.5 6601Z.10 6601Z.19 6601Z.20 6601Z.20 6601Z.21 6601Z.23	6601Z.2 6601Z.3 6601Z.4 6601Z.8 6601Z.12 6601Z.13 6601Z.24 6601Z.31 6601Z.34 6601Z.38
Imballo Package Conditionnement Embalaje	10 Kit	20 Kit
Finiture disponibili Available finishes Finitions disponibles Acabados disponibles	1 2 3 4 5 6	1 2 3 4 5 6

ESTRUSORE EXTRUDER	SERIE SERIES	ART.
ALCAN	Abithal Runner	6601Z.4
ALEXIA	Alexia Slide 650 S	6601Z.5
	Alexia Slide 650 TT	6601Z.5
ALL.CO	All.co Wood S	6601Z.19
	Export 60 S	6601Z.1
	Triall.co 65-90	6601Z.5
DFV	Triall.co 65-90 TT	6601Z.5
	Classic Slide 650 S	6601Z.5
EQUITE	Classic Slide 650 TT	6601Z.5
	PE 60 slide	6601Z.1
	PE 70	6601Z.20
ETA	PE 70 TT	6601Z.21
	Sistemi 8000 S	6601Z.1
ETNALL	Start 900 S	6601Z.34
	Start 900 STT	6601Z.34
	Start 1000 WS	6601Z.38
GASTALDELLO	TTSC 80	6601Z.5
	40000	6601Z.3
	40600	6601Z.5
HYDRO	Euroline 60 SN	6601Z.24
	Domal 40 S	6601Z.4
	Domal slide 56 prof. 26255/26265	6601Z.12

ESTRUSORE EXTRUDER	SERIE SERIES	ART.
INDINVEST	Alpha 650 S	6601Z.1
	Gold 650 S	6601Z.10
	Gold 650 ST	6601Z.22
METRA	NC 60 Int.	6601Z.3
OCMA	FC 70 Parigi	6601Z.4
PASSERINI	Skeit 60	6601Z.2
	Skeit 60 super anta da 36	6601Z.13
	Skeit 60 super TH	6601Z.31
	Skeit 70	6601Z.8
PONZIO	Sliding 600	6601Z.24
TP PROFILATI	Ekos 60 STH	6601Z.23

CONTINUA | CONTINUES | CONTINUE | CONTINÚA >

< SEGUE DALLA PAGINA PRECEDENTE | CONTINUED FROM PREVIOUS PAGE | SUIT DE LA PAGE PRECEDENTE | CONTINÚA DE LA PÁGINA ANTERIOR

RIF.	DESCRIZIONE DESCRIPTION	NUM.
1	Squadrette di allineamento Alignment corner joints	16
2	Carrelli Roller	4
3	Tasselli ammortizzatore antiscarrucolamento Safety shock-absorber block	4
4	Tappi coprilavorazione Cover plugs	4
5	Tasselli tenuta centrale con spazzolino Block with center seal and brush	2
6	Boccole di drenaggio Drainage bushes	3

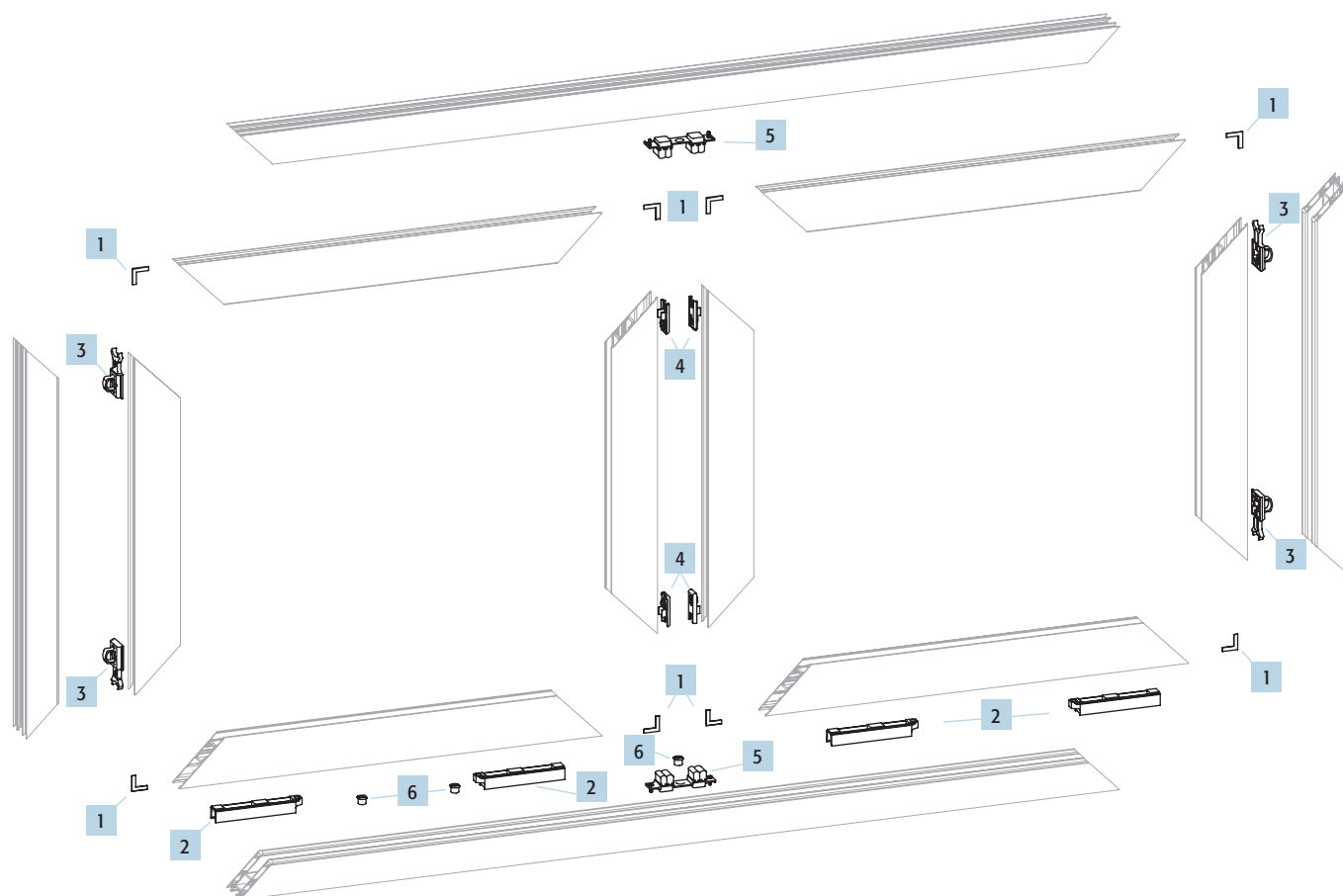

TOPKIT

LINEA FORTE PER SERIE SCORREVOLE

KIT DI ASSEMBLAGGIO CON MANIGLIE E SQUADRETTE | ASSEMBLING KIT WITH HANDLES AND CORNERS | KIT D'ASSEMBLAGE AVEC POIGNEES ET EQUERRES | KIT DE MONTAJE CON MANILLAS Y ESCUADRAS



Squadrette di allineamento in nylon o alluminio; tasselli ammortizzatore, tappi coprilavorazione in nylon; tasselli tenuta centrale in alluminio; carrelli con supporto esterno in nylon, supporto interno in zama zincata e cuscinetti a sfera in acciaio temprato rivestito in nylon con fibra di vetro; squadrette in alluminio pressofuso o nylon; maniglie con cassa in alluminio estruso e leva in zama; kit di chiusura in acciaio inox AISI 441. Portata carrelli: 100 kg per anta.



Nylon or aluminium alignment corners, nylon shock-absorber elements and plugs; extruded aluminium central sealing element; rollers with nylon external support, galvanized zamak internal support and bearing in tempered steel covered by nylon with glass fiber; die-cast aluminium or nylon corners; handles with extruded aluminium case and zamak lever; closing kit made of stainless steel AISI 441. Load of the roller: 100 kg per sash.



Equerres d'alignement en nylon ou aluminium; tasseaux amortisseur, bouchons cache-usinage en nylon; tasseaux étanchéité en aluminium; chariots avec support extérieur en nylon, support intérieur en zamak zinguée et roulements à billes en acier trempé revêtus en nylon avec fibre de verre; équerres en aluminium moulé sous pression ou nylon; poignées avec caisse en aluminium extrudé et levier en zamak; kit de fermeture en acier inox AISI 441. Portée chariots: 100 kg pour vantail.



Escuadras de alineación en nylon o aluminio, tacos amortiguadores y tapas en nylon; taco retenedor central en aluminio extruido; ruedas con exterior en nylon y interior en zamac galvanizada, y bolas en acero temperado cubrido en nylon con fibra de vidrio; escuadras en aluminio de fundición o nylon; manillas con cajas en aluminio extruido y leva en zamac; kit de cierre en acero inoxidable AISI 441. Carga máxima de las ruedas; 100 kg por hoja.

CONFEZIONAMENTO E FINITURE | PACKAGE AND FINISHINGS | CONDITIONNEMENT ET FINITIONS | EMBALAJE Y ACABADOS

ART.	TUTTI ALL TOUS TODOS					
Imballo Package Conditionnement Embalaje	1 Kit					
Finiture disponibili Available finishes Finitions disponibles Acabados disponibles	1	2	3	4	5	6

ESTRUSORE EXTRUDER	SERIE SERIES	ART.
ALCAN	Abithal Runner	6620Z.6
ALEXIA	Alexia Slide 650 S	6620Z.29
	Alexia Slide 650 TT	6620Z.25
ALL.CO	Export 60 S	6620Z.3
	Triall.co 65-90	6620Z.9
	Triall.co 65-90 TT	6620Z.10
DFV	Classic Slide 650 S	6620Z.29
	Classic Slide 650 TT	6620Z.25
EKU Sistemi (Gruppo Profilati)	PE 60 slide	6620Z.3
	PE 70 TT	6620Z.36
EQUIPE	Sistemi 8000 S	6620Z.2
	TTSC 80	6620Z.26
ETNALL	40000	6620Z.5
	40600	6620Z.9
HYDRO	Domal 40 S	6620Z.8
INDINVEST	Alpha 650 S	6620Z.7
	Gold 650 S	6620Z.27
	Gold 650 ST	6620Z.22
METRA	NC 60 Int.	6620Z.5
OCMA	FC 70 Parigi	6620Z.6

ESTRUSORE EXTRUDER	SERIE SERIES	ART.
PASSERINI	Skeit 60	6620Z.4
	Skeit 60 super anta da 32	6620Z.11
	Skeit 60 super anta da 36	6620Z.13
	Skeit 70	6620Z.12
TP PROFILATI	Ekos 60 STH	6620Z.23

CONTINUA | CONTINUES | CONTINUE | CONTINÚA >

< SEGUE DALLA PAGINA PRECEDENTE | CONTINUED FROM PREVIOUS PAGE | SUIT DE LA PAGE PRECEDENTE | CONTINÚA DE LA PÁGINA ANTERIOR

RIF.	DESCRIZIONE DESCRIPTION	NUM.
1	Squadrette di allineamento Alignment corner joints	16
2	Carrelli Roller	4
3	Tasselli ammortizzatore antiscarrucolamento Safety shock-absorber block	4
4	Tappi coprilavorazione Cover plugs	4
5	Tasselli tenuta centrale con spazzolino Block with center seal and brush	2
6	Boccole di drenaggio Drainage bushes	3
7	Maniglie ad incasso Embedded handles	2
8	Kit di chiusura Closing kit	2
9	Squadrette telaio Frame corner joints	4 8 *
10	Squadrette anta Sash corner joints	8

* In alcuni kit ci sono 8 squadrette | In some kits there are 8 corner joint

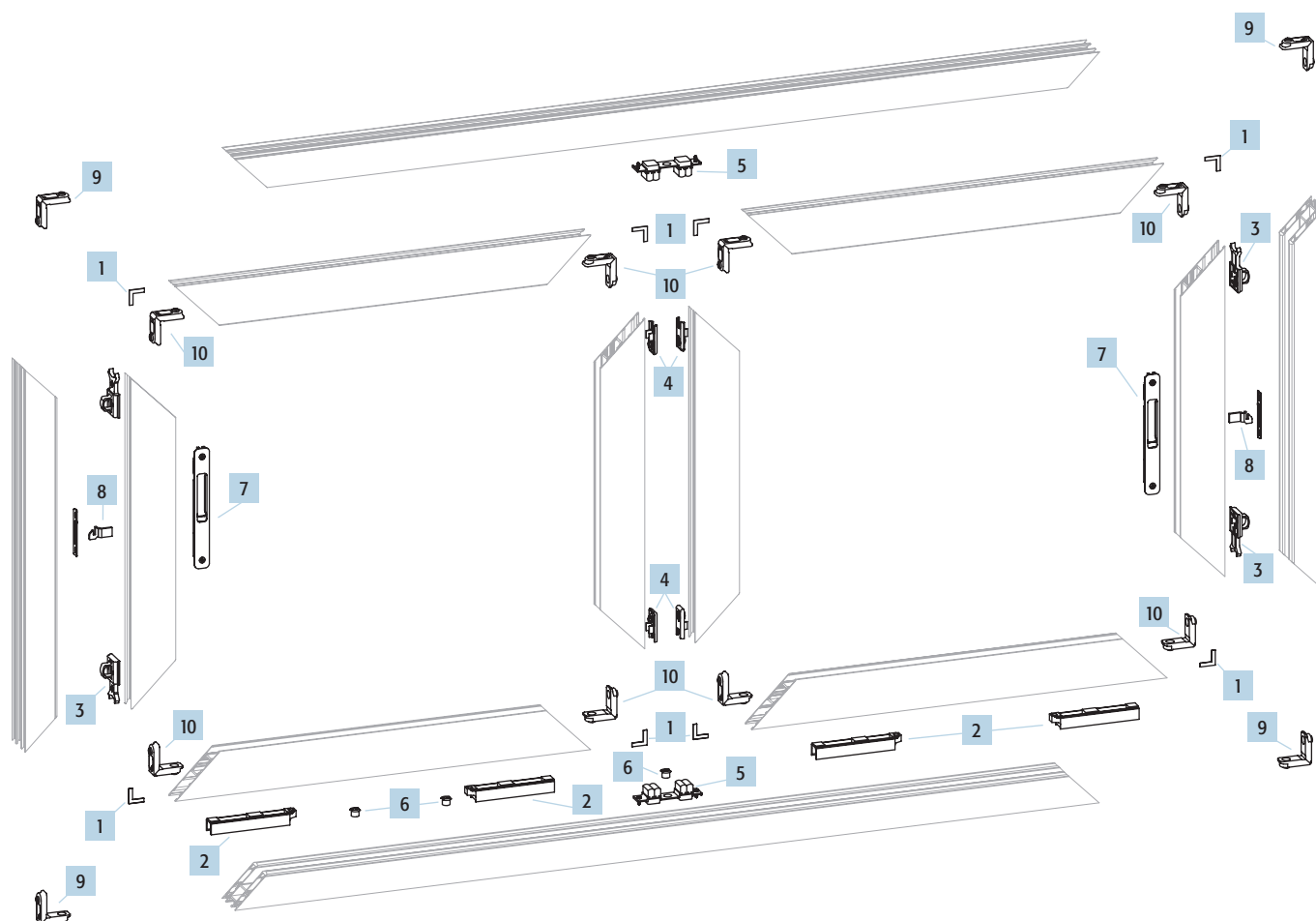

TOPKIT

LINEA EXTRAFORTE PER SERIE SCORREVOLE

KIT DI ASSEMBLAGGIO | ASSEMBLING KIT
KIT D'ASSEMBLAGE | KIT DE MONTAJE



Squadrette di allineamento in nylon o alluminio; tasselli ammortizzatore, tappi coprilavorazione in nylon; tasselli tenuta centrale in alluminio estruso; carrelli con supporto esterno in nylon, supporto interno in zama zincata e cuscinetti a rulli in acciaio temprato rivestito in nylon con fibra di vetro. Portata carrelli: 150/180 kg per anta.



Nylon or aluminium alignment corners, nylon shock-absorber elements, plugs and drainage bushes; extruded aluminium central sealing element; roller with nylon external support, galvanized zamak internal support and bearing in tempered steel covered by nylon with glass fiber. Load 150/180 kg per sash.



Equerres d'alignement en nylon ou aluminium; tasseaux amortisseur, bouchons cache-usinage en nylon; tasseaux étanchéité en aluminium extrudé; chariots avec support extérieur en nylon, support intérieur en zamak zinguée et roulements à aiguilles en acier trempé revêtus en nylon avec fibre de verre. Portée chariots: 150/180 kg chaque vantail.



Escuadras de alineación en nylon o aluminio, tacos amortiguadores, tapas y tapas de salida de agua en nylon; taco retenedor central en aluminio extruido; ruedas con exterior en nylon y interior en zamac galvanizada, y bolas en acero temperado cubrido en nylon con fibra de vidrio. Carga máxima 150/180 kg por hoja.

CONFEZIONAMENTO E FINITURE | PACKAGING AND FINISHES | CONDITIONNEMENT ET FINITIONS | EMBALAJE Y ACABADOS

ART.	6601X.9 6601X.11 6601X.20 6601X.24 6601Y.5 6601Y.10 6601Y.13 6601Y.18 6601Y.19 6601Y.22 6601Y.23 6601Y.25 6601Y.31 6601Y.34 6601Y.36 6601Y.37 6601Y.38						6601X.1 6601X.2 6601X.3 6601X.4 6601X.12 6601X.24					
	10 Kit						20 Kit					
Imballo Package Conditionnement Embalaje	1	2	3	4	5	6	1	2	3	4	5	6
Finiture disponibili Available finishes Finitions disponibles Acabados disponibles												

ESTRUSORE EXTRUDER	SERIE SERIES	ART. PORTATA 150 KG PER ANTA WEIGHT 150 KG FOR SASH	ART. PORTATA 180 KG PER ANTA WEIGHT 180 KG FOR SASH
ALCAN	Abithal Runner	----	6601X.4
ALEXIA	Alexia Slide 650 S	----	6601Y.5
	Alexia Slide 650 TT	----	6601Y.5
ALL.CO	All.co Wood S	----	6601Y.19
	Export 60 S	----	6601X.1
	Triall.co 65-90	----	6601Y.5
	Triall.co 65-90 TT	----	6601Y.5
DFV	Classic Slide 650 S	----	6601Y.5
	Classic Slide 650 TT	----	6601Y.5
EKU Sistemi (Gruppo Profilati)	PE 60 slide	----	6601X.1
	PE 70	----	6601X.20
	PE 70 TT	----	6601X.21
EQUIPE	Sistemi 8000 S	----	6601X.1
ETA	Start 900 S	----	6601Y.34
	Start 900 STT	----	6601Y.34
	Start 1000 WS	----	6601Y.38
ETNALL	TTSC 80	----	6601Y.5
	40000	----	6601X.3
	40600	----	6601Y.5

ESTRUSORE EXTRUDER	SERIE SERIES	ART. PORTATA 150 KG PER ANTA WEIGHT 150 KG FOR SASH	ART. PORTATA 180 KG PER ANTA WEIGHT 180 KG FOR SASH
GASTALDELLO	Euroline 60 SN	----	6601X.24
HYDRO	Domal 40 S	----	6601X.4
	Domal Slide 56 prof. 26255/26265	----	6601X.12
HYDRO	Domal Slide 80	6601Y.18	----
	Domal Slide PA 80	6601Y.18	----
IBLEA COLOR GROUP	Eku Vuerre 100 STT	6601Y.18	----
	Eku Vuerre 100 SWTT	6601Y.68	----
INDINVEST	Alpha 650 S	----	6601X.1
	Gold 650 S	----	6601Y.10
	Gold 650 ST	----	6601Y.22
METRA	NC 60 Int.	----	6601X.3
	NC 60 STH	----	6601Y.36
	NC 70 S	----	6601Y.37
OCMA	FC 70 Parigi	----	6601X.4
PASSERINI	Skeit 60	----	6601X.2
	Skeit 60 super anta da 32	----	6601X.11
	Skeit 60 super anta da 36	----	6601Y.13

CONTINUA | CONTINUES | CONTINUE | CONTINÚA >

< SEGUE DALLA PAGINA PRECEDENTE | CONTINUED FROM PREVIOUS PAGE | SUIT DE LA PAGE PRECEDENTE | CONTINÚA DE LA PÁGINA ANTERIOR

ESTRUSORE EXTRUDER	SERIE SERIES	ART. PORTATA 150 KG PER ANTA WEIGHT 150 KG FOR SASH	ART. PORTATA 180 KG PER ANTA WEIGHT 180 KG FOR SASH
PASSERINI	Skeit 60 super TH	----	6601Y.31
	Skeit 70	----	6601X.9
PONZIO	Sliding 600	----	6601X.24
RALOX	Ayrton 60 TT	----	6601X.14
TOMA	Atlantis 78 S	6601Y.25	----
	Atlantis 78 S TT	6601Y.25	----
TP PROFILATI	Ekos 60 STH	----	6601Y.23

RIF.	DESCRIZIONE DESCRIPTION	NUM.
1	Squadrette di allineamento Alignment corner joints	16
2	Carrelli Roller	4
3	Tasselli ammortizzatore antiscarrucolamento Safety shock-absorber block	4
4	Tappi coprilavorazione Cover plugs	4
5	Tasselli tenuta centrale con spazzolino Block with center seal and brush	2
6	Boccole di drenaggio Drainage bushes	3

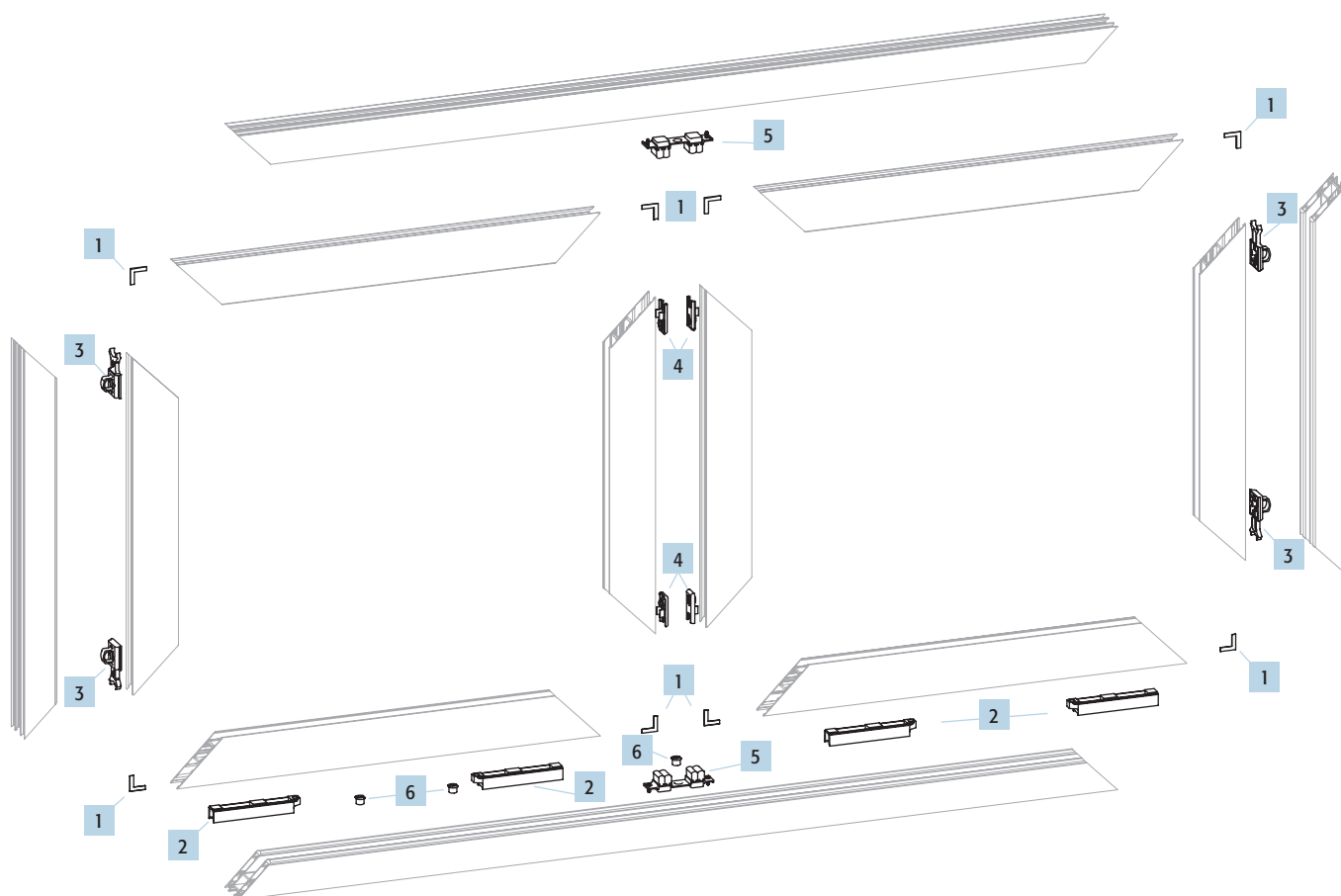

TOPKIT

LINEA EXTRA FORTE PER SERIE SCORREVOLE

KIT DI ASSEMBLAGGIO CON MANIGLIE E SQUADRETTE | ASSEMBLING KIT WITH HANDLES AND CORNERS | KIT D'ASSEMBLAGE AVEC POIGNEES ET EQUERRES | KIT DE MONTAJE CON MANILLAS Y ESCUADRAS



Squadrette di allineamento in nylon o alluminio; tasselli ammortizzatore, tappi coprilavorazione in nylon; tassello tenuta centrale in alluminio estruso; carrelli con supporto esterno in nylon, supporto interno in zama zincata e cuscinetti a rulli in acciaio temprato rivestito in nylon con fibra di vetro; squadrette in alluminio pressofuso o nylon; maniglie con cassa in alluminio estruso e leva in zama; kit di chiusura in acciaio inox AISI 441. Portata 150/180 kg per anta.



Nylon or aluminum alignment corners, nylon shock-absorber elements, plugs and drainage bushes; extruded aluminum central sealing element; roller with nylon external support, galvanized zamak internal support and roller bearing in tempered steel covered by nylon with glass fiber; die-cast aluminum or nylon corners; handles with extruded aluminum case and zamak lever; closing kit made of stainless steel AISI 441. Load 150/180 kg per sash.



Equerres d'alignement en nylon ou aluminium; tasseaux amortisseur, bouchons cache-usinage en nylon; tasseau étanchéité en aluminium extrudé; chariots avec support extérieur en nylon, support intérieur en zamak zinguée et roulements à aiguilles en acier trempé revêtus en nylon avec fibre de verre; équerres en aluminium moulé sous pression ou nylon; poignées avec caisse en aluminium extrudé et levier en zamak; kit de fermeture en acier inox AISI 441. Portée 150/180 kg chaque vantail.



Escuadras de alineación en nylon o aluminio, tacos amortiguadores, tapas y tapas de salida de agua en nylon; taco retenedor central en aluminio extruido; ruedas con exterior en nylon y interior en zamak galvanizada, y bolas en acero temperado cubrido en nylon con fibra de vidrio; escuadras en aluminio de fundición o nylon; manillas con cajas en aluminio extruido y leva en zamak; kit de cierre en acero inoxidable AISI 441. Carga máxima 150/180 kg por hoja.

CONFEZIONAMENTO E FINITURE | PACKAGE AND FINISHINGS | CONDITIONNEMENT ET FINITIONS | EMBALAJE Y ACABADOS

ART.	TUTTI ALL TOUS TODOS
Imballo Package Conditionnement Embalaje	1 Kit
Finiture disponibili Available finishes Finitions disponibles Acabados disponibles	1 2 3 4 5 6

ESTRUSORE EXTRUDER	SERIE SERIES	ART. PORTATA 150 KG PER ANTA WEIGHT 150 KG FOR SASH	ART. PORTATA 180 KG PER ANTA WEIGHT 180 KG FOR SASH
ALCAN	Abithal Runner	----	6620X.6
ALEXIA	Alexia Slide 650 S	----	6620Y.29
	Alexia Slide 650 TT	----	6620Y.25
ALL.CO	Export 60 S	----	6620X.3
	Triall.co 65-90	----	6620Y.9
	Triall.co 65-90 TT	----	6620Y.10
DFV	Classic Slide 650 S	----	6620Y.29
	Classic Slide 650 TT	----	6620Y.25
EKU Sistemi (Gruppo Profilati)	PE 60 slide	----	6620X.3
	PE 70 TT	----	6620X.36
EQUIPE	Sistemi 8000 S	----	6620X.2
	TTSC 80	----	6620Y.26
ETNALL	40000	----	6620X.5
	40600	----	6620Y.9
	Domal 40 S	----	6620X.8
HYDRO	Domal Slide 80	6620Y.31	----
	Domal Slide PA 80	6620Y.31	----

ESTRUSORE EXTRUDER	SERIE SERIES	ART. PORTATA 150 KG PER ANTA WEIGHT 150 KG FOR SASH	ART. PORTATA 180 KG PER ANTA WEIGHT 180 KG FOR SASH
INDINVEST	Alpha 650 S	----	6620X.7
	Gold 650 S	----	6620Y.27
	Gold 650 ST	----	6620Y.22
METRA	NC 60 Int.	----	6620X.5
OCMA	FC 70 Parigi	----	6620X.6
PASSERINI	Skeit 60	----	6620X.4
	Skeit 60 super anta da 36	----	6620Y.13
	Skeit 70	----	6620X.12
RALOX	Ayrton 60 TT	----	6620X.14
TP PROFILATI	Ekos 60 STH	----	6620Y.23

CONTINUA | CONTINUES | CONTINUE | CONTINÚA >

< SEGUE DALLA PAGINA PRECEDENTE | CONTINUED FROM PREVIOUS PAGE | SUIT DE LA PAGE PRECEDENTE | CONTINÚA DE LA PÁGINA ANTERIOR

RIF.	DESCRIZIONE DESCRIPTION	NUM.
1	Squadrette di allineamento Alignment corner joints	16
2	Carrelli Roller	4
3	Tasselli ammortizzatore antiscarrucolamento Safety shock-absorber block	4
4	Tappi coprilavorazione Cover plugs	4
5	Tasselli tenuta centrale con spazzolino Block with center seal and brush	2
6	Boccole di drenaggio Drainage bushes	3
7	Maniglie ad incasso Embedded handles	2
8	Kit di chiusura Closing kit	2
9	Squadrette telaio Frame corner joints	4 8 *
10	Squadrette anta Sash corner joints	8

* In alcuni kit ci sono 8 squadrette | In some kits there are 8 corner joints

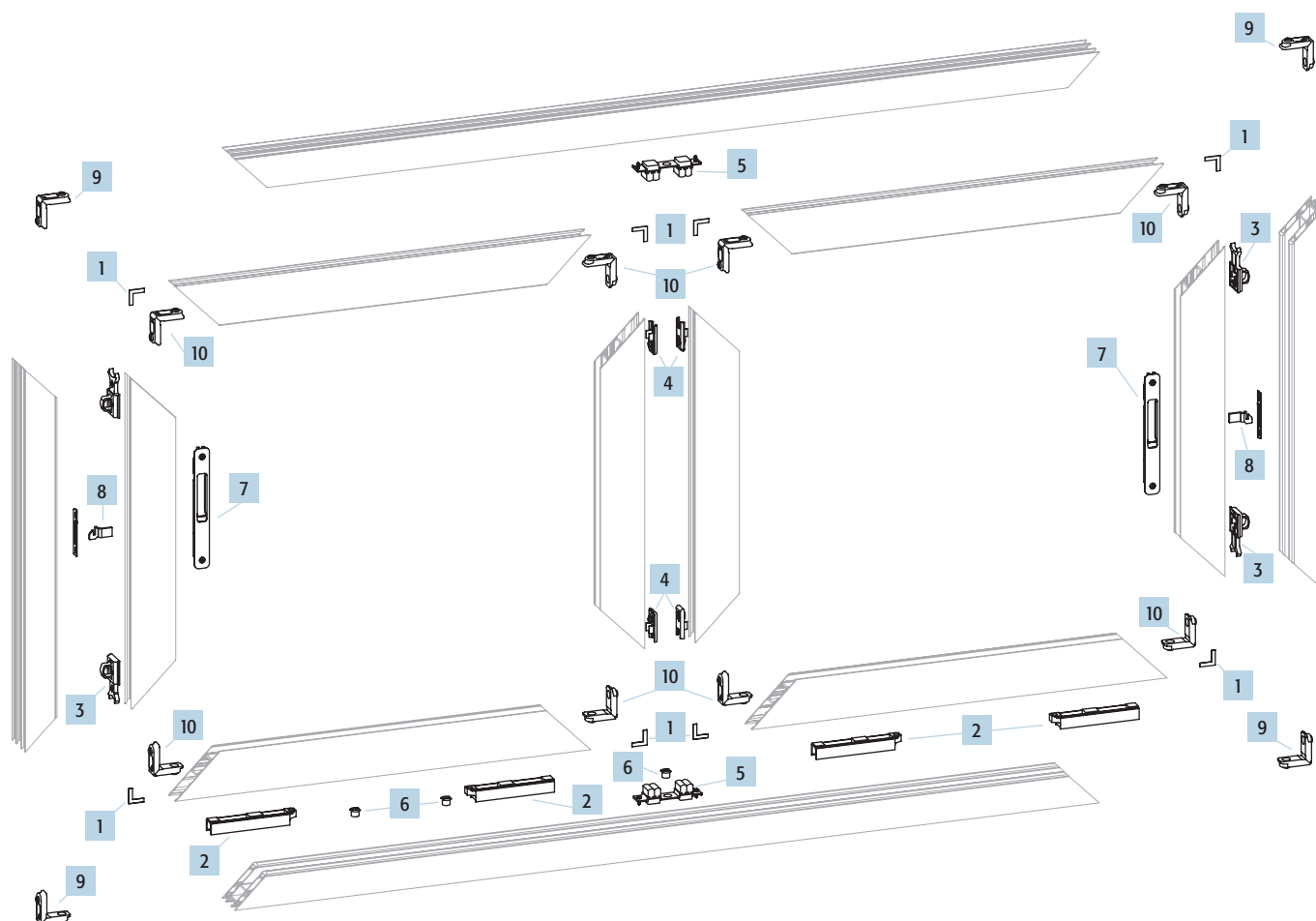

TOPKIT

LINEA FORTE PER SERIE SCORREVOLE

KIT DI ASSEMBLAGGIO CON MANIGLIE E SQUADRETTE | ASSEMBLING KIT WITH HANDLES AND CORNERS | KIT D'ASSEMBLAGE AVEC POIGNEES ET EQUERRES | KIT DE MONTAJE CON MANILLAS Y ESCUADRAS



Tasselli ammortizzatore, tappi coprilavorazione, boccole di drenaggio in nylon; squadrette, tasselli tenuta centrale in alluminio; carrelli in alluminio estruso e cuscinetti a sfera in acciaio temprato rivestito in nylon con fibra di vetro; maniglie con cassa in alluminio estruso e leva in zama; kit di chiusura in acciaio inox AISI 441. Portata 60 kg per anta (con carrelli 1 cuscinetto), 140 kg per anta (con carrelli 2 cuscinetti).



Shock-absorber elements, nylon plugs and drainage bushes; aluminium corners and sealing elements; extruded aluminium rollers and bearing in tempered steel covered by glass fiber; Handles with extruded aluminium case and zamak lever; closing kit in stainless steel AISI 441. Load 60 kg per sash (with single roller), 140 kg per sash (with double roller).



Tasseaux amortisseur, bouchons cache-usinage, clapet d'évacuation en nylon; équerres, tasseaux étanchéité en aluminium; chariots en aluminium extrudé et roulements à billes en acier trempé revêtus en nylon avec fibre de verre; poignées avec caisse en aluminium extrudé et levier en zamak; kit de fermeture en acier inox AISI 441. Portée 60 kg chaque vantail (avec chariots simples), 140 kg chaque vantail (avec chariots doubles).



Tacos amortiguadores, tapas y tapas de salida de agua en nylon; escuadras, tacos retenedores en aluminio: ruedas en aluminio extruido y bolas en acero templado cubrido con fibra de vidrio; manillas con caja en aluminio extruido y leva en zamak; kit de cierre en acero inox AISI 441. Carga máxima 60 kg por hoja (con rueda singular), 140 kg por hoja (con rueda doble).

CONFEZIONAMENTO E FINITURE | PACKAGING AND FINISHES | CONDITIONNEMENT ET FINITIONS | EMBALAJE Y ACABADOS

ART.	6602.1 6602.2	6602.3 6602.4 6602.5 6602.6
Imballo Package Conditionnement Embalaje	20 Kit	1 Kit
Finiture disponibili Available finishes Finitions disponibles Acabados disponibles	1 2 3 4 5 6	1 2 3 4 5 6

ESTRUSORE EXTRUDER	SERIE SERIES	ART. KIT DI ASSEMBLAGGIO PORTATA 140 KG PER ANTA ASSEMBLING KIT WEIGHT 140 KG FOR SASH	ART. KIT DI ASSEMBLAGGIO PORTATA 60 KG PER ANTA ASSEMBLING KIT WEIGHT 60 KG FOR SASH	ART. KIT DI ASSEMBLAGGIO CON SQUADRETTE E MANIGLIE PORTATA 140 KG PER ANTA ASSEMBLING KIT WITH CORNER JOINTS AND HANDLES WEIGHT 140 KG FOR SASH	ART. KIT DI ASSEMBLAGGIO CON SQUADRETTE E MANIGLIE PORTATA 60 KG PER ANTA ASSEMBLING KIT WITH CORNER JOINTS AND HANDLES WEIGHT 60 KG FOR SASH	ART. KIT DI ASSEMBLAGGIO CON MANIGLIE PORTATA 140 KG PER ANTA ASSEMBLING KIT WITH HANDLES WEIGHT 140 KG FOR SASH	ART. KIT DI ASSEMBLAGGIO CON SQUADRETTE PORTATA 60 KG PER ANTA ASSEMBLING KIT WITH CORNER JOINTS WEIGHT 60 KG FOR SASH
SAPA	ERRE 50 S	6602.1	6602.2	6602.3	6602.4	6602.5	6602.6

CONTINUA | CONTINUES | CONTINUE | CONTINÚA >

< SEGUE DALLA PAGINA PRECEDENTE | CONTINUED FROM PREVIOUS PAGE | SUIT DE LA PAGE PRECEDENTE | CONTINÚA DE LA PÁGINA ANTERIOR

RIF.	DESCRIZIONE DESCRIPTION	NUM.
1	Squadrette di allineamento Alignment corner joints	16
2A	Carrelli Roller	4
2B	Carrelli Roller	4
3	Tasselli ammortizzatore antiscarrucolamento Safety shock-absorber block	4
4	Tappi coprilavorazione Cover plugs	4
5	Tasselli tenuta centrale con spazzolino Block with center seal and brush	2
6	Boccole di drenaggio Drainage bushes	3
7	Maniglie ad incasso Embedded handles	2
8	Kit di chiusura Closing kit	2
9	Squadrette telaio Frame corner joints	4
10	Squadrette anta Sash corner joints	8

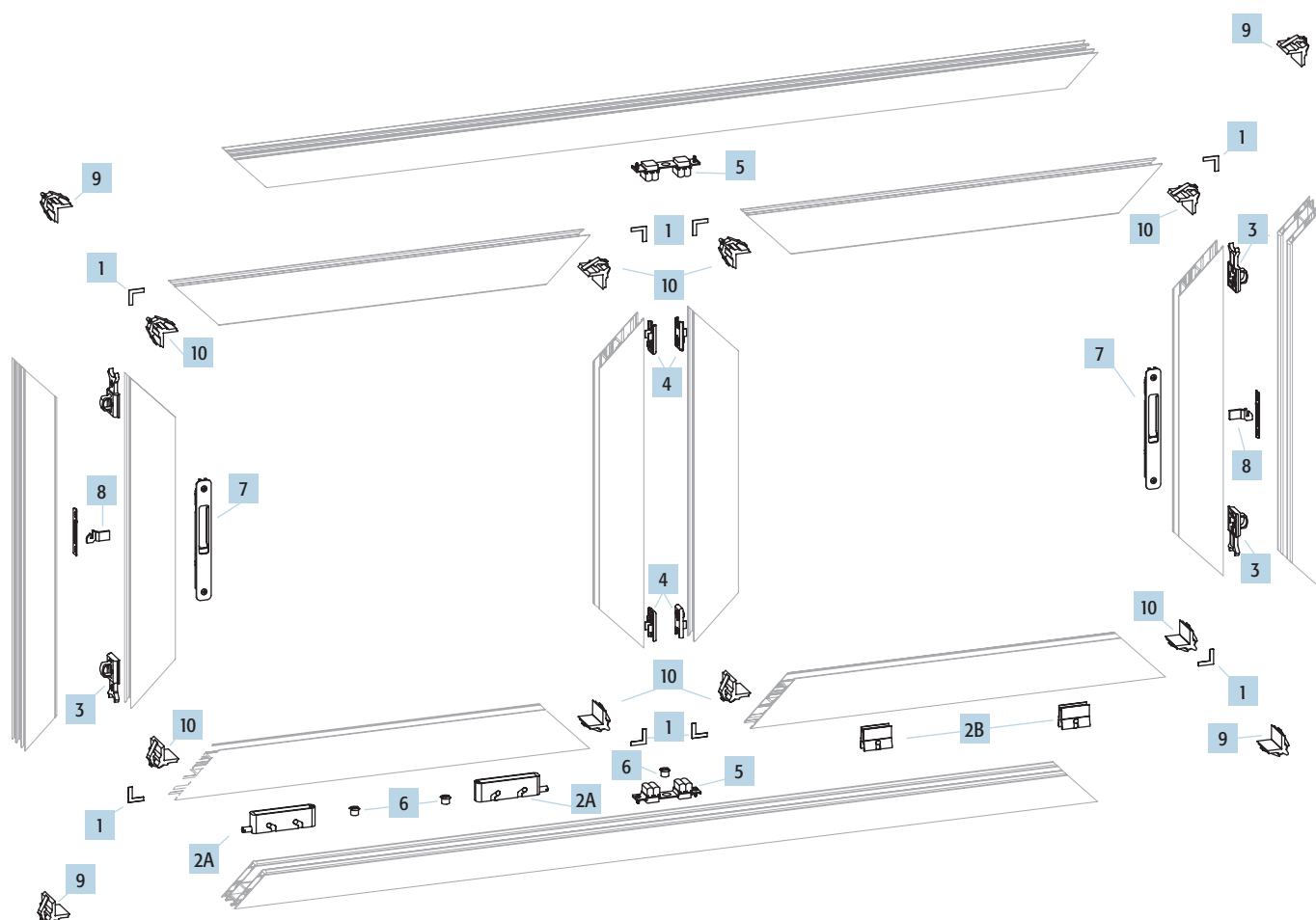

PENDOLINO TOP

CARRELLO BILANCIATO REGISTRABILE

CARRELLO BILANCIATO REGISTRABILE | BALANCED ADJUSTABLE ROLLER
CHARIOT EQUILIBRE REGLABLE | RUEDA REGULABLE



Supporto esterno in nylon, supporto interno in zama zincata; grano, dado e vite di regolazione in acciaio zincato; cuscinetti a sfera o a rulli in acciaio temprato rivestiti in nylon con fibra di vetro.



External support in nylon, internal support in galvanized zamak; setscrew, nut and adjustment screws in galvanized steel; ball or roller bearings in tempered steel covered in nylon with fiberglass.



Support extérieur en nylon, support intérieur en zamak zingué; grain, écrou et vis de réglage en acier zingué; roulements à billes ou à aiguilles en acier trempé revêtus en nylon avec fibre de verre.



Soporte externo de nylon, soporte interno de zamac galvanizado; prisionero, tuerca y tornillo de regulación de acero galvanizado; cojinetes de bolas o de rodillos de acero templado revestidos en nylon con fibra de vidrio.

CONFEZIONAMENTO E FINITURE | PACKAGING AND FINISHES CONDITIONNEMENT ET FINITIONS | EMBALAJE Y ACABADOS

ART.	TUTTI ALL TOUS TODOS					
Imballo Package Conditionnement Embalaje	60 Pz					
Finiture disponibili Available finishes Finitions disponibles Acabados disponibles	1	2	3	4	5	6

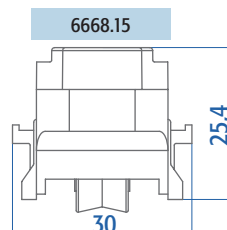
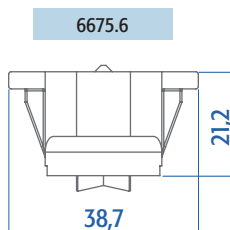
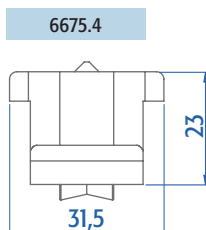
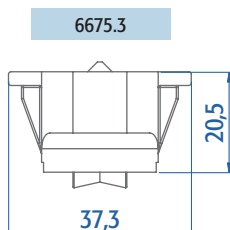
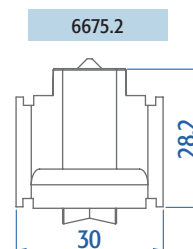
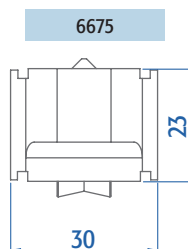
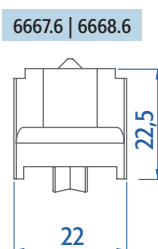
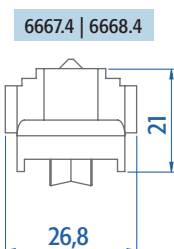
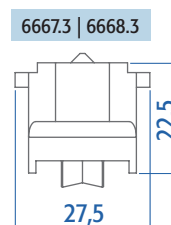
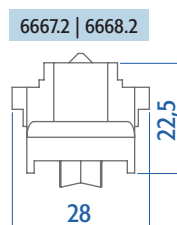
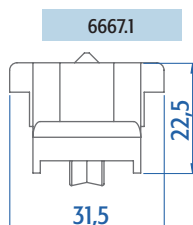
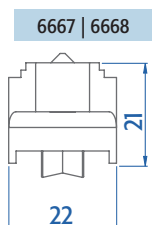
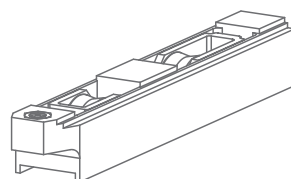
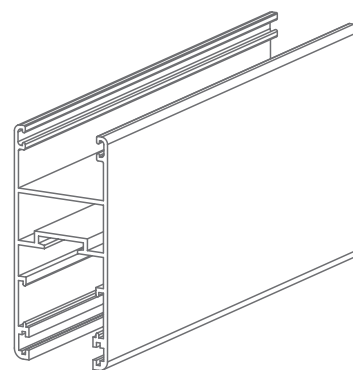

CONTINUA | CONTINUES | CONTINUE | CONTINÚA >

< SEGUE DALLA PAGINA PRECEDENTE | CONTINUED FROM PREVIOUS PAGE | SUIT DE LA PAGE PRECEDENTE | CONTINÚA DE LA PÁGINA ANTERIOR

ESTRUSORE EXTRUDER	SERIE SERIES	PORTATA 100 KG PER ANTA WEIGHT 100 KG FOR SASH	PORTATA 150 KG PER ANTA WEIGHT 150 KG FOR SASH	PORTATA 180 KG PER ANTA WEIGHT 180 KG FOR SASH
ALCAN	Abithal Runner	6667	----	6668
ALEXIA	Alexia Slide 650 S	6667.1	----	6675.4
	Alexia Slide 650 ST	6667.1	----	6675.4
ALL.CO	All.co Wood S	6667.1	----	6675.4
	Export 60	6667	----	6668
	Triall.co 65	6667.1	----	6675.4
	Triall.co 65 TT	6667.1	----	6675.4
	Triall.co 90	6667.1	----	6675.4
	Triall.co 90 TT	6667.1	----	6675.4
ALUMEC	ZN7-41 TT	----	6675.3	----
DFV	Classic Slide	6667	----	6668
	Classic Slide 650 S	6667.1	----	6675.4
	Classic Slide 650 ST	6667.1	----	6675.4
EKU Sistemi (Gruppo Profilati)	Eku Woodart Slide	6667.2	----	6668.2
	PE 60 slide	6667	----	6668
	PE 70 slide	6667.2	----	6668.2
	PE 70 slide TT	6667.2	----	6668.2
EQUIPE	Sistemi 8000 S	6667	----	6668
ETA	Eta 48 S	6667.4	----	6668.4
	Start 900 S	6667.1	----	6675.4
	Start 900 S TT	6667.1	----	6675.4
	Start 1000 WS	6667.1	----	6675.4
ETNALL	TT SC 80	6667.1	----	6675.4
	40600	6667.1	----	6675.4
HYDRO	Domal 40 S	6667	----	6668
	Domal Slide 56 (26255 26265)	6667.6	----	6668.6
	Domal Slide 80	----	6675.3	----
	Domal Slide PA 80	----	6675.3	----
IBLEA COLOR GROUP	Eku Vuerre 100 S TT	----	6675.3	----
	Eku Vuerre 100 SW TT	----	6675.3	----
INDINVEST	Alpha 560 S	6667	----	6668
	Gold 650 S	6667.1	----	6675.4
	Gold 650 ST	6667.1	----	6675.4
METRA	NC 60 int.	6667	----	6668
	NC 60 STH	----	----	6675.1
	NC 70 S	----	----	6675.2
NOVAL	Noval Slide wood 900	6667.3	----	6668.3
OCMA	Parigi	6667	----	6668
PASSERINI	Skeit 60	6667	----	6668
	Skeit 70	6667	----	6668
	Skeit 60 super anta da 32 mm	6667	----	6668
	Skeit 60 super anta da 36 mm	6667.1	----	6675.4
	Skeit 60 super TH	6667.1	----	6675.4
PONZIO	Sliding 600	6667.4	----	6668.4
RALOX	Ayrton 60	6667	----	6668
	Ayrton 60 TT	----	----	6668.15
TOMA	Atlantis 78 S	----	6675.6	----
	Atlantis 78 STT	----	6675.6	----
TP PROFILATI	Ekos 60 STH	6667.1	----	6675.4

CARRELLO DOPPIO BILANCIATO REGISTRABILE

CARRELLO DOPPIO BILANCIATO REGISTRABILE | BALANCED ADJUSTABLE DOUBLE ROLLER
CHARIOT DOUBLE ÉQUILIBRE REGLABLE | RUEDA REGULABLE DOBLE



Supporto esterno in nylon; supporto interno, grano, dado, vite e asse di bilanciamento in acciaio zincato; cuscinetti a sfera in acciaio temprato rivestito in nylon con fibra di vetro.



External support in nylon; internal support, setscrew, nut, screw and balancing axle in galvanized steel; ball bearings in tempered steel covered in nylon with fiberglass.



Support extérieur en nylon; support intérieur, grain, écrou, vis et axe de balancement en acier zingué; roulements à billes en acier trempé revêtu en nylon avec fibre de verre.



Soporte externo de nylon, soporte interno, prisionero, tuerca, tornillos y eje de balance de acero galvanizado; cojinetes de bolas de acero templado revestido en nylon con fibra de vidrio.

CONFEZIONAMENTO E FINITURE | PACKAGING AND FINISHES | CONDITIONNEMENT ET FINITIONS | EMBALAJE Y ACABADOS

ART.	6656.3 6656.4					
Imballo Package Conditionnement Embalaje	60 Pz					
Finiture disponibili Available finishes Finitions disponibles Acabados disponibles	1	2	3	4	5	6

ESTRUSORE EXTRUDER	SERIE SERIES	PORTATA 90 KG PER ANTA WEIGHT 90 KG FOR SASH
ALCAN	Abithal Runner	6656.4
ALL.CO	Export 60	6656.3
EKU Sistemi (Gruppo Profilati)	PE 60 slide	6656.3
EQUIPE	Sistemi 8000 S	6656.3
ETNALL	40000	6656.4
HYDRO	Domal 40 S	6656.4
INDINVEST	Alpha 560 S	6656.3
METRA	NC 60 int.	6656.4
OCMA	Parigi	6656.4
PASSERINI	Skeit 60	6656.3
RALOX	Ayrton 60	6656.4

6656.3

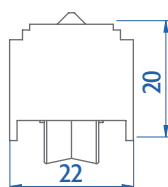

6656.4

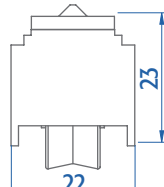

Con cuscinetti
schermati e sostituibili
With shielded and
replaceable bearings

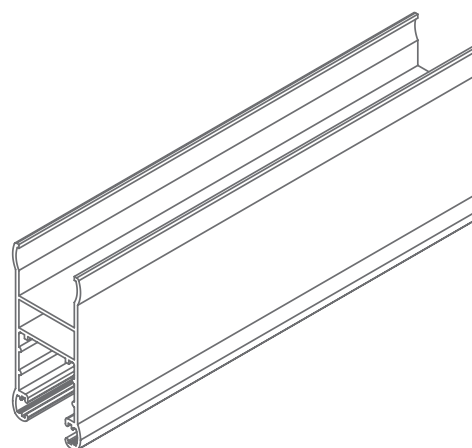
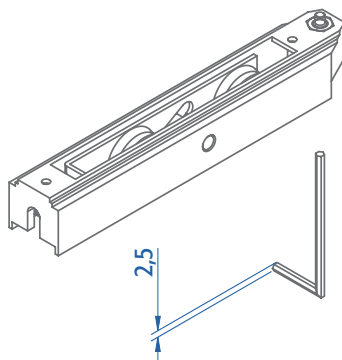

CARRELLI IN NYLON 1 CUSCINETTO

CARRELLI IN NYLON 1 CUSCINETTO | 1-BEARING NYLON ROLLERS
CHARIOTS EN NYLON 1 ROULEMENT | RUEDAS DE NYLON CON 1 COJINETE



Dado, grano e vite di regolazione in acciaio zincato; corpo carrello in nylon; cuscinetti a sfera.



Nut, setscrew and adjustment screws in galvanized steel; roller body in nylon; ball bearings.



Écrou, grain et vis de réglage en acier zingué; corps chariot en nylon; roulements à billes.



Tuerca, prisionero y tornillo de regulación de acero galvanizado; cuerpo rueda de nylon; cojinete de bolas.

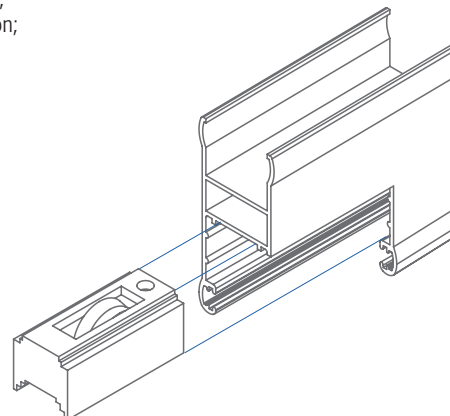

CONFEZIONAMENTO E FINITURE | PACKAGING AND FINISHES CONDITIONNEMENT ET FINITIONS | EMBALAJE Y ACABADOS

ART.	6671.1 6671.2						6670.10 6670.11 6670.12					
Imballo Package Conditionnement Embalaje	60 Pz						100 Pz					
Finiture disponibili Available finishes Finitions disponibles Acabados disponibles	1	2	3	4	5	6	1	2	3	4	5	6

CARRELLO FISSO. TRE POSIZIONI FIXED ROLLER. THREE POSITIONS. PORTATA 50 KG PER ANTA WEIGHT 50 KG FOR SASH		
ESTRUSORE EXTRUDER	SERIE SERIES	ART.
ALCAN	Abithal Runner	6670.11
ALL.CO	Export 60	6670.10
DFV	Classic slide	6670.10
EKU Sistemi (Gruppo Profilati)	PE 60 S	6670.10
EQUIPE	Sistemi 8000 S	6670.10
ETNALL	40000	6670.11
HYDRO	Domal 40 S	6670.11
INDINVEST	Alpha 560 S	6670.10
METRA	NC 60 int.	6670.11
OCMA	Parigi	6670.11
PASSERINI	Skeit 60	6670.10
RALOX	Ayrton 60	6670.10

CARRELLO BILANCIATO REGISTRABILE ADJUSTABLE BALANCED ROLLER PORTATA 40 KG PER ANTA WEIGHT 40 KG FOR SASH		
ESTRUSORE EXTRUDER	SERIE SERIES	ART.
ALCAN	Abithal Runner	6671.2
ALL.CO	Export 60	6671.1
DFV	Classic slide	6671.1
EKU Sistemi (Gruppo Profilati)	PE 60S	6671.1
EQUIPE	Sistemi 8000 S	6671.1
ETNALL	40000	6671.2
HYDRO	Domal 40 S	6671.2
INDINVEST	Alpha 560 S	6671.1
METRA	NC 60 int.	6671.2
OCMA	Parigi	6671.1
PASSERINI	Skeit 60	6671.1
RALOX	Ayrton 60	6671.1

6670.10	6670.11	6670.12
6671.1	6671.2	Con cuscinetti schermati e sostituibili With shielded and replaceable bearings

CARRELLO BILANCIATO REGISTRABILE ADJUSTABLE BALANCED ROLLER PORTATA 110 KG PER ANTA WEIGHT 110 KG FOR SASH		
ESTRUSORE EXTRUDER	SERIE SERIES	ART.
ALL.CO	Triall.co 65/90	6670.12
	Triall.co 65/90 TT	6670.12
	All.co Wood S	6670.12
ALEXIA	Alexia Slide 650 S	6670.12
	Alexia Slide 650 ST	6670.12
DFV	Classic Slide 650 S	6670.12
	Classic Slide 650 ST	6670.12
ETA	Start 900 S	6670.12
	Start 900 TT	6670.12
	Start 1000 WS	6670.12
ETNALL	40600	6670.12
TP PROFILATI	Ekos 60 THS	6670.12

DAKARDUO

CARRELLO DOPPIO REGISTRABILE

CARRELLO DOPPIO REGISTRABILE | ADJUSTABLE DOUBLE ROLLER
CHARIOT DOUBLE REGLABLE | RUEDA REGULABLE DOBLE



Supporto interno e supporto esterno in alluminio estruso; cuscinetti in acciaio temprato rivestito in nylon con fibra di vetro; vite di regolazione in acciaio inox.
Portata: 140 kg per anta.



Internal and external supports in extruded aluminum; bearings in tempered steel covered in nylon with fiberglass; adjustment screws in stainless steel.
Load capacity: 140 kg per sash.



Support intérieur et support extérieur en aluminium extrudé; roulements en acier trempé revêtu en nylon avec fibre de verre; vis de réglage en acier inox.
Portée: 140 kg chaque vantail.



Soporte interno y soporte externo de aluminio extruido; cojinetes de acero templado revestido en nylon con fibra de vidrio; tornillo de regulación de acero inox.
Soporta: 140 kg por hoja.



CONFEZIONAMENTO E FINITURE | PACKAGING AND FINISHES | CONDITIONNEMENT ET FINITIONS | EMBALAJE Y ACABADOS

ART.	6652					
Imballo Package Conditionnement Embalaje	60 Pz					
Finiture disponibili Available finishes Finitions disponibles Acabados disponibles	1	2	3	4	5	6

PORTATA 140 KG PER ANTA WEIGHT 140 KG FOR SASH		
ESTRUSORE EXTRUDER	SERIE SERIES	ART.
SAPA	Erre 50 S	6652

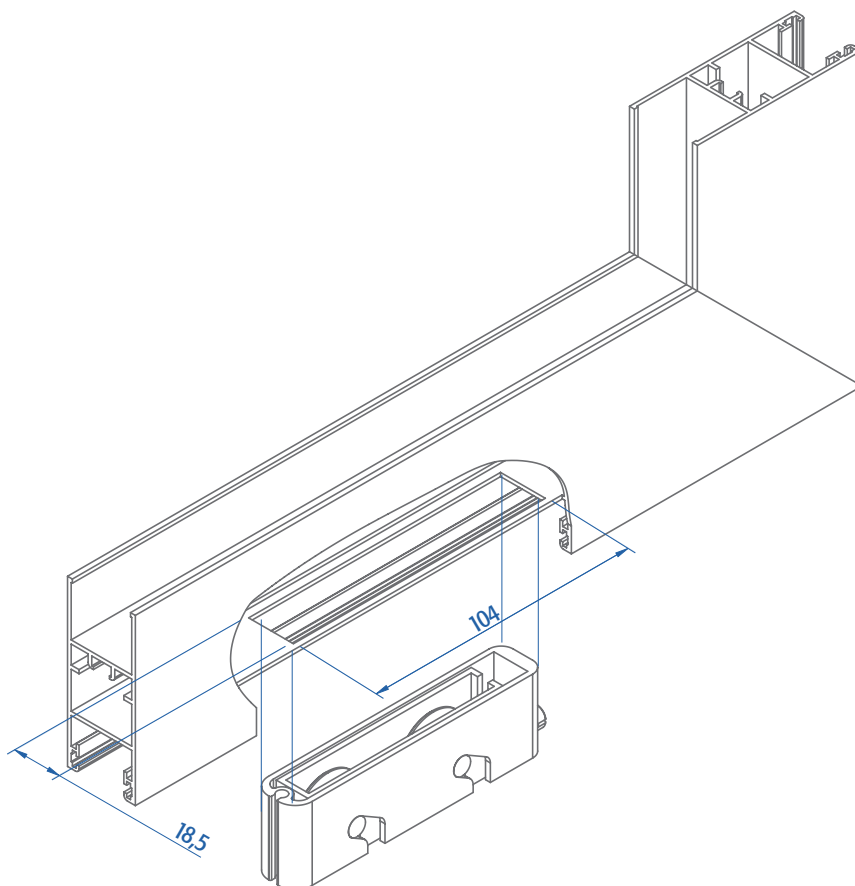
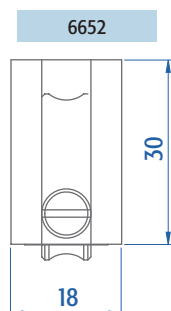

DAKAR

CARRELLO FISSO A UN CUSCINETTO

CARRELLO FISSO A UN CUSCINETTO | ONE-BEARING FIXED ROLLER
CHARIOT FIXE A UN ROULEMENT | CARRO FIJO CON UN COJINETE



Supporto cuscinetto in alluminio estruso; cuscinetto in acciaio temprato rivestito in nylon con fibra di vetro. Portata: 60 kg per anta.



Bearing support in extruded aluminum; bearing in tempered steel covered in nylon with fiberglass. Load capacity: 60 kg per sash.



Support roulement en aluminium extrudé; roulement en acier trempé revêtu en nylon avec fibre de verre. Portée: 60 kg chaque vantail.



Soporte cojinete de aluminio extruido; cojinete de acero templado revestido en nylon con fibra de vidrio. Soporta: 60 kg por hoja.



CONFEZIONAMENTO E FINITURE | PACKAGING AND FINISHES | CONDITIONNEMENT ET FINITIONS | EMBALAJE Y ACABADOS

ART.	6661					
Imballo Package Conditionnement Embalaje	100 Pz					
Finiture disponibili Available finishes Finitions disponibles Acabados disponibles	1	2	3	4	5	6

PORTATA 60 KG PER ANTA WEIGHT 60 KG FOR SASH		
ESTRUSORE EXTRUDER	SERIE SERIES	ART.
SAPA	Erre 50 S	6661

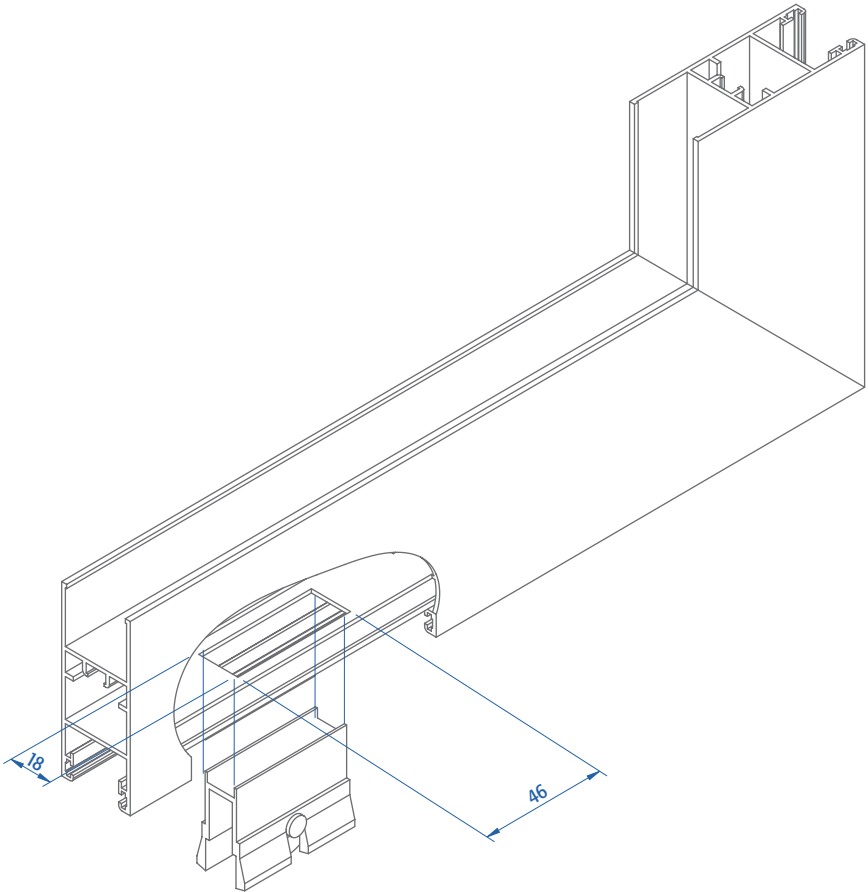
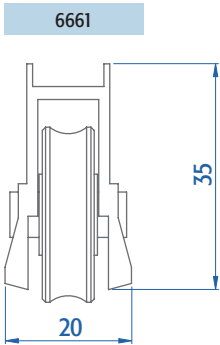

TAPPO COPRILAVORAZIONE

TAPPO COPRILAVORAZIONE | COVER PLUG
CACHE USINAGE | TAPÓN PARA CUBRIR LA MECANIZACIÓN



Realizzato in nylon.



Made of nylon.



Réalisé en nylon.



Fabricado en nylon.



CONFEZIONAMENTO E FINITURE | PACKAGING AND FINISHES | CONDITIONNEMENT ET FINITIONS | EMBALAJE Y ACABADOS

ART.	TUTTI ALL TOUS TODOS
Imballo Package Conditionnement Embalaje	100 Pz
Finiture disponibili Available finishes Finitions disponibles Acabados disponibles	1 2 3 4 5 6

ESTRUSORE EXTRUDER	SERIE SERIES	ART.	A	B	C	D
ALCAN	Abithal Runner	6822	16	22	4	4
ALL.CO	Export 60	6822	16	22	4	4
EKU Sistemi (Gruppo Profilati)	PE 60 Slide	6822	16	22	4	4
	PE 70 Slide	6829	20	24	17,4	5
	PE 70 Slide TT	6829	20	24	17,4	5
EQUIPE	Sistemi 8000	6822	16	22	4	4
	Sistemi 8000 S	6822	16	22	4	4
ETNALL	40000	6823	13	22	13	5
HYDRO	Domal 40 S	6822	16	22	4	4
	Domal Slide 56	6829	20	21	13,25	5X5
	Domal Slide 80	6829.1	----	----	----	----
	Domal Slide PA 80	6829.1	----	----	----	----
IBLEA COLOR GROUP	Eku Vuerre 100 S TT	6829.1	----	----	----	----
	Eku Vuerre 100 SW TT	6829.1	----	----	----	----
INDINVEST	Alpha 560 S	6822	16	22	4	4
METRA	NC 60 int.	6823	13	22	13	5
	NC 60 sth	6860.1	16/18	25	19,5	5
	NC 70	6860.2	18	26,5	7	5
	NC 90 S	6860.2	18	26,5	7	5
PASSERINI	Skeit 60 super anta da 32	6827	26	----	----	----
	Skeit 60 super anta da 36	6827	26	----	----	----
	Skeit 60 super TH	6827	26	----	----	----
	Skeit 70	6827	25	----	----	----
SAPA	Erre 50 S	6821	18,5	18,5	6,5	7

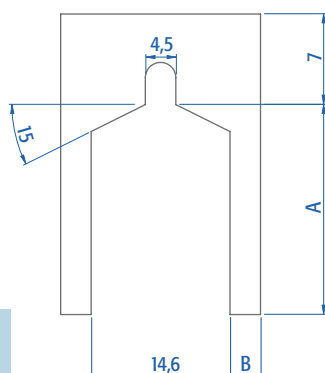
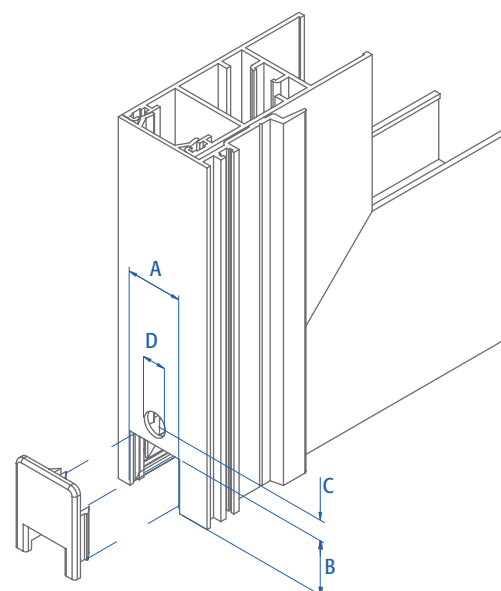

Solo per art. 6827
Only for art. 6827

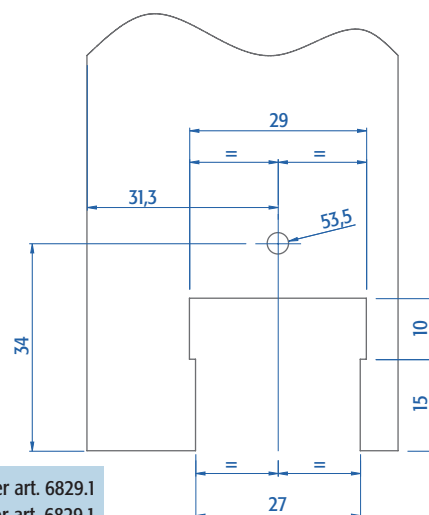

Solo per art. 6829.1
Only for art. 6829.1

TAPPO COPRILAVORAZIONE

TAPPO COPRILAVORAZIONE | COVER PLUG
CACHE USINAGE | TAPÓN PARA CUBRIR LA MECANIZACIÓN



Tassello e noddolino di
chiusura in nylon.



Block and closing latch
in nylon.



Tasseau et gâchette de
fermeture en nylon.



Taco y casquillo de cierre
de nylon.



CONFEZIONAMENTO E FINITURE | PACKAGING AND FINISHES | CONDITIONNEMENT ET FINITIONS | EMBALAJE Y ACABADOS

ART.	TUTTI ALL TOUS TODOS
Imballo Package Conditionnement Embalaje	100 Pz
Finiture disponibili Available finishes Finitions disponibles Acabados disponibles	1 2 3 4 5 6

ESTRUSORE EXTRUDER	SERIE SERIES	ART.	A
ALEXIA	Alexia Slide 650 S	6824	21
	Alexia Slide 650 ST	6824	21
ALL.CO	Triall.co 65	6824	21
	Triall.co 65 TT	6824	21
	Triall.co 90	6824	21
	Triall.co 90 TT	6824	21
DFV	Classic Slide 650 S	6824	21
	Classic Slide 650 ST	6824	21
ETNALL	TT SC 80	6824	21
	40600	6824	21
INDINVEST	Gold 650 S	6830	----
	Gold 650 ST	6830	----
PONZIO	Sliding 600	6824.3	----
RALOX	Ayrton 60	6825	15
	Ayrton 60 TT	6825A	21
SAPA	Win 65 STT	6830	----
TP PROFILATI	Ekos 60 STH	6824	21

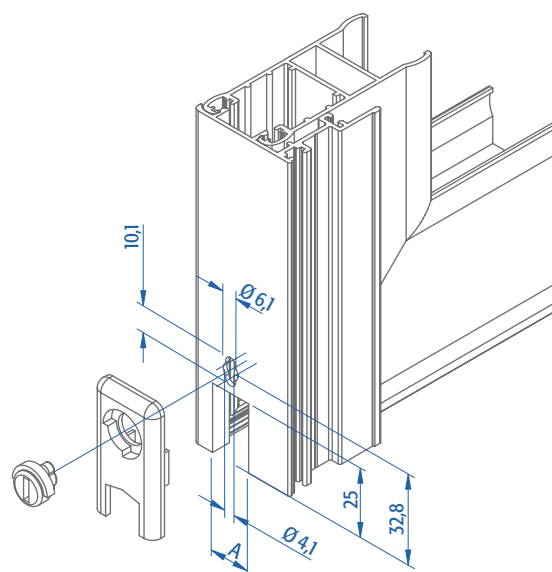

Solo per art. 6830
Only for art. 6830

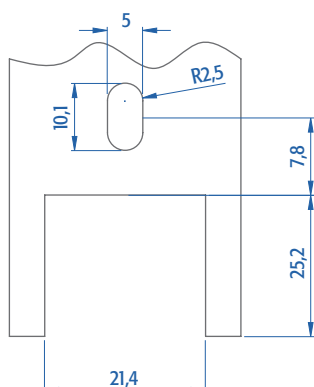

Solo per art. 6824.3
Only for art. 6824.3

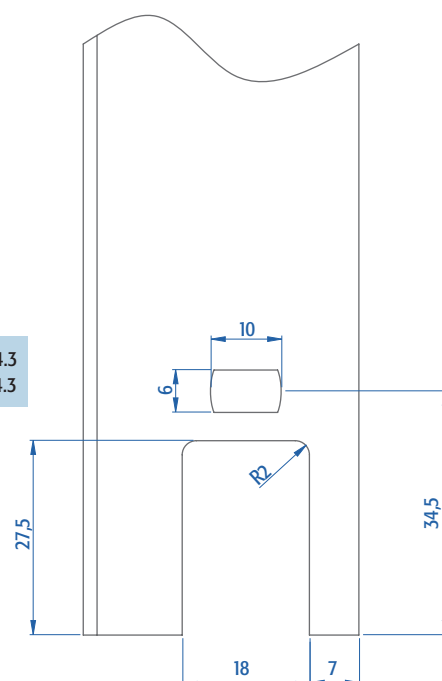

TASSELLO AMMORTIZZATORE ANTISCARRUCOLAMENTO

TASSELLO AMMORTIZZATORE ANTISCARRUCOLAMENTO | SAFETY SHOCK-ABSORBING BLOCK
TASSEAU AMORTISSEUR ANTI-DERAILLEMENT | TACO AMORTIGUADOR ANTIDESCARRILAMIENTO



Tassello in nylon; tappo ammortizzatore in gomma; dado in acciaio zincato; grano in acciaio.



Block in nylon; rubber shock-absorbing plug; nut in galvanized steel; setscrew in steel.



Tasseau en nylon; bouchon amortisseur en caoutchouc; écrou en acier zingué; grain en acier.



Taco de nylon; tapón amortiguador de goma; tuerca de acero galvanizado; prisionero de acero galvanizado.



CONFEZIONAMENTO E FINITURE | PACKAGING AND FINISHES | CONDITIONNEMENT ET FINITIONS | EMBALAJE Y ACABADOS

ART.	TUTTI ALL TOUS TODOS
Imballo Package Conditionnement Embalaje	50 Pz
Finiture disponibili Available finishes Finitions disponibles Acabados disponibles	1 2 3 4 5 6

ESTRUSORE EXTRUDER	SERIE SERIES	ART.
ALCAN	Abithal Runner	6813.1
ALEXIA	Alexia Slide 650 S	6814
	Alexia Slide 650 ST	6814
ALL.CO	All.co Wood S	6814
	Export 60	6812.1
	Triall.co 65	6814
	Triall.co 90	6814
	Triall.co 65 TT	6814
	Triall.co 90 TT	6814
EKU Sistemi (Gruppo Profilati)	PE 60 Slide	6812.1
	PE 70 Slide	6851.2
	PE 70 Slide TT	6851.1
EQUIPE	Sistemi 8000 S	6812.1
ETNALL	TT SC 80	6814
	40000	6813.1
	40600	6814
HYDRO	Domal 40 S	6813.1
	Domal Slide 56 (26255 26265)	6816
	Domal Slide 80	6816.3
	Domal Slide PA 80	6816.3
IBLEA COLOR GROUP	Eku Vuerre 100 S TT	6816.3
	Eku Vuerre 100 SW TT	6816.3
INDINVEST	Alpha 560 S	6812.1
	Gold 650 S	6814
	Gold 650 ST	6850.2
METRA	NC 60 int.	6813.1
	NC 60 STH	6852.1
	NC 70 S	6852.3
PASSERINI	Skeit 60	6812.1
	Skeit 60 super anta 32	6853
	Skeit 60 super anta 36	6853
	Skeit 60 super TH	6853
	Skeit 70	6812.1
PONZIO	Sliding 600	6812.2

ESTRUSORE EXTRUDER	SERIE SERIES	ART.
RALOX	Ayrton 60	6815
	Ayrton 60 TT	6815B
SAPA	Erre 50 S	6811
	Win 65 STT	6851.1
TP PROFILATI	Ekos 60 STH	6850.2
VARIE VARIOUS	Penta 60 T.90°	6819

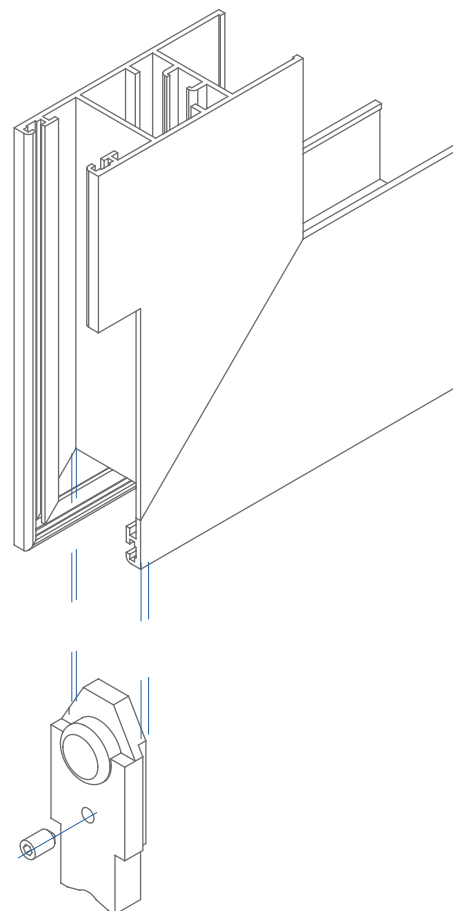

TASSELLO DI TENUTA CENTRALE CON SPAZZOLINO

TASSELLO DI TENUTA CENTRALE CON SPAZZOLINO | BLOCK WITH CENTER SEAL AND BRUSH
PATIN ETANCHEITE CENTRALE AVEC JOINT BROSSE | TACO RETENEDOR CENTRAL CON CEPILLO



Tassello in alluminio estruso; spugnette autoadesive; viti autofilettanti in acciaio inox.



Block in extruded aluminum; self-adhesive sponges; self-threading screws in stainless steel.



Tasseau en aluminium extrudé; mouilleuses auto collantes; vis autotaraudeuses en acier inox.



Taco de aluminio extruido; esponjas autoadhesivas; tornillos autorroscantes de acero inox.

CONFEZIONAMENTO E FINITURE | PACKAGING AND FINISHES | CONDITIONNEMENT ET FINITIONS | EMBALAJE Y ACABADOS

ART.	TUTTI ALL TOUS TODOS
Imballo Package Conditionnement Embalaje	50 Pz
Finiture disponibili Available finishes Finitions disponibles Acabados disponibles	1 2 3 4 5 6

ESTRUSORE EXTRUDER	SERIE SERIES	A	ART.
AL SISTEM	Global 60	23	6832
ALCAN	Abithal Runner	23	6832
ALEXIA	Alexia Slide 650 S	30	6833
	Alexia Slide 650 ST	30	6833
ALL.CO	All.co Wood S	46	6835.2
	Export 60	23	6832
	Triall.co 65	30	6833
	Triall.co 65 TT	30	6833
	Triall.co 90	30	6833
	Triall.co 90 TT	30	6833
EKU Sistemi (Gruppo Profilati)	PE 60 slide	23	6832
	PE 70 Slide	25	6835.16
	PE 70 Slide TT	25	6835.16
EQUIPE	Sistemi 8000 S	23	6832
ETNALL	TT SC 80	30	6833
	40000	23	6832
	40600	30	6833
HYDRO	Domal 40 S	23	6832
	Domal Slide 80	32,5	6836.1
	Domal Slide PA 80	32,5	6836.1
IBLEA COLOR GROUP	Eku Vuerre 100 SW TT	56,3	6836.3
INDINVEST	Alpha 560 S	23	6832
	Gold 650 S	30	6833
	Gold 650 S.T.	30	6833
METRA	NC 60 int.	23	6832
	NC 60 STH	28	6835.9
OCMA	Parigi	23	6832
PASSERINI	Skeit 60	23	6832
	Skeit 60 Super	36	6835.4
RALOX	Ayrton 60	31.5	6834
	Ayrton 60 TT	31.5	6834
SAPA	Erre 50 S	23	6832
TOMA	Atlantis 78 S	31.5	6836.3
	Atlantis 78 S TT	31.5	6836.3

VARIE | VARIOUS

ESTRUSORE EXTRUDER	SERIE SERIES	A	ART.
	Archimede	40	6835.3
	Double B	52	6835
	Dual	50	6835.1
	Penta 60 (taglio a 45°)	25	6835.6
	Penta 60 (taglio a 90°)	26	6835.7
	Sede di alloggiamento tassello tenuta centrale da 45 mm	44	6835.5
	Sede di alloggiamento tassello tenuta centrale da 47 mm	46	6835.2

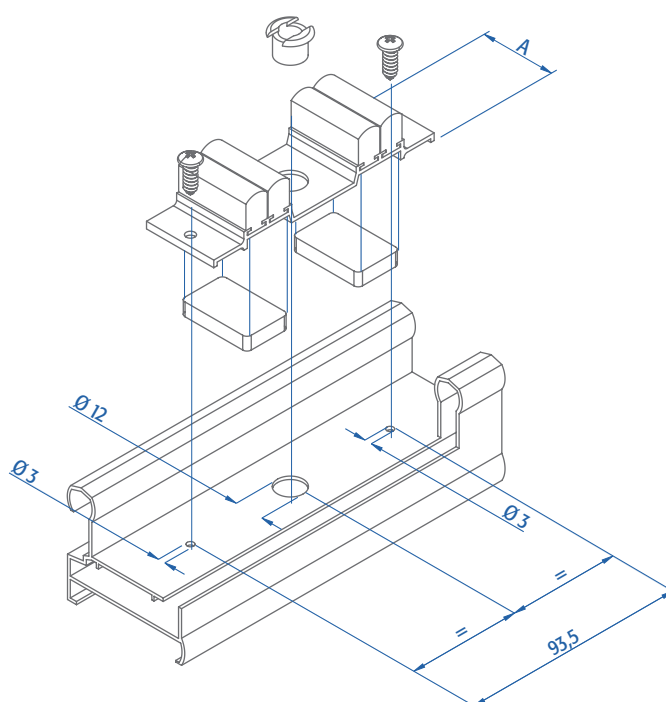

STRINGHE DI PRODOTTO

Pag 308 | Pendolino Top - Carrello bilanciato registrabile

Norma di Riferimento		UNI EN 13126-1; UNI EN 13126-15							
Art:	Categoria d'uso	Durabilità	Massa	Resistenza Fuoco	Sicurezza di utilizzo	Resistenza Corrosione	Sicurezza	Applicazione	Dimensione Campione
6667.X	-	5	50	0	1	5	-	15/1	-
6668.X	-	5	90	0	1	5	-	15/1	-
6675.X	-	5	90	0	1	5	-	15/1	-

Pag 310 | Carrello doppio bilanciato registrabile

Norma di Riferimento		UNI EN 13126-1; UNI EN 13126-15							
Art:	Categoria d'uso	Durabilità	Massa	Resistenza Fuoco	Sicurezza di utilizzo	Resistenza Corrosione	Sicurezza	Applicazione	Dimensione di prova
6653.X	-	5	40	0	1	5	-	15/1	-
6656.X	-	5	45	0	1	5	-	15/1	-

Pag 311 | Carrello in nylon un cuscinetto

Norma di Riferimento		UNI EN 13126-1; UNI EN 13126-15							
Art:	Categoria d'uso	Durabilità	Massa	Resistenza Fuoco	Sicurezza di utilizzo	Resistenza Corrosione	Sicurezza	Applicazione	Dimensione di prova
6670.X	-	5	25	0	1	5	-	15/1	-
6671.X	-	5	20	0	1	5	-	15/1	-

Pag 312 | Dakarduo - Carrello doppio registrabile

Norma di Riferimento		UNI EN 13126-1; UNI EN 13126-15							
Art:	Categoria d'uso	Durabilità	Massa	Resistenza Fuoco	Sicurezza di utilizzo	Resistenza Corrosione	Sicurezza	Applicazione	Dimensione di prova
6652	-	3	70	0	1	5	-	15/1	-

Pag 313 | Dakar - Carrello fisso ad un cuscinetto

Norma di Riferimento		UNI EN 13126-1; UNI EN 13126-15							
Art:	Categoria d'uso	Durabilità	Massa	Resistenza Fuoco	Sicurezza di utilizzo	Resistenza Corrosione	Sicurezza	Applicazione	Dimensione di prova
6661	-	3	30	0	1	5	-	15/1	-

Legenda	---	3: 10000 cicli	Massa kg	0: non richiesto	1	1: 24 h	---	15/1 scorrevole orizzontale	---
	---	4: 15000 cicli	---	---	---	2: 48 h	---	15/2 libro pivot centrale	---
	---	5: 25000 cicli	---	---	---	3: 96 h	---	15/3 libro Apertura interna/esterna	---
	---	---	---	---	---	4: 240 h	---		---
	---	---	---	---	---	5: 480 h	---		---
	---	---	---	---	---	ore in nebbia salina	---		---