

**Art./Item: 70**

**In ottone**  
**Perni e controperni**  
**in acciaio inox**  
**Chiavi Art.91**

In brass  
 Pins and drivers  
 in stainless steel  
 Keys Item 91



n.3  
 cod. 91.01.75 

CODE  
CODELUNGHEZZA CICLI  
LENGTH OF KEYSNUMERO PERCHI  
NUMBER OF PINS

E

**70.00.75**

75

6

12

**70.00.90**

90

6

12

**70.00.10**

105

6

12

n.2  
 cod. 91.01.75 

**70.08.75**

75

6

12

n.1 KA  
 cod. 91.01.75 

**70.10.75**

75

6

12

**70.10.90**

90

6

12

**70.10.10**

105

6

12

**Art./Item: 70 P**

**In ottone**  
**Perni e controperni**  
**in acciaio inox**  
**Chiavi Art.91**

In brass  
 Pins and drivers  
 in stainless steel  
 Keys Item 91



n.3  
 cod. 91.01.75 

**70.01.75**

75

6

12

**70.01.90**

90

6

12

n.2  
 cod. 91.01.75 

**70.19.75**

75

6

12

n.1 KA  
 cod. 91.01.75 

**70.11.75**

75

6

12

**70.11.90**

90

6

12

**Art./Item: 70 U**

**In ottone**  
**Perni e controperni**  
**in acciaio inox**  
**Chiavi Art.91**

In brass  
 Pins and drivers  
 in stainless steel  
 Keys Item 91



n.3  
 cod. 91.01.75 

**70.38.75**

75

6

12

**70.38.90**

90

6

12

**70.38.10**

105

6

12

n.2  
 cod. 91.01.75 

**70.04.75**

75

6

12

n.1 KA  
 cod. 91.01.75 

**70.39.75**

75

6

12

**70.39.90**

90

6

12

**Art./Item: 71**

**In ottone**  
**Perni e controperni**  
**in acciaio inox**  
**Chiavi Art.91**

In brass  
 Pins and drivers  
 in stainless steel  
 Keys Item 91



**Solo per  
 serratura  
 per persiana  
 746 E-19**  
 Only for shutter  
 lock 746 E-19

n.3  
 cod. 91.01.75 

**71.88.75**

75

6

12

n.2  
 cod. 91.01.75 

**71.84.75**

75

6

12

n.1 KA  
 cod. 91.01.75 

**71.89.75**

75

6

12

n.3  
 cod. 91.01.75 

**71.38.75**

75

6

12

n.2  
 cod. 91.01.75 

**71.04.75**

75

6

12

n.1 KA  
 cod. 91.01.75 

**71.39.75 \***

75

6

12

\* per gruppi KA vedere pagina 5/  
 for KA key group please see page 5

**Art./Item: 70 C**

**In ottone**  
**Perni e controperni**  
**in acciaio inox**  
**Chiavi Art.91**

In brass  
 Pins and drivers  
 in stainless steel  
 Keys Item 91



n.3  
 cod. 91.01.75 

**70.09.75**

75

6

12

**Art./Item: 80**

**Corpo in zama**  
**Perni e controperni**  
**in acciaio inox**  
**Chiavi Art.91**

Body in zamak  
Pins and drivers  
in stainless steel  
Keys Item 91



n.3  
cod. 91.01.75



n.1 KA  
cod. 91.01.75



CODE  
CODE

LENGTH OF KEYS

NUMBER OF PINS



**80.00.75**

75

6

12

**80.10.75**

75

6

12

**Art./Item: R6 Plus**

**Chiave piatta reversibile**  
**1 cantiere + 5 padronali**  
**sigillate. Confezione**  
**industriale**

Reversible flat key  
1 construction + 5 owners  
sealed. Industrial packed

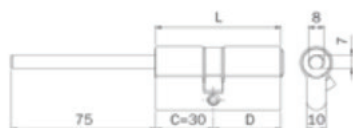

□

C

D

60

**82R66D0309CN.5**

30

30

25

65

**82R66D0359CN.5**

30

35

25

70

**82R66D0409CN.5**

30

40

25

80

**82R66D0509CN.5**

30

50

25

90

**82R66D0609CN.5**

30

60

25

100

**82R66D0709CN.5**

30

70

25

**Prezzi su richiesta**  
Prices on request

**Art./Item: R6 Plus**

**Chiave piatta reversibile**  
**1 cantiere + 5 padronali**  
**sigillate. Confezione**  
**industriale**

Reversible flat key  
1 construction + 5 owners  
sealed. Industrial packed

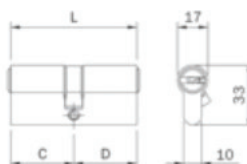

60

**82R6030309CN.5**

30

30

25

65

**82R6030359CN.5**

30

35

25

70

**82R6030409CN.5**

30

40

25

70

**82R6035359CN.5**

35

35

25

75

**82R6030459CN.5**

30

45

25

75

**82R6035409CN.5**

35

40

25

80

**82R6030509CN.5**

30

50

25

80

**82R6035459CN.5**

35

45

25

85

**82R6035509CN.5**

35

50

25

85

**82R6040459CN.5**

40

45

25

90

**82R6030609CN.5**

30

60

25

90

**82R6035559CN.5**

35

55

25

90

**82R6040509CN.5**

40

50

25

90

**82R6045459CN.5**

45

45

25

95

**82R6035609CN.5**

35

60

25

95

**82R6045509CN.5**

45

50

25

100

**82R6040609CN.5**

40

60

25

100

**82R6050509CN.5**

50

50

25

100

**82R6030709CN.5**

30

70

25

110

**82R6055559CN.5**

55

55

25

**Prezzi su richiesta**  
Prices on request

**Art./Item: 68PO**

**Profilo ovale**  
**In ottone naturale**  
**Tre chiavi**  
 Oval profile  
 In natural brass  
 Three keys

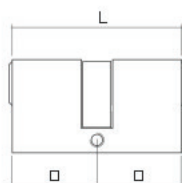

	CODE CODE	C	D		E
55	<b>68.52.55</b>	27,5	27,5	10	

**Adattatore per cilindro predisposto pomolo**  
 Knob cylinder adapter

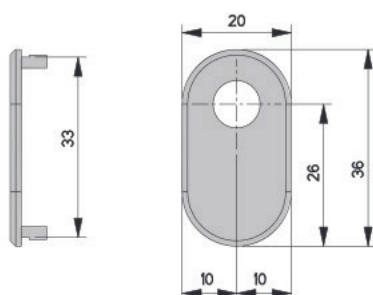

—	<b>541.26.0026.0000</b>	—	—	100	
---	-------------------------	---	---	-----	--

**Pomolo per cilindro predisposto**  
 Knob for pre-arranged cylinder

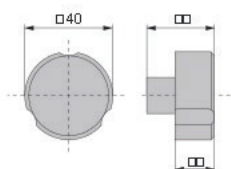

FINISHING					
OLV	<b>529.17.0350.0001</b>	—	—	10	
NKV	<b>529.17.0350.0101</b>	—	—	10	
BRO	<b>529.17.0350.0201</b>	—	—	10	
CRL	<b>529.17.0350.0301</b>	—	—	10	
NKS	<b>529.17.0350.0401</b>	—	—	10	

**Art./Item: One**

**In acciaio temprato**  
**Completo di viti di fissaggio M6**

In tempered steel  
Included fixing screws M6



CODE  
CODE

□

COLOR  
FINISHING



E

98.01.4624

24

EVN

10

98.02.4624

24

OLV

10

98.03.4624

24

CRS

10

98.04.4624

24

CRL

10

**Art./Item: Ekos**

**In lega di zinco con sfere antitrapano,**  
**sistema componibile**

Zink alloy with anti-drill balls,  
setting system



distanziale/spacer  
colletto antistrappo/  
anti snatch spacer

98.11.4624

24

CRL

10

98.12.4624

24

OLV

10

98.13.4624

24

CRS

10

98.14.4624

24

BRO

10

98.46.0005

5

—

10

98.55.0006

5

—

10

**Art./Item: Iron**

**In acciaio temprato**  
**Completo di rosetta interna in nylon**  
**e viti di fissaggio**

In tempered steel  
Internal escutcheon in nylon  
and fixing screws included



98.05.0204

16

NKM

6

98.05.0205

16

EVN

6

98.05.0206

16

OLV

6

98.05.0104

12

NKM

6

98.05.0105

12

EVN

6

98.05.0106

12

OLV

6

**In acciaio temprato**  
**In tempered steel**

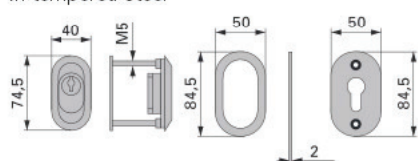

98.03.0120

—

OLV

10

**Coppia copritoppa**  
**Completa di protezione cilindro**  
**per articolo 868 P**

Set of escutcheons  
Includes cylinder protection  
for item 868 P

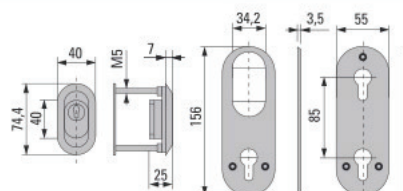

98.03.5868

—

OLV

5

**Coppia copritoppa**  
**Completa di protezione cilindro**  
**per articolo 1120 CP**

Set of escutcheons  
Includes cylinder protection  
for item 1120 CP

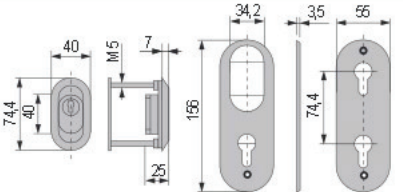

98.03.5120

—

OLV

5

**Mostrina singola universale com-**  
**posta da basetta in nylon, coper-**  
**tura in ottone e viti di fissaggio.**

Universal single escutcheon compos-  
ed of a nylon base, brass cover  
and mounting screws.



98N0XBRO

—

BRO

1

98N0XCRL

—

CRL

1

98N0XCRS

—

CRS

1

98N0XOLV

—

OLV

1

98N1DBRO

—

BRO

10

98N1DCRL

—

CRL

10

98N1DCRS

—

CRS

10

98N1DOLV

—

OLV

10

**Coppia inserti in nylon (interno ed esterno)**  
**per chiave doppia mappa.**

Set of (internal and external) nylon insert  
for double-bitted key.



98N20DMA

—

—

5

**Inserto in nylon per cilindro europeo.**

Nylon insert for Euro profile cylinder.



CODE  
CODE



COLOR  
FINISHING



E

98N00CIL

–

–

10

**Inserto in nylon per cilindro europeo predisposto pomolo.**

Nylon insert for Euro profile cylinder with knob.



98N00POM

–

–

10

**Inserto in nylon per limitatore di apertura.**

Nylon insert for opening limiter.



98N00LIM

–

–

10

**Inserto in nylon per maniglia.**

Nylon insert for handle.



98N00MAN

–

–

10

**Coppia copritoppa lunghi con foro defender Ø46 compatibili con serrature a cilindro europeo serie 600G/GF, con supporto plastico e copertura metallica. Dotazione viti di fissaggio, adattatori foro maniglia.**

Set of double escutcheons for cylinder and handle. With hole for defender Ø46 compatible with Euro profile cylinder locks series 600G/GF. Supplied with plastic support and metal cover, complete with mounting screws, handle hole adapters.



98L1DBRO

–

BRO

1

98L1DOLV

–

OLV

1

98L1DCRS

–

CRS

1

**Coppia copritoppa lunghi predisposti per serrature doppia mappa serie 600D/DF, con supporto plastico e copertura metallica. Dotazione viti di fissaggio, adattatori foro maniglia, adattatori per chiave a doppia mappa.**

Set of double escutcheons for double-bitted and handle. Compatible with double-bitted locks series 600D/DF. Supplied with plastic support and metal cover, complete with mounting screws, handle hole adapters, adapters for double-bitted key.



98L0DBRO

–

BRO

1

98L0DOLV

–

OLV

1

98L0DCRS

–

CRS

1

**Coppia copritoppa  
per articolo 1120/  
1120 PV/1120 P**

Set of escutcheons  
for item 1120/  
1120 PV/1120 P

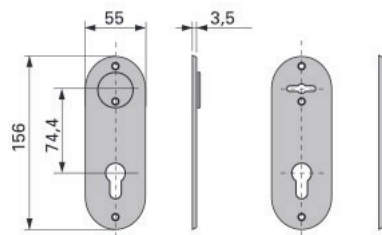

CODE  
CODE



FINISHING



E

98.01.0120

—

OLV

10

**Coppia copritoppa  
per articolo 800 P/  
808 P/811 P**

Set of escutcheons  
for item 800 P/808 P/  
811 P

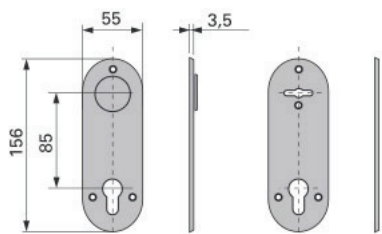

98.01.0800

—

OLV

10

**Coppia copritoppa  
per articolo 1120 CP**

Set of escutcheons  
for item 1120 CP

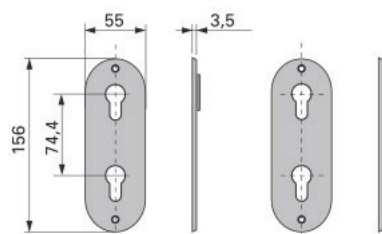

98.01.5120

—

OLV

10

**Coppia copritoppa  
per articolo 868 P**

Set of escutcheons  
for item 868 P

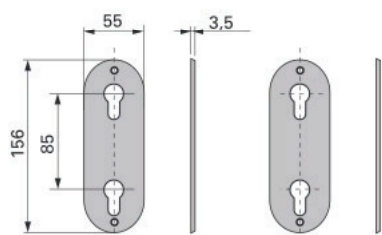

98.01.5868

—

OLV

10

**Coppia copritoppa  
per serrature D.M./serie 1120/  
serie 800/serie 600**

Set of escutcheons  
for double bitted locks/  
series 1120/serie 800/  
series 600

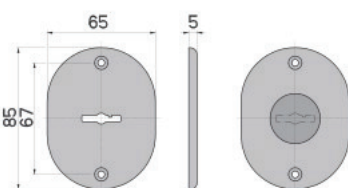

98.0B.3608

—

OLV

10

98.2B.0608

—

CRL

10

**Coppia copritoppa  
per articolo 1120 C/**

Set of escutcheons  
for item 1120 C

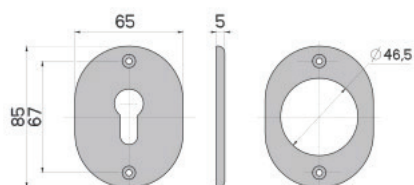

98.0B.3120

—

OLV

10

98.2B.1120

—

CRL

10

**Coppia copritoppa  
per serrature serie 600**

Set of escutcheons  
for 600series locks

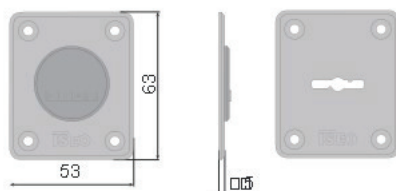

98.608D.00

—

OLU

10