

Art./Item: 357 SC

Cilindro interno, cilindro esterno fisso, scrocco autobloccante, entrata variabile mm 50/60/70/80

Internal cylinder, fixed external cylinder, self-locking latch, variable backset 50/60/70/80 mm



n.3
cod. 94.03.57

Senza tettuccio e spessore incontro
Without lock and strike support

DOOR
CODEDOOR
BACKSETDOOR
HAND**357.00.01****357.00.02****357.10.01****357.10.02**Variable mm 50/60/70/80
Adjustable 50/60/70/80 mm

DX

1

SX

1

DX

1

SX

1

Art./Item: 357 SP

Pulsante e cilindro interno, cilindro esterno fisso, scrocco autobloccante, fermo a giorno, entrata variabile mm 50/60/70/80

Internal cylinder and press-button, fixed external cylinder, self-locking latch, latch retainer engaged by key, variable backset 50/60/70/80 mm.



n.3
cod. 94.03.57

Senza tettuccio e spessore incontro
Without lock and strike support

357.01.01**357.01.02****357.11.01****357.11.02**Variable mm 50/60/70/80
Adjustable 50/60/70/80 mm

DX

1

SX

1

DX

1

SX

1

Art./Item: 357 SPS

Pulsante e cilindro interno, cilindro esterno staccato, scrocco autobloccante, fermo a giorno, entrata variabile mm 50/60/70/80

Internal cylinder and press-button, external separate cylinder, self-locking latch, latch retainer engaged by key, variable backset 50/60/70/80 mm.



n.3
cod. 94.03.57

357.01.11**357.01.12**Variable mm 50/60/70/80
Adjustable 50/60/70/80 mm

DX

1

SX

1

Art./Item: 711 K

Una mandata, catenaccio e scrocco reversibile, tre chiusure, frontale in acciaio zincato mm 25x3

One throw, bolt and reversible latch, three locking points, forend in steel, zinc-plated 25x3 mm



n.2
cod. 91.01.75

n.1 KA
cod. 91.01.75

711.14.25**711.14.30****711.14.35****711.34.25****711.34.30****711.34.35**

25

30

35

25

30

35

-

-

-

-

-

-

12

12

12

12

12

12

Art./Item: 713 Cilindro europeo/Euro profile Cylinder**Art./Item: 713 K Cilindro a croce/Cross key Cylinder**

Una mandata, tre chiusure, frontale in acciaio zincato mm 25x3

One throw, three locking points, forend in steel, zinc-plated 25x3 mm



Cilindro da ordinare a parte
Cylinder to be ordered separately

n.3
cod. 91.01.75

n.2
cod. 91.01.75

n.1 KA
cod. 91.01.75

713.04.25**713.04.30****713.04.35****713.11.25****713.11.30****713.11.35****713.14.25****713.14.30****713.14.35****713.34.25 *****713.34.30 *****713.34.35 ***

25

30

35

25

30

35

25

30

35

25

30

35

-

-

-

-

-

-

-

-

-

-

-

-

12

12

12

1

1

1

12

12

12

12

12

12

* per gruppi KA vedere pagina 5/
for KA key group please see page 5

Art./Item: 743 Cilindro europeo/Euro profile Cylinder

Art./Item: 743 K Cilindro a croce/Cross key Cylinder

Una mandata, tre chiusure,
frontale in acciaio zincato
mm 25x3

One throw, three locking
points, forend in steel,
zinc-plated 25x3 mm

Corsa aste 25 mm/Rods excursion 25 mm



Cilindro
da ordinare a parte
Cylinder to be
ordered separately

n.3
cod. 91.01.75

n.2
cod. 91.01.75

n.1 KA
cod. 91.01.75

* per gruppi KA vedere pagina 5/
for KA key group please see page 5

Art./Item: 714

Una mandata,
tre chiusure,
frontale in acciaio
zincato mm 25x3

One throw,
three locking points,
forend in steel,
zinc-plated 25x3 mm



Cilindro
da ordinare a parte

Cylinder to be
ordered separately



Art./Item: 746 Cilindro europeo/Euro profile Cylinder

Art./Item: 746 K Cilindro a croce/Cross key Cylinder

Movimento del catenaccio
comandato dalla maniglia
Chiusura ad una mandata
Catenaccio con
blocco di sicurezza
ad inserimento automatico
(per entrate 25, 30 e 35)
Corsa aste 25 mm
(per entrate 25, 30 e 35)

Movement of bolt
controlled by handle
One throw lock
Bolt with automatic
security blockage
(for backsets 25, 30 and 35)
25mm rod length
(for backsets 25, 30, 35)

Corsa aste 25 mm/Rods excursion 25 mm



Entrata 19 mm/Backset 19 mm

Cilindro
da ordinare a parte
Cylinder to be
ordered separately

n.3
cod. 91.01.75

n.2
cod. 91.01.75

n.1 KA
cod. 91.01.75

* per gruppi KA vedere pagina 5/
for KA key group please see page 5

**Tutti i modelli con entrata 19 mm sono
in esaurimento**
Items with backset 19 mm are in exhaustion

746.04.19	19	—	12
746.04.25	25	—	12
746.04.30	30	—	12
746.04.35	35	—	12
746.11.19	19	—	1
746.11.25	25	—	1
746.11.30	30	—	1
746.11.35	35	—	1
746.14.19	19	—	12
746.14.25	25	—	12
746.14.30	30	—	12
746.14.35	35	—	12
746.34.19	19	—	12
746.34.25 *	25	—	12
746.34.30 *	30	—	12
746.34.35 *	35	—	12

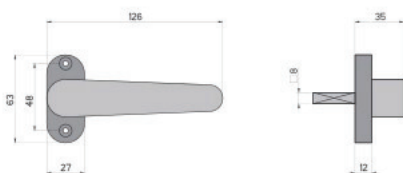
Maniglia
In nylon neroHandle
In black nylonper articolo/for item
0746CODE
CODEECCO
BACKSETECCO
HAND

E

98.00.0706

-

-

12

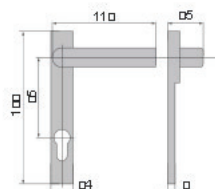
Maniglia
In nylon neroHandle
In black nylonper articolo/for item
0746**98.00.716**

-

-

12

**Adattatore
per cilindro a croce**
Adaptor for cross key cylinder**541.26.0026.0000**

-

-

12

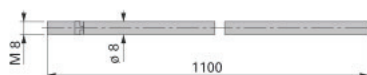
Asta
Attacco filettato M8
In acciaio zincatoM8 rod screwed
connection
In steel zinc plated**Confezione industriale senza puntale/Industrial package without tip****9999.50.11**

-

-

50

Con puntale antisega Ø 8mm/With anti-saw tip Ø 8 mm**9999.00.11**

-

-

10

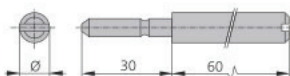
Puntale per asta in acciaio
cementato, taglio cacciaviteRod tips, in cemented steel,
screw-driver cut**Ø 10****9999.71.01**

-

-

50

Ø 12**9999.71.21**

-

-

50

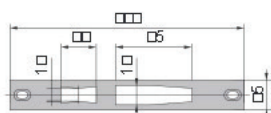
Controbordo
In acciaio zincatoStriking-plate
In zinc-plated steelper articolo/for item
711K**200.00.0761.0000**

-

-

12

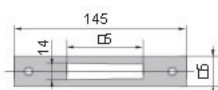
Controbordo
In ferro zincatoStriking-plate
In zinc-plated steelper articolo/for item
713/713K/714/746**Zincato/Zinc-plated****200.00.0716.0200**

-

-

12

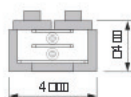
Gruppo bobine
Tensione 12V - 15W C.A.
Con supporto in nylonSet of solenoid units
Voltage 12V - 15W A.C.
With support in nylonper articolo/for item
per serrature serie 357
357 series locks**586.00.0357.0000**

-

-

6