

# Serie 7700

## 7700 Series

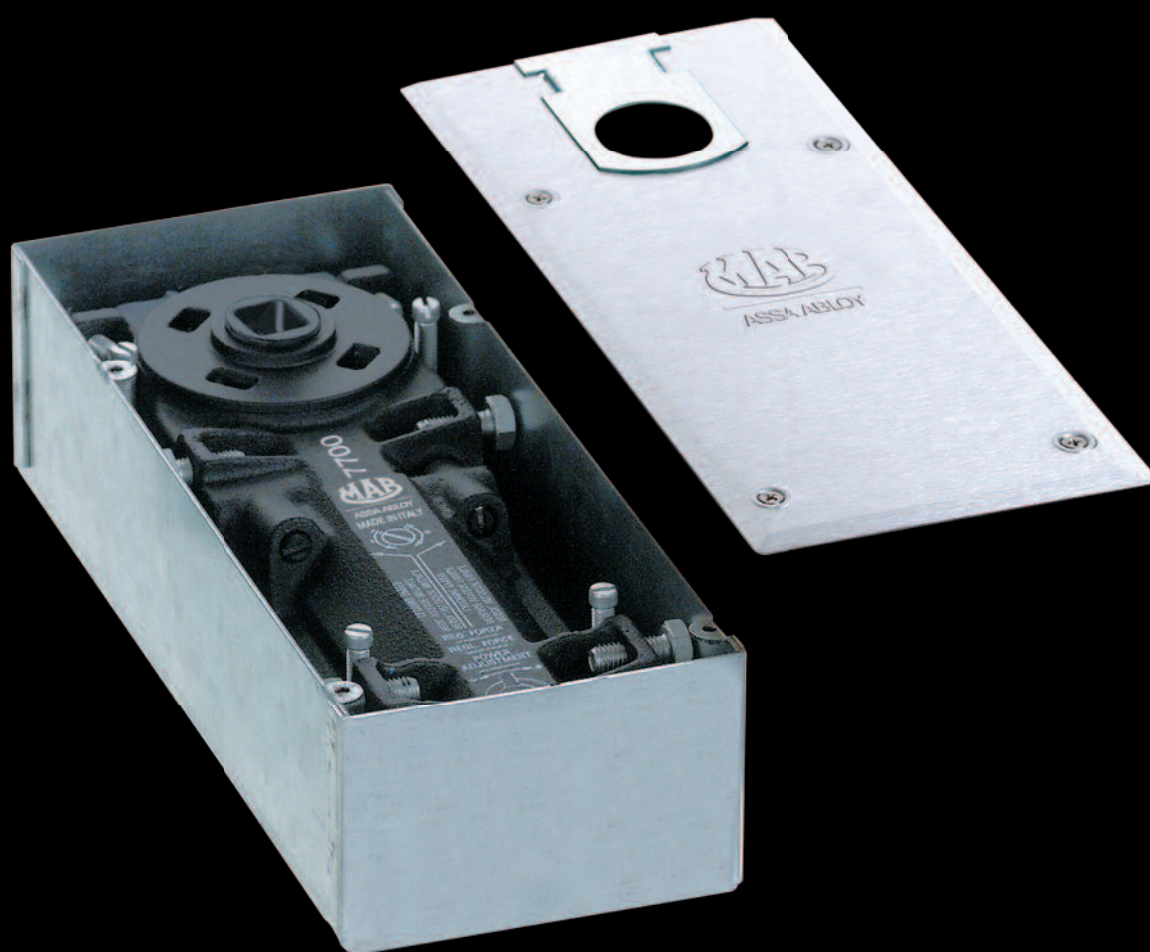

ASSA ABLOY, the global leader  
in door opening solutions



# Chiudiporta a pavimento a potenza regolabile con freno meccanico

## *Adjustable power floor spring with mechanical back check*

### Caratteristiche tecniche:

- Forza regolabile in continuo EN 2-4 che unita ad alta efficienza permette una vera personalizzazione delle forze di apertura e chiusura.
- Universale per porte destre, sinistre e a ventola.
- Adatto per porte in legno, metallo, vetro.
- Raccomandato per tutti i tipi di porte, sia esterne che interne.
- Ampia regolazione in tutti i sensi nella cassetta a murare per recuperare eventuali disallineamenti o dislivelli senza smontare la porta.
- Apertura consentita fino a 180° nei due sensi e richiamo idraulico da circa 150°, con fermaporta a 90°, 105° o in ogni angolo tra 150° e 180°. La versione senza fermo non permette l'apertura oltre 150° e chiude sempre.
- Velocità di chiusura controllata da due valvole indipendenti termostatiche di facile regolazione: chiusura dolce o con potente scatto finale per assicurare il tipo di chiusura più adatto.
- Valvola di sovrappressione atta a salvaguardare gli organi meccanici in caso di abusi.
- Freno meccanico all'apertura per smorzare aperture incontrollate.
- Varietà di perni disponibili: italiano (standard), tedesco, francese.
- Perno intercambiabile da 0 a +30 mm.
- Ampia gamma di finiture della piastra di copertura: inox lucido, inox satinato, ottone lucido.
- Tutti i modelli hanno certificazione prodotto in base alla normativa EN1154 e un certificato ad 1.000.000 di cicli. Certificato **CE**

### Specifiche per capitoli

Chiudiporta a pavimento a potenza regolabile con freno meccanico all'apertura, MAB 7700 (EN 2-4).

### Features:

- Adjustable power EN 2-4 by means of stepless governor which coupled with high efficiency allows a real personalization of opening/closing forces.
- Universal for right, left or double action doors.
- Suitable for timber, metal and glass doors.
- Recommended for all type of doors, external and internal.
- Large range of adjustment within cement box to solve possible alignment problems on site without taking down the door.
- Opening up to 180° in both swings with hydraulic control from approx 150°, hold open at 90°, 105° or any angle between 150° and 180°. The non hold open version has a back stop at 150°.
- Closing speed controlled by two easily adjustable independent thermostatic valves: soft closing or powerful latching action to ensure proper closing also in case of hard-to-latch locks.
- Over pressure valve to safeguard the mechanical components in case of abuse.
- Mechanical back check to prevent uncontrolled openings.
- Variety of available spindles: square Italian (standard), square French, rectangular German, spindles.
- Interchangeable spindle from 0 to +30 mm.
- Architectural finishes: coverplates in polished stainless steel, satin stainless steel, polished brass.
- All models have quality certification according to the EN1154 and a certification up to 1.000.000 cycles. **CE** mark

### Specifications

Adjustable power floor spring with mechanical back check, MAB 7700 (EN 2-4).

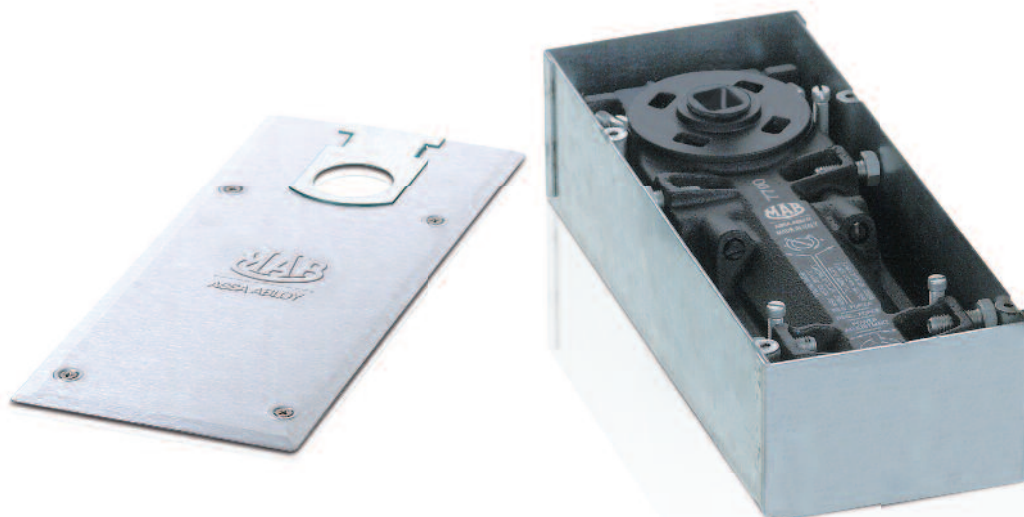

Regolazione nella  
cassetta a murare:  
- angolare 4°.  
- frontale 10 mm.  
- verticale 9 mm.

Adjustment within  
cement box:  
- angular 4°.  
- front 10 mm.  
- vertical 9 mm.

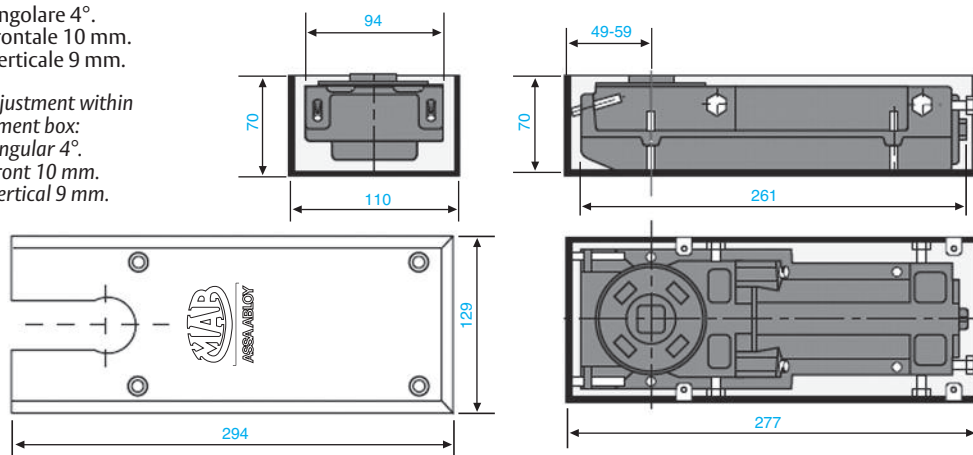

Piastre di copertura  
da ordinare separatamente

Coverplates  
to be ordered separately



Colori / Colours

Ottone lucido / Polished brass

Acciaio satinato / Satin stainless steel

Acciaio lucido / Polished stainless steel

Composizione del codice

Composition of article reference

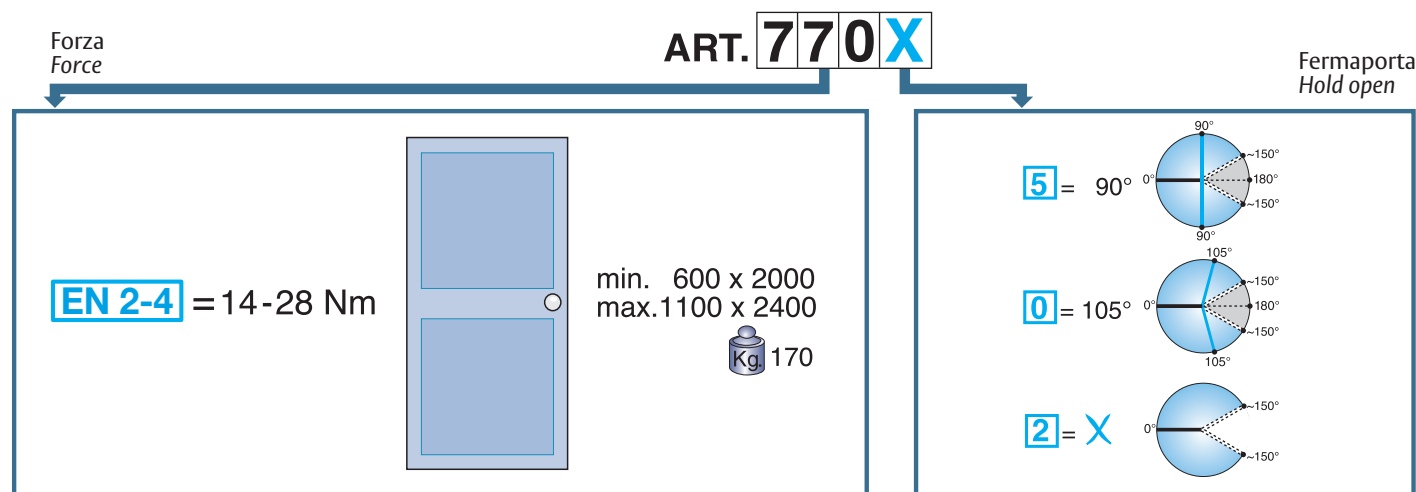

Identificazione del fermo

Hold open identification

Data di produzione  
MM-AA (mese - anno)

Date of manufacture  
MM-YY (month - year)

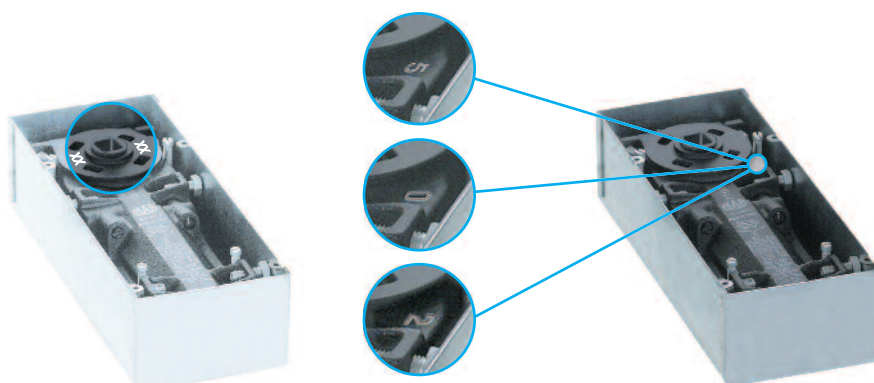

# Controllo di chiusura Closing control

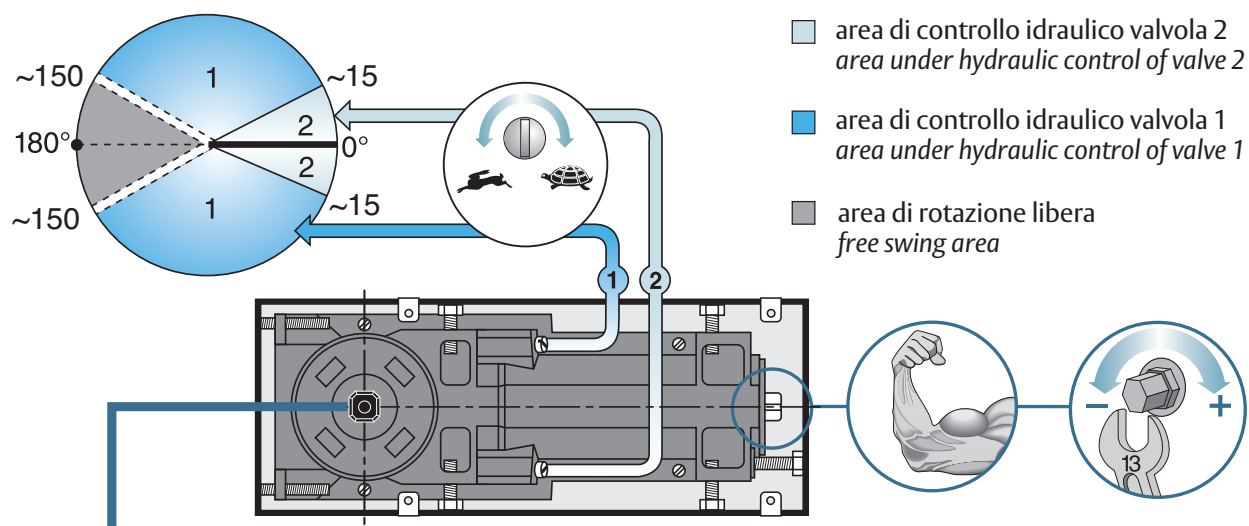

L'uso di un olio estremamente termostabile rende rara l'utilizzazione delle valvole.  
Valvola 1: regola la velocità di chiusura da 150° a 15°.  
Valvola 2: regola la velocità di chiusura da 15° a 0° (scatto finale).  
*The use of a highly thermoconstant hydraulic fluid makes speed adjustments rarely needed.*  
Valve 1 controls the closing speed from 150° to 15°.  
Valve 2 controls the closing speed from 15° to 0° (final latch).

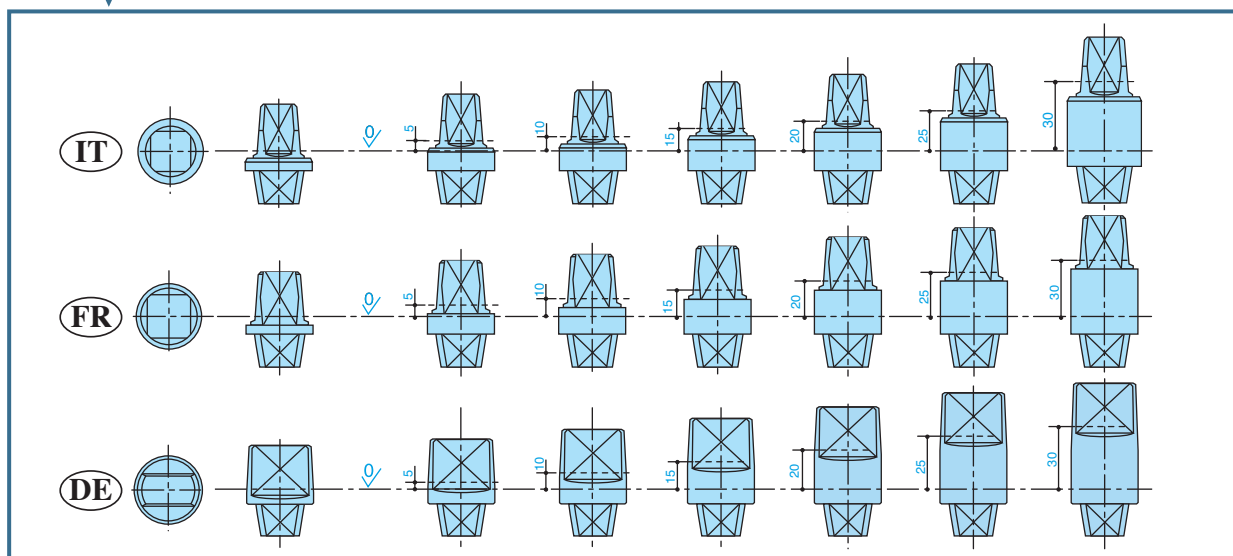

## Montaggio universale Universal mounting

Destra / Right

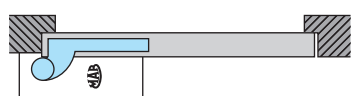

A ventola / Double action

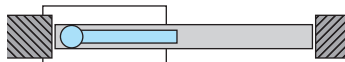

Sinistra / Left

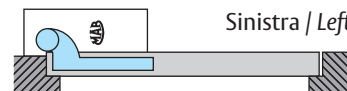

## Codice / Code

AC 299

Piletta a murare perno rettangolare tedesco.  
Floor idle pivot.  
Rectangular German spindle.



max. 120

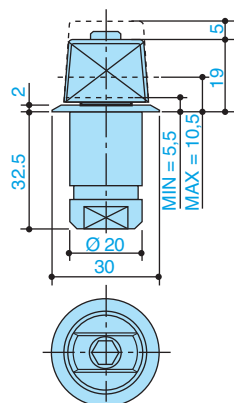

## Codice / Code

AC 298

Braccio inferiore in acciaio per porte a ventola.  
Cava rettangolare tedesca.  
Bottom arm in steel for double action doors.  
Rectangular German spindle.



max. 300

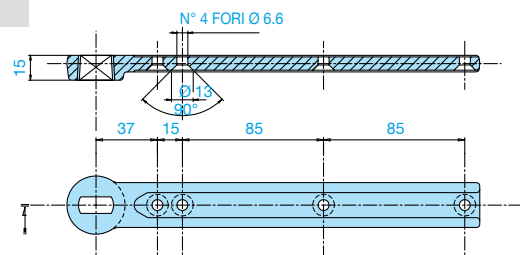

## Codice / Code

AC 246

Piletta a murare perno quadro italiano.  
Floor idle pivot.  
Square Italian spindle.



max. 120

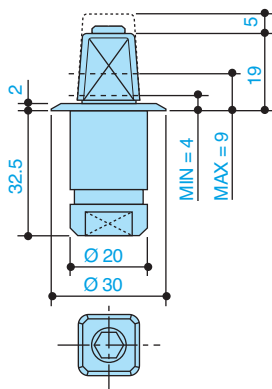

## Codice / Code

AC 297

Braccio inferiore in acciaio per porte a ventola.  
Cava quadro italiano.  
Bottom arm in steel for double action doors.  
Square Italian spindle.



max. 300

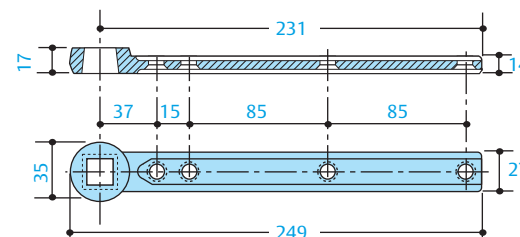

## Codice / Code

AC 213

Braccio inferiore in acciaio. Cava quadro italiano.  
Bottom arm in steel for double action doors.  
Square Italian spindle.



max. 170

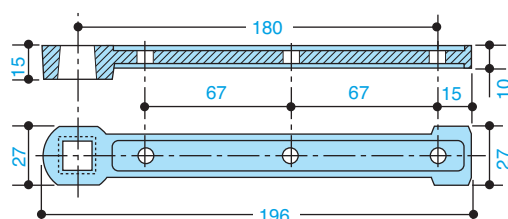

## Codice / Code

AC 2

Braccio inferiore in ottone per porte a ventola.  
Cava quadro italiano.  
Bottom arm in brass for double action doors.  
Square Italian spindle.



max. 100

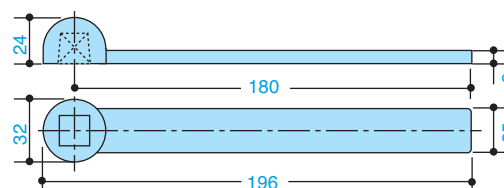

## Codice / Code

AC 115

Braccio inferiore reversibile in acciaio per porte a ventola. Cava quadro italiano.  
Reversible bottom arm in steel for double action doors.  
Square Italian spindle



max. 300

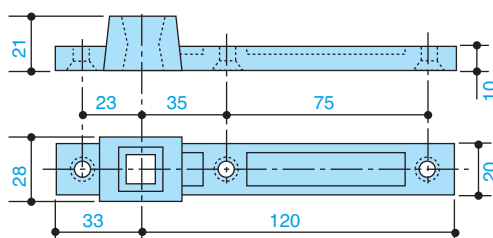

## Codice / Code

AC 393

Braccio inferiore reversibile in acciaio per porte a ventola. Cava rettangolare tedesca.  
Reversible bottom arm in steel for double action doors.  
Rectangular German spindle.



max. 300

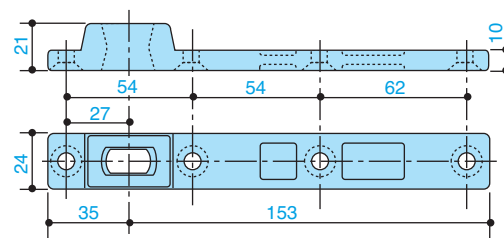



## Codice / Code

AC 8

Perno superiore per porte a ventola.  
Double acting top pivot.

 max. 300

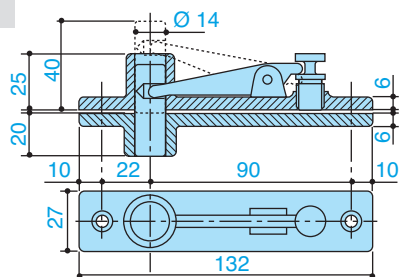

## Codice / Code

AC 583

Braccio inferiore destro e sinistro in acciaio per porte a battente, interasse mm. 36.  
Cava quadro italiano.  
Right and left bottom arm in steel for single acting doors, 36 mm. offset.  
Square Italian spindle.

 max. 300

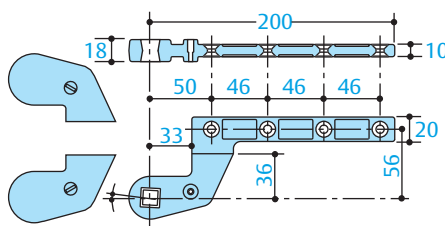

## Codice / Code

AC 384

Perno superiore in acciaio per porte a battente sinistre o destre, interasse mm. 36.  
Top pivot in steel for left or right doors 36 mm. offset.

 max. 300

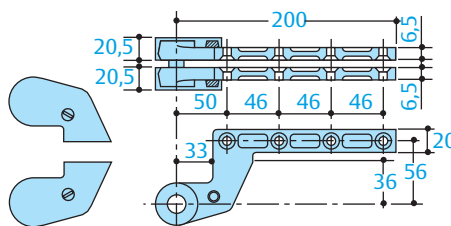

## Codice / Code

AC 261

Prolunga + 23 mm. in acciaio per quadro italiano.  
Extension +23 mm. in steel for square Italian spindle.

 max. 300

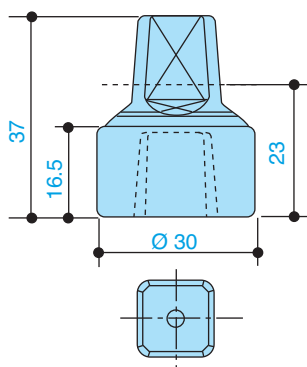

## Codice / Code

AC 118

Perno superiore per porte a ventola. Punto di rotazione registrabile.  
Double acting top pivot. Adjustable pivot point.

 max. 170

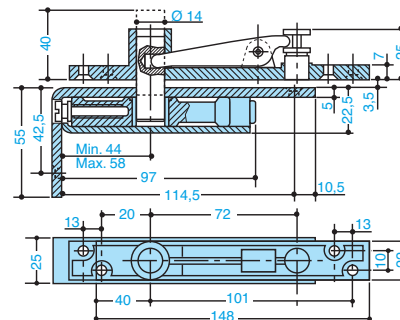

## Codice / Code

AC 375

Perno superiore in acciaio massiccio per porte a ventola, con boccola autolubrificante.  
Double acting top pivot in full steel with self lubricating bushing.

 max. 300

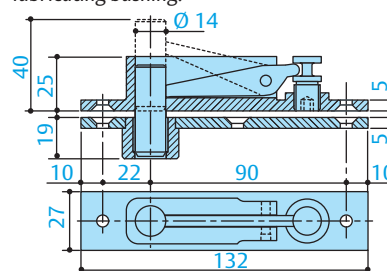

## Codice / Code

AC 392

Braccio inferiore destro e sinistro in acciaio per porte a battente, interasse mm. 36.  
Cava rettangolare tedesca.  
Right and left bottom arm in steel for single acting doors, 36 mm. offset. Rectangular German socket.

 max. 300

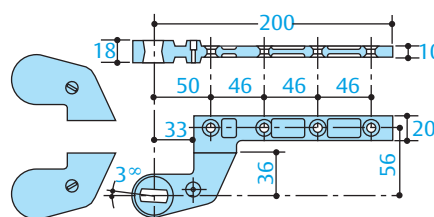

## Codice / Code

AC 7

Perno superiore in ottone naturale con cuscinetto a sfere per porte destre o sinistre.  
Single acting top pivot in natural brass with ball bearing for right or left doors.

 max. 100

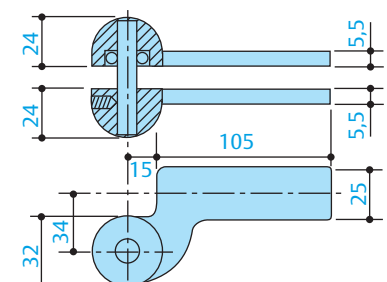

## Codice / Code

AC 3

Braccio inferiore sinistro in ottone naturale per porte a battente. Cava quadro italiano.  
Left bottom arm in natural brass for single acting doors. Square Italian spindle.

 max. 100

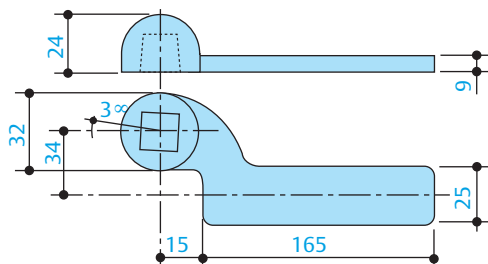

## Codice / Code

AC 1

Braccio inferiore destro in ottone naturale per porte a battente. Cava quadro italiano.  
Right bottom arm in natural brass for single acting doors. Square Italian spindle.

 max. 100

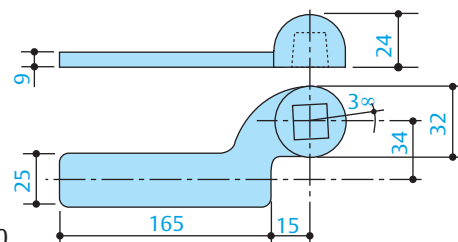

## Codice / Code

AC 373

Braccio inferiore destro in acciaio per porte a battente, interasse mm. 36. Cava quadro francese.  
Right bottom arm in steel for single acting doors, 36 mm. offset. Square French spindle.

 max. 300

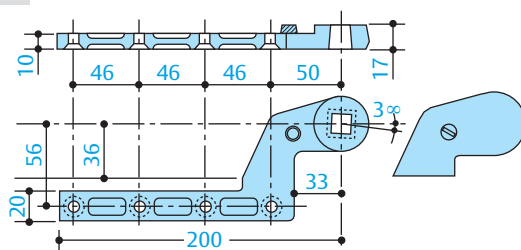

## Codice / Code

AC 374

Braccio inferiore sinistro in acciaio per porte a battente, interasse mm. 36. Cava quadro francese.  
Left bottom arm in steel for single acting doors, 36 mm. offset. Square French spindle.

 max. 300

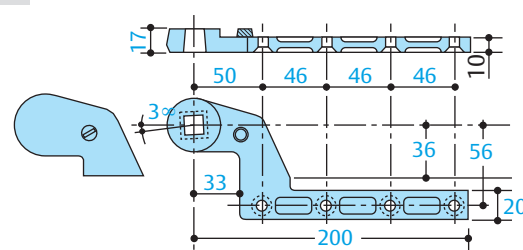

Perni intercambiabili  
Detachable spindles

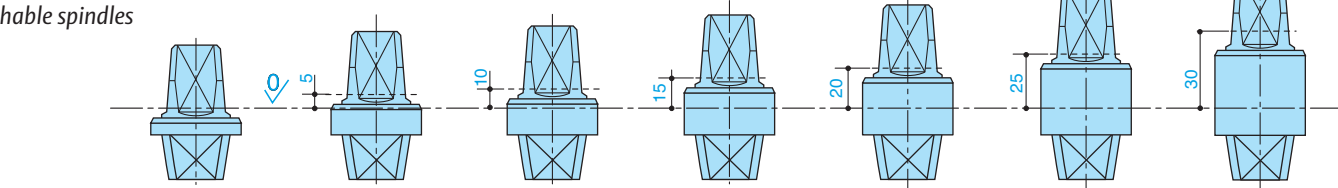

Codice / Code	Codice / Code	Codice / Code	Codice / Code	Codice / Code	Codice / Code	Codice / Code
AC 340	AC 341	AC 342	AC 343	AC 344	AC 345	AC 346
AC 350	AC 351	AC 352	AC 353	AC 354	AC 355	AC 356
AC 360	AC 361	AC 362	AC 363	AC 364	AC 365	AC 366

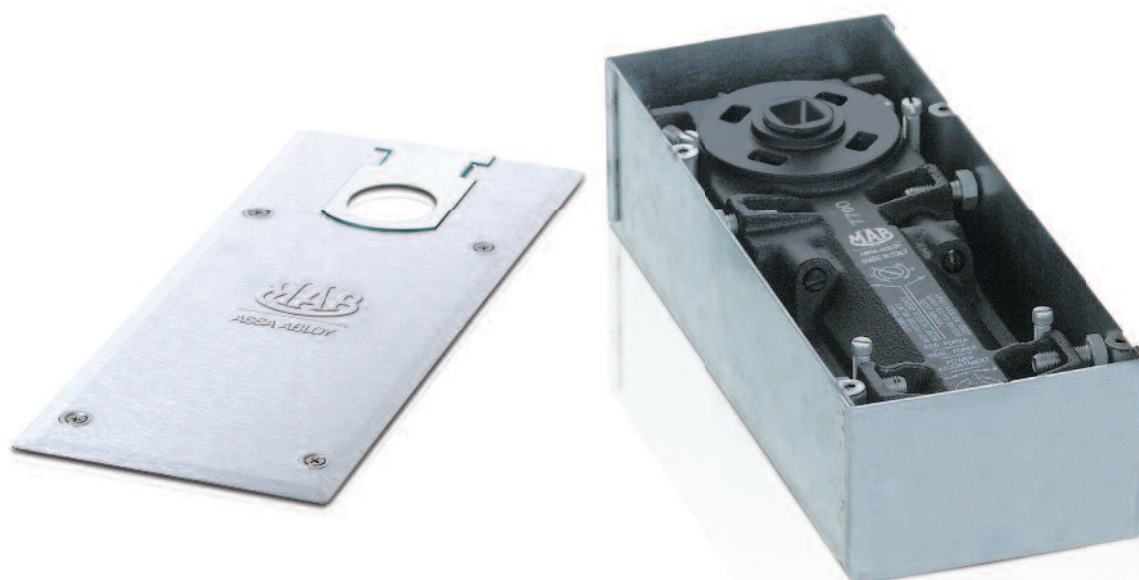

ASSA ABLOY Italia S.p.A.  
 Via Bovaresa 13 - 40017 San Giovanni in Persiceto (BO) Italy  
 Tel. +39 051 6812411 - Fax +39 051 827486  
[info@assaabloy.it](mailto:info@assaabloy.it) - [www.assaabloy.it](http://www.assaabloy.it)

ASSA ABLOY Italia S.p.A. si riserva di apportare in qualunque momento e senza preavviso le modifiche necessarie per migliorare ed evolvere le caratteristiche dei propri prodotti. Fotografie, illustrazioni e descrizioni sono da ritenersi indicative.  
 ASSA ABLOY Italia S.p.A. reserves the right at any time and without notice, the necessary modifications in order to improve and evolve the characteristics of their products. Photographs, illustrations and descriptions ought to be considered as indicative.

H001E25 / 03-2014

ASSA ABLOY is the global leader in door opening solutions, dedicated to satisfying end-user needs for security, safety and convenience.

[www.assaabloy.com](http://www.assaabloy.com)

