

Door Closers Catalogue



CE Certifications - EN 1154



Product index

Surface mounted Door Closers with Rack and Pinion technology and Selectable closing force

Door Closer series 50	Pag	8
Door Closer series 150	Pag	10
Door Closer series 564	Pag	12
Door Closer series 609	Pag	14

Surface mounted Door Closers with Rack and Pinion technology and Fixed closing force

Door Closer series 400	Pag	16
Door Closer series 500	Pag	18

Overhead door closers with Rack and Pinion technology and Adjustable closing force

Door Closer series 2240	Pag	20
-------------------------	-----	----

Surface mounted Door Closers with Cam-Motion® Technology and Adjustable closing force

Door Closer series 2250	Pag	22
-------------------------	-----	----

Floor Springs with Cam-Motion® technology and fixed closing force

Door Closer series 7100	Pag	24
Door Closer series 7600	Pag	26
Door Closer series 4200	Pag	28

Floor Springs with Cam-Motion® technology and Adjustable closing force

Door Closer series 7700	Pag	30
Door Closer series 750	Pag	32
Floor Springs Accessories	Pag	34
Patch fittings for glass doors	Pag	36

Transom Door closers

Door Closer series 5600	Pag	40
Door Closer series 5750	Pag	42

Gate Closers

Door Closer series 620 C	Pag	44
Door Closer series 650 C	Pag	46
Door Closer series 680 C	Pag	48



Surface mounted door closer 50

Compact and versatile

Features:

- Body in special alloy aluminium.
- Selectable closing force sizes 2-3-4 for door 850-1100 mm wide.
- Closing speed adjustable by non critical thermostatic valve.
- Final latch from approx. 10°. The latch angle is easily reduced by turning the forearm, up to its elimination (soft closing). The possibility to ensure an efficient closure also from an arc of just few degrees, guarantees reduced noise action in case of hard-to-close latches.
- Available Hold Open arm version.
- Standard finishes: silver, matt black, white.

Specification text:

Variable force 2-4 surface mounted door closer, with standard link arm and adjustable hold open arm, MAB 50 series.



Technical drawing

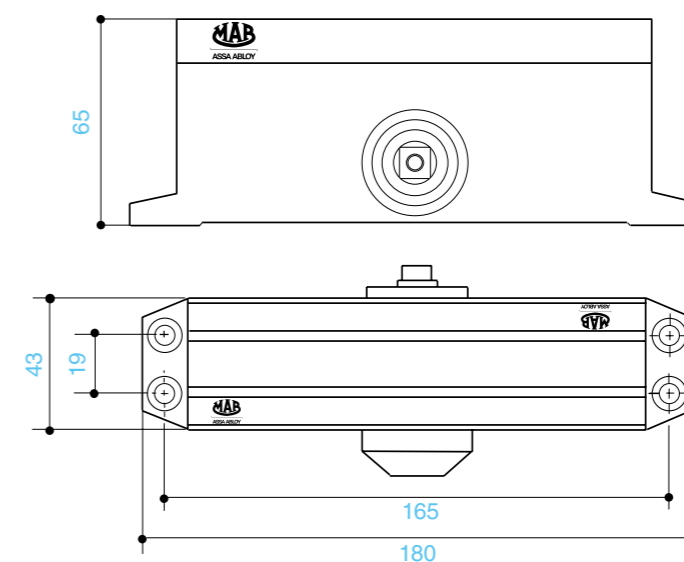



Surface mounted door closer 150

Compact and versatile

Features:

- Body in special alloy aluminium.
- Selectable closing force sizes EN 2/4 for door 850-1100 mm wide.
- Closing speed adjustable by non critical thermostatic valve.
- Final latch from approx. 10 °. The latch angle is easily reduced by turning the forearm, up to its elimination (soft closing). The possibility to ensure an efficient closure also from an arc of just few degrees, guarantees reduced noise action in case of hard-to-close latches.
- Standard finishes: silver, matt black, white RAL 9016.
- Certified  for use with Fire rated doors.

Specification text:

MAB 150 series, with selectable force EN 2-4 surface mounted door closer, CE certified with standard link arm.



	ASSA ABLOY Italia S.p.A. Via Bovaresa, 13 40017 San Giovanni Persiceto (BO) Italy				13		
	0359-CPD-0318	EN 1154:1996+A1:2002	4 3	8 4	2 1	1 1	3
Dangerous substance: None							

Technical drawing

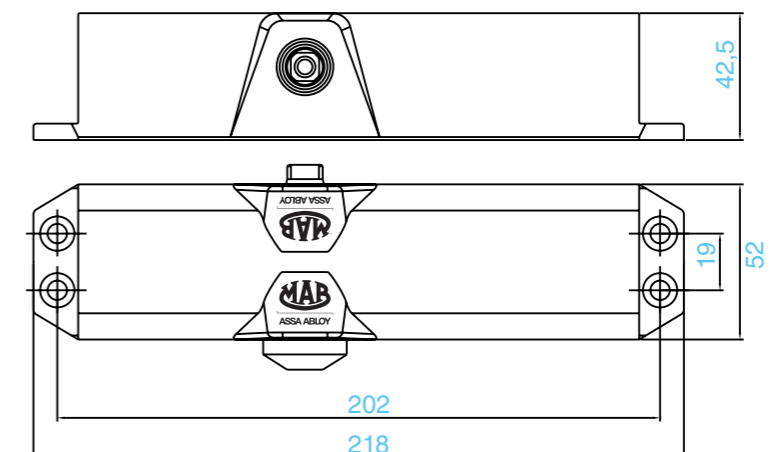



Features:

- Body in high duty cast iron.
- Cover in special impact resistant ABS.
- Variable closing force sizes EN 2-5.
- Integrated hold open device easily adjustable precisely to the desired angle.
- Closing speed 180°-10° adjustable by non critical thermostatic valve which, in case of Without-Final-Latch setting of the arm, controls the complete arc of closing.
- Final latch from approx. 10°. The latch angle is easily reduced by turning the forearm, up to its elimination (soft closing). The possibility to ensure a powerful latch also from an arc of just a few degrees guarantees reduced noisy action in case of hard-to-latch locks.
- Wide range of accessories to make all mountings possible.
- Standard finishes: silver, gold, light bronze, matt black, traffic white. Other finishes may be available on request.

Specification text:

Variable power EN 2-5 surface mounted door closer with integrated adjustable hold open device 70°-140°, thermostatic valve, MAB 564 series.



Technical drawing

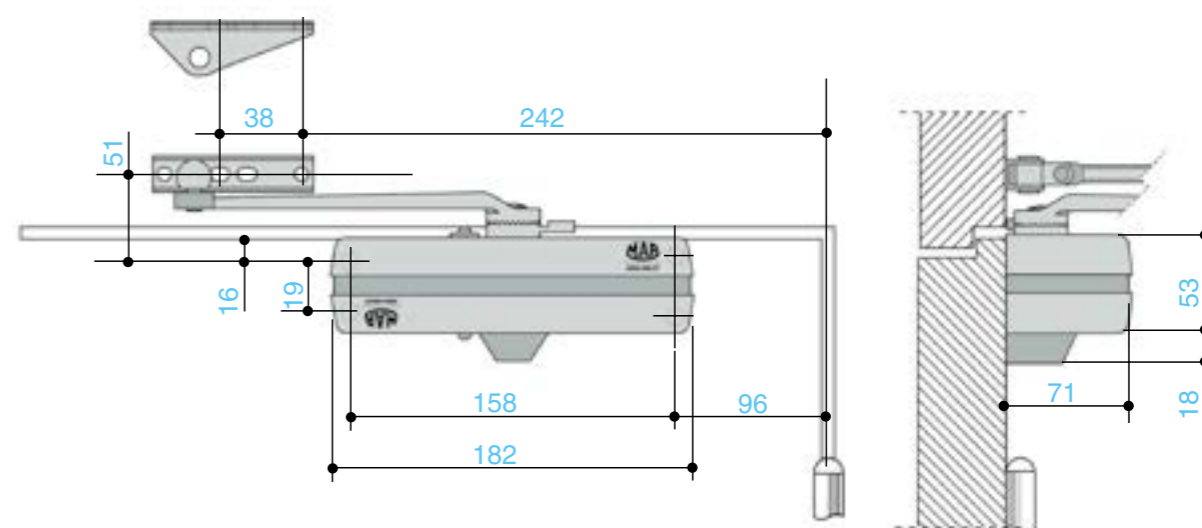





Surface mounted door closer 609

Multifunction heavy duty door closer



Features:

- Body in high duty cast iron.
- Recommended for fire doors and suitable for din drilling template (regular link arm and sliding rail).
- Conformity DIN EN1154 and 
- Closing from 180° controlled by two hydraulic valves.
- Final latch controlled by valve.
- Mounting on narrow profiles made easy by back plate AC174 (optional).
- Mounting with regular arm (variable force EN3-6 + ) , Hold Open arm (variable force EN3-6) and sliding arm (force EN3 + ) to be ordered separately.
- Cover in high impact resistance ABS. Standard finishes: silver, matt black.

Specification text:

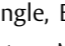
Cast iron body surface mounted closer with variable force EN3-6, one drilling template, certified , two independent speed valves, adjustable final latch angle, EN3 certified  when mounted with sliding arm&rail, type MAB 609 series.



		ASSA ABLOY Italia S.p.A. Via Bovaresa 13 - 40017 San Giovanni in Persiceto (BO) Italy				15	
0425-CPR-2813	EN1154:1996/A1:2002/AC:2006	4	8	6 3	1	1	2

Technical drawing

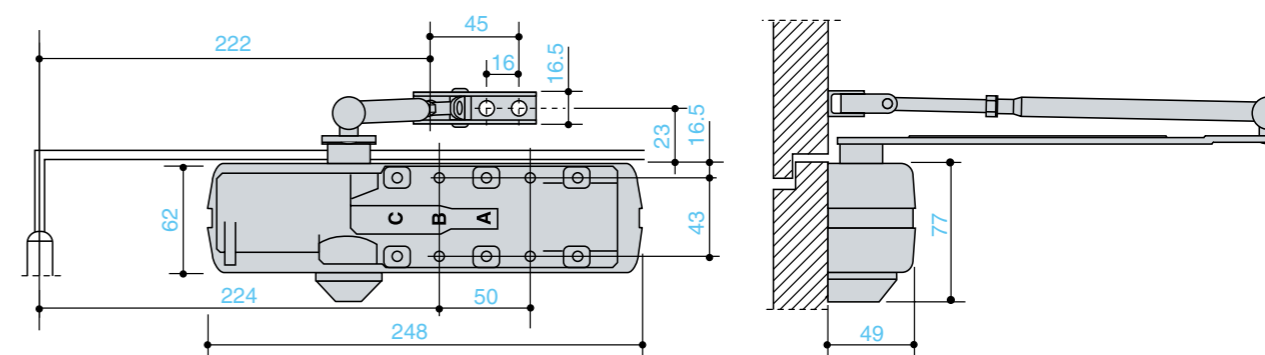





Surface mounted door closer 400

Compact and versatile

Features:

- Body in high duty cast iron.
- Cover in special impact resistant ABS.
- Two fixed forces EN 2 - 3.
- Closing speed 180°-10° and latching speed 10° - 0° adjustable by non critical thermostatic valves.
- Final latch from approx. 10°. The latch angle is easily reduced by turning the forearm, up to its elimination (soft closing). The possibility to ensure a powerful latch also from an arc of just a few degrees guarantees reduced noise action in case of hard-to-close latches.
- Built-in multipoint Hold Open 90° - 180° (optional).
- Wide range of accessories to make all mountings possible.
- Standard finishes: silver, gold, light bronze, matt black, traffic white.
- Mod 403 is certified  for use with Fire rated doors.

Specification text:

Compact surface mounted door closer forces EN 2 and EN 3  with cast iron body, with or without multipoint hold open, with adjustable angle final latch, MAB 400 series.



		ASSA ABLOY Italia S.p.A. Via Bovaresa 13 - 40017 San Giovanni in Persiceto (BO) Italy		10	
0425 D0. 2304	EN 1154:1996+A1:2002	4	8	3	1
					1
					3

Technical drawing

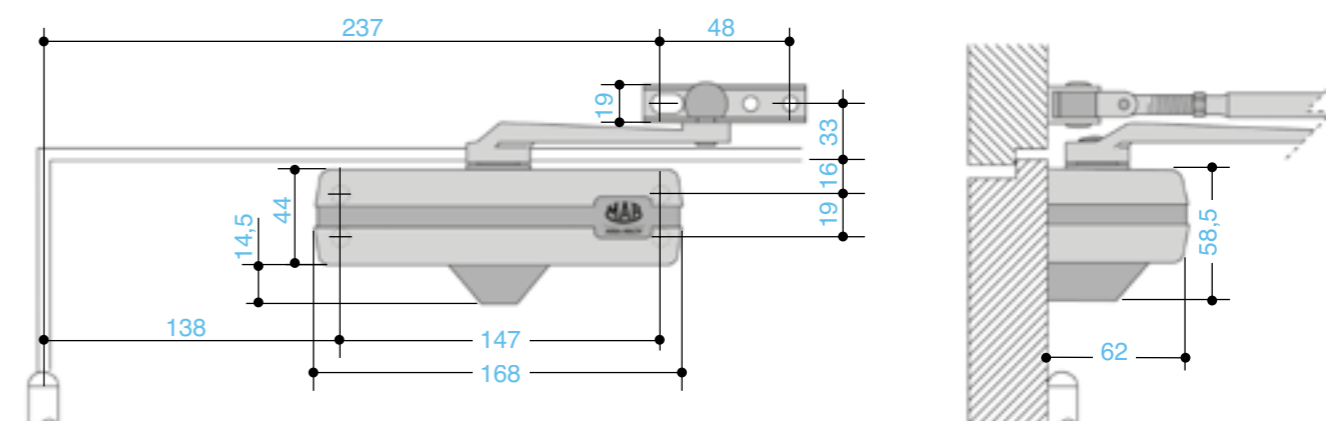



Rack and pinion door closer

Unique MAB adjustable Hold Open device

Features:

- Body in high duty cast iron.
- Cover in special impact resistant ABS.
- Closing force sizes EN 2-3.
- Integrated hold open device easily adjustable precisely to the desired angle. Recommended for EXTERIOR doors.
- Closing speed 180° - 10° adjustable by non critical thermostatic valve which, in case of Without-Final-Latch setting of the arm, controls the complete arc of closing.
- Final latch from approx. 10°. The latch angle is easily reduced by turning the forearm, up to its elimination (soft closing). The possibility to ensure a powerful latch also from an arc of just a few degrees guarantees reduced noisy action in case of hard-to-latch locks.
- Wide range of accessories to make all mountings possible.
- Standard finishes: silver, gold, light bronze, matt black, traffic white RAL 9016. Other finishes may be available on request.

Specification text:

Surface mounted door closer with integrated adjustable Hold open device 70°-140°, thermostatic, MAB 500 series.



Technical drawing

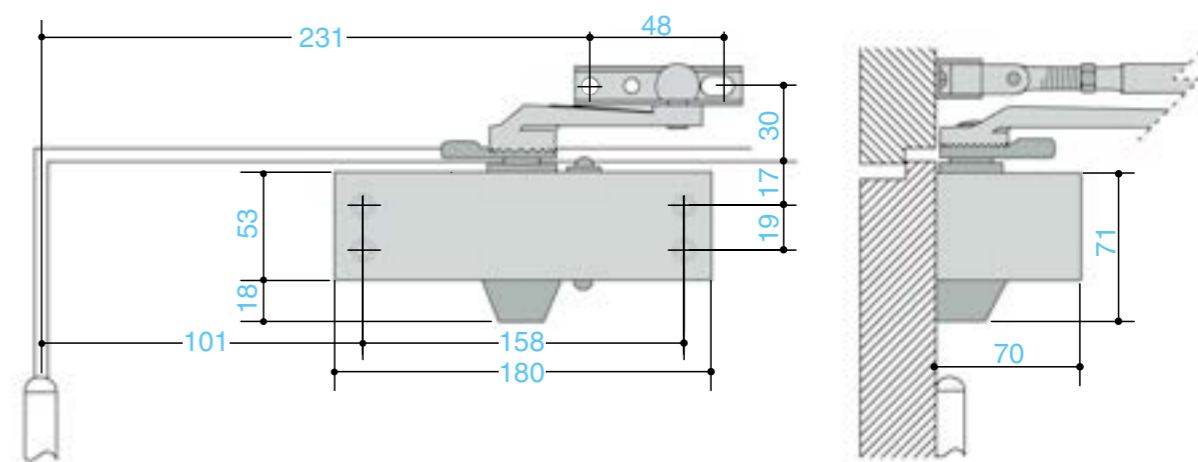



Surface mounted door closer 2240

High performances for superior door controls

Features:

- Body in special alloy aluminium.
- Adjustable power 2-6 with standard link arm and EN 1-4 with sliding arm & rail.
- Vertical adjustability of arm.
- Two speed valves.
- Adjustable hydraulic back check.
- Two overpressure relief valves.
- Insensitive to temperature changes between -35° and +50° C.
- High efficiency.
- Regular or reversed mounting on pull or push side of door.
- Full body covers in: ABS, satin s/steel.
- Finished for ABS covers: silver, gold, black, white.
- Suitable for interior or exterior doors.
- Suitable for doors up to and 1400x2500 for 2240 series.
- Mounting with sliding rail.

Specification text:

Special alloy aluminium body surface mounted closer with adjustable power EN 2-6, certified **CE** two independent and thermostatic valves, adjustable final latch angle EN 1-4 certified **CE** when mounted with sliding arm & rail. Vertical adjustment of arms: the height of the arm can be adjusted up to 14 mm by moving upwards the grooved pinion, MAB 2240 series.



CE		Abloy Oy Wahlforsinkatu 20 FIN-00101 Joensuu		04	
0432-CPD-0047	EN 1154:1996+A1:2002	4	8	6 2	1 1 3

Technical drawing

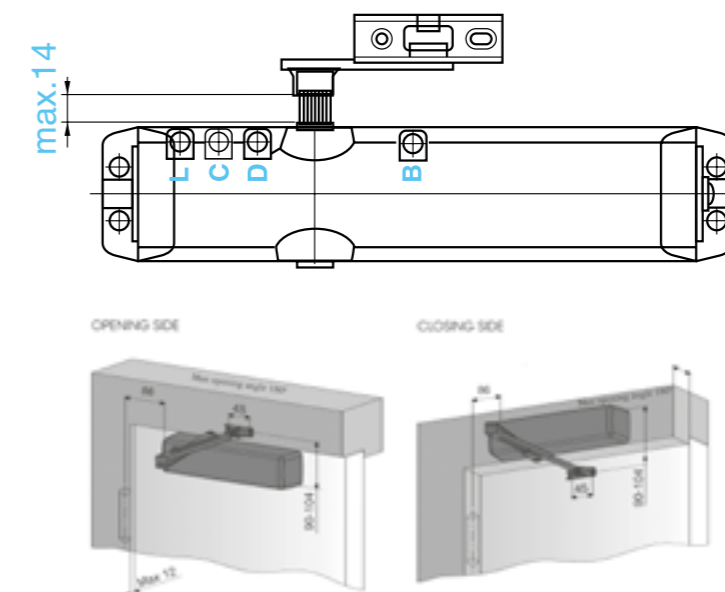



Surface mounted door closer 2250

Cam action technology for high performances



Features:

- Adjustable power 1-6 EN1154.
- Vertical adjustability of arm.
- Two speed valves.
- Adjustable hydraulic back check.
- Two overpressure relief valves.
- Insensitive to temperature changes between -25° and +45° C.
- High efficiency.
- Regular or reversed mounting on pull or push side of door.
- Full body covers in: ABS, satin s/steel.
- Finished for ABS covers: silver, gold, black, white.
- Suitable for interior or exterior doors.
- Suitable for doors up to 1250 x 2500 mm.

Specification text:

Special alloy aluminium body surface mounted closer with adjustable power EN 2-6, certified **CE** two independent and thermostatic valves, adjustable final latch angle EN 1-4 certified **CE** when mounted with sliding arm & rail. Vertical adjustment of arms: the height of the arm can be adjusted up to 14 mm by moving upwards the grooved pinion, MAB 2250 series.



CE		Abloy Oy Wahlforsinkatu 20 FIN-00101 Joensuu			04		
0432-CPD-0047	EN 1154:1996+A1:2002	4	8	6 2	1	1	3

Technical drawing

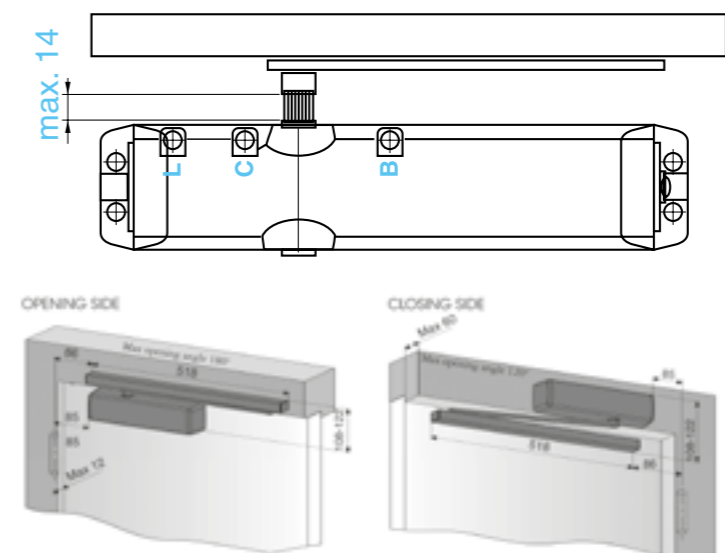



Compact floor spring 7100

Opening angle up to 180° in both side

Features:

- Body in high duty cast iron.
- One body size for three closing force sizes EN1 - EN2 - EN3.
- Universal for right, left or double action doors.
- Suitable for door up-to 100 Kg.
- Suitable for timber, metal and glass doors.
- Ideal for commercial and residential interiors thanks to its compact size and its low opening force (required by children, elderly and disabled users).
- Adjustment in all directions to solve floor level problems without taking down the door.
- Wide range of vertical adjustment to solve problems of undue door friction without need of additional spindle extensions.
- Opening up to 180° in both swings with hydraulic control from approx 135°. Free rotation from 135° to 180°. Hold open at 90°, 105° or any angle between 135° and 180°.
- Closing speed controlled by two easily adjustable independent non critical valves.
- Soft closing or powerful latching action to ensure proper closing also in case of hard-to-latch locks.
- Architectural finishes: coverplates in polished stainless steel, satin stainless steel, polished brass.
- Available with Italian spindle (standard) or French spindle.

Specification text:

Compact floor spring forces EN1-EN2-EN3 with opening to 180° in both swings with two independent thermostatic valves for speed and latch control, suitable for doors up-to 100 Kg, MAB 7100 series.



Technical drawing

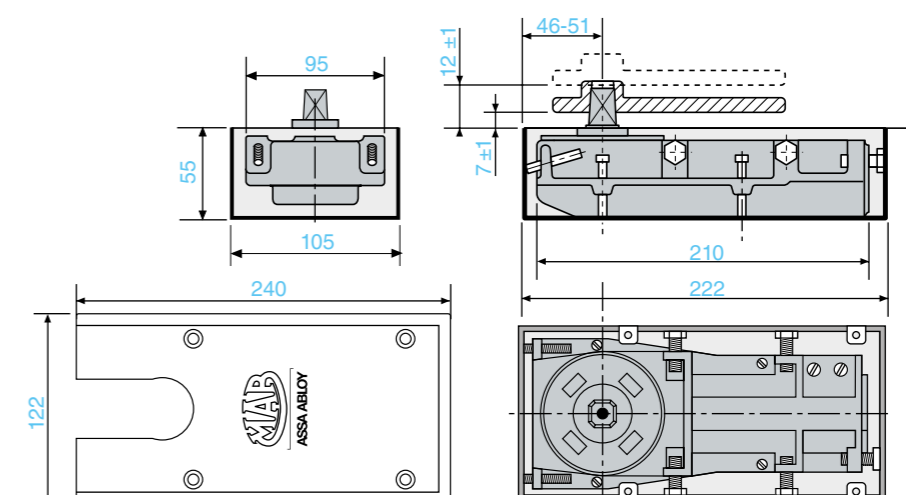



7600 Series floor spring for thin slabs with interchangeable spindles

Features:

- Fix Size EN3 for doors ≤ 950 mm and EN4 for doors ≤ 1100 mm.
- Max door weight 120 kg.
- Universal for right, left and double action doors.
- For internal and external doors.
- Cement box only 40 mm height, to suit thin slabs.
- Cast iron body to ensure strong durability.
- Adjustment in all direction within the cement box.
- Pivot point 51-59 mm without re-locating the cement box thanks to one template.
- Hydraulic control over 130° in both swings.
- Closing speed and latching speed controlled by two independent thermodynamic valves to ensure consistent performance.
- Overpressure valve relief.
- Interchangeable spindles: Italian and German, from + 0 to + 30 mm.
- Cover plate and eyelet in polished and satin stainless steel for a consistent aesthetic appeal.
- EN1154 certified.
-  mark.

Specification text:

Floor Spring MAB7600, for doors up to 120 kg; fix Size EN3 for doors ≤ 950 mm; EN4 for doors ≤ 1100 mm; EN1154 certified. Non-handed, also suitable for double action doors. Cement box 40 mm only to suit thin slabs. Wide range of adjustments within the cement box. Hydraulic control over 130° in both swings. Closing speed and latching speed controlled by two independent thermodynamic valves. Variable pivot point 51-59 mm. Including hot zinc plated cement box, Interchangeable Italian or German spindle and cover plates. Cover plate and eyelet material and finish: polish stainless steel, satin stainless steel. Fire doors suitable.

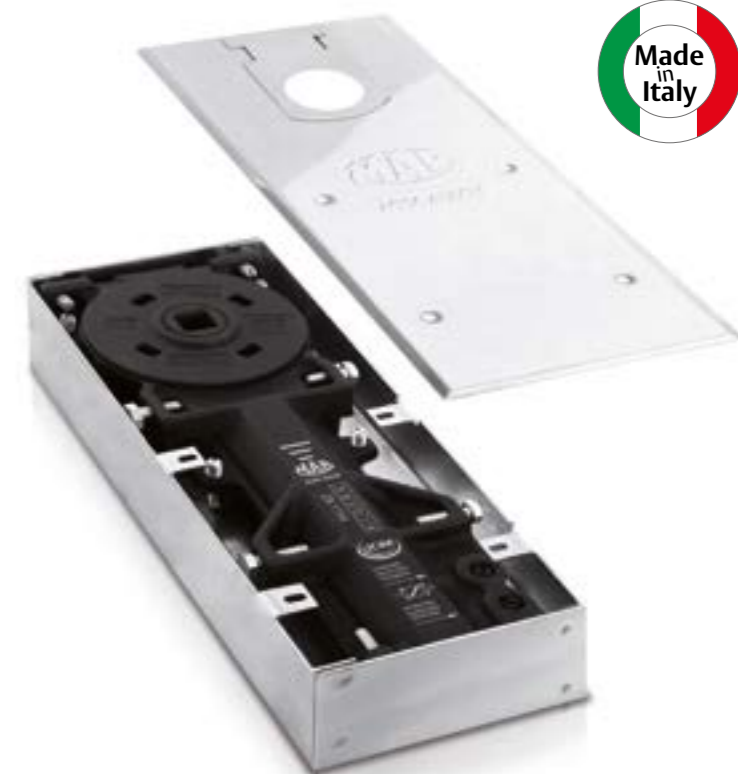

	ASSA ABLOY Italia S.p.A. Via Bovaresa 13 - 40017 San Giovanni in Persiceto (BO) Italy	15
0425-CPR-2866	EN1154:1996+2002+AC:2006	3 8 4 1 1 4



	ASSA ABLOY Italia S.p.A. Via Bovaresa 13 - 40017 San Giovanni in Persiceto (BO) Italy	15
0425-CPR-2865	EN1154:1996+2002+AC:2006	3 8 4 1 1 4

Technical drawing

Regolazione cassetta:

- Angolare 4° .
- Frontale 7mm.
- Verticale 2mm.

Adjustment within cement box:

- Angolare 4° .
- Front 7mm.
- Vertical 2mm.

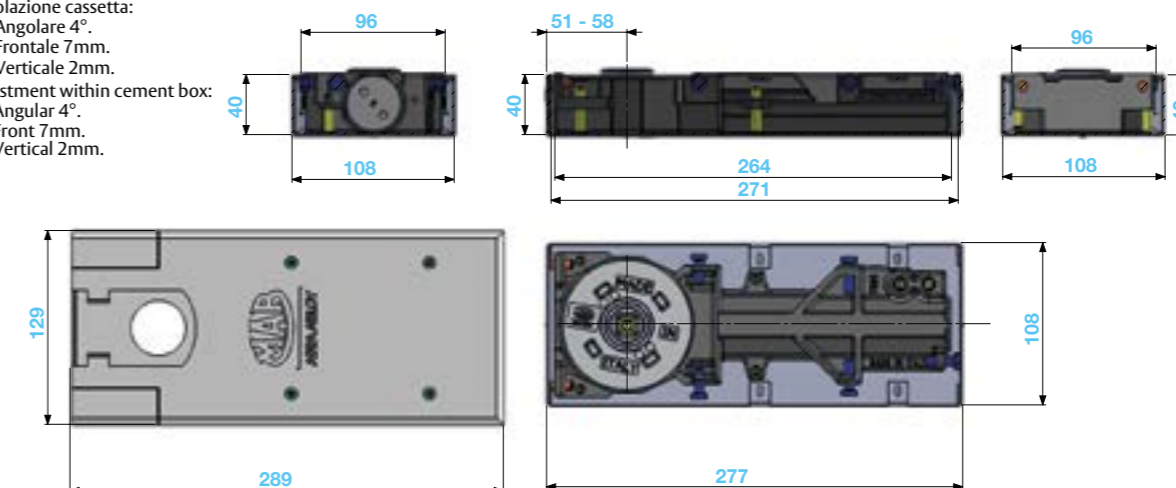



4200 Series floor spring for thin slabs

Vertical adjustment and interchangeable spindle

Features:

- One body size in three force sizes EN2-3-4 for doors 750-1100 mm wide.
- Universal for right, left or double action doors.
- Cast iron body.
- Suitable for timber, metal and glass doors.
- Suitable for door up-to 100 Kg
- Recommended for thin slabs.
- Adjustment in all directions within the cement box to help solve the problems of uneven floors without taking down the door.
- Pivot point 55 - 65 mm without re-locating the cement box.
- Thanks to one only template. Particularly user friendly in case of double action glass doors.
- Vertical adjustment within the cement box in addition to possibility of extended spindle.
- Hydraulic control over ~175° in both swings.
- Handed version with control from 180° available on request.
- Closing speed controlled by two easily adjustable non critical valves.
- Soft closing or powerful latching action adjusted by valve to ensure proper closing also in case of hard to latch locks.
- Variety of available spindles: square Italian, square French, rectangular German.
- Interchangeable spindle from 0 to + 30 mm.
- Architectural finishes: coverplates in polished s/steel, satin s/steel, polished brass.
- All models have quality certification EN1154. Versions force EN3-4, without Hold Open, have conformity 

Specification text:

Floor spring for thin slabs, forces EN 2-4, certified EN 1154, vertical adjustment within cement box, two independent speed valves, hydraulically controlled closing from ~ 175°, variable pivot point 55-65 mm, MAB 4200.



	ASSA ABLOY Italia S.p.A. Via Bovaresa 13 - 40017 San Giovanni in Persiceto (BO) Italy		04			
	0425 D0.0524	EN 1154:1996+A1:2002	3	8	3	1

	ASSA ABLOY Italia S.p.A. Via Bovaresa 13 - 40017 San Giovanni in Persiceto (BO) Italy		04			
	0425 D0.0525	EN 1154:1996+A1:2002	3	8	4	1



Technical drawing

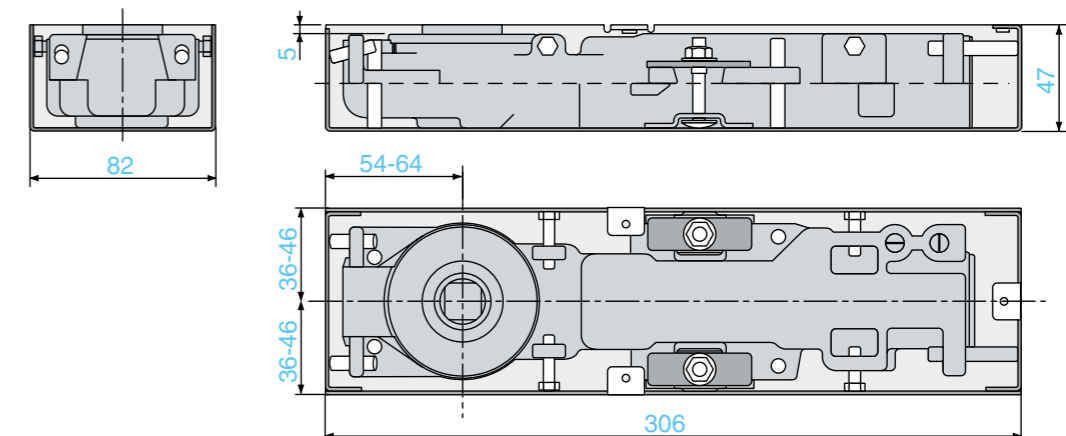



Universal floor spring 7700

Adjustable power and mechanical back check



Features:

- Body in high duty cast iron.
- Adjustable power EN 2-4 by means of stepless governor which coupled with high efficiency allows a real personalization of opening/closing forces.
- Universal for right, left or double action doors.
- Suitable for doors up-to 170 Kg.
- Suitable for timber, metal and glass doors.
- Ideal for residential interiors thanks to adjustable opening/closing force that makes door opening/closing easy.
- Large range of adjustment within cement box to solve possible alignment problems on site without taking down the door.
- Opening up to 180° in both swings with hydraulic control from approx 150°, hold open at 90°, 105° or any angle between 150° and 180°. The non hold open version has a back stop at 150°.
- Closing speed controlled by two easily adjustable independent thermostatic valves: soft closing or powerful latching action to ensure proper closing also in case of hard-to-latch locks.
- Over pressure valve to safe guard the mechanical components in case of abuse.
- Mechanical back check to prevent uncontrolled openings.
- Variety of available spindles: square Italian (standard), square French, rectangular German, spindles.
- Interchangeable spindle from 0 to + 30 mm.
- Architectural finishes: cover plates in polished stainless steel, satin stainless steel, polished brass.



Specification text:

Adjustable power floor spring with stepless power adjustment EN3-6, certified **CE** two closingspeed valves with independent hydraulic circuits, interchangeable spindle, mechanical Back Check, overpressure relief valve, vertical adjustment within cement box, max. load 170 kg, MAB 7700 series.



CE		ASSA ABLOY Italia S.p.A. Via Bovaresa 13 - 40017 San Giovanni in Persiceto (BO) Italy				10	
0425 D0. 2221	EN 1154:1996+A1:2002	3	8	2	1	1	4

Technical drawing

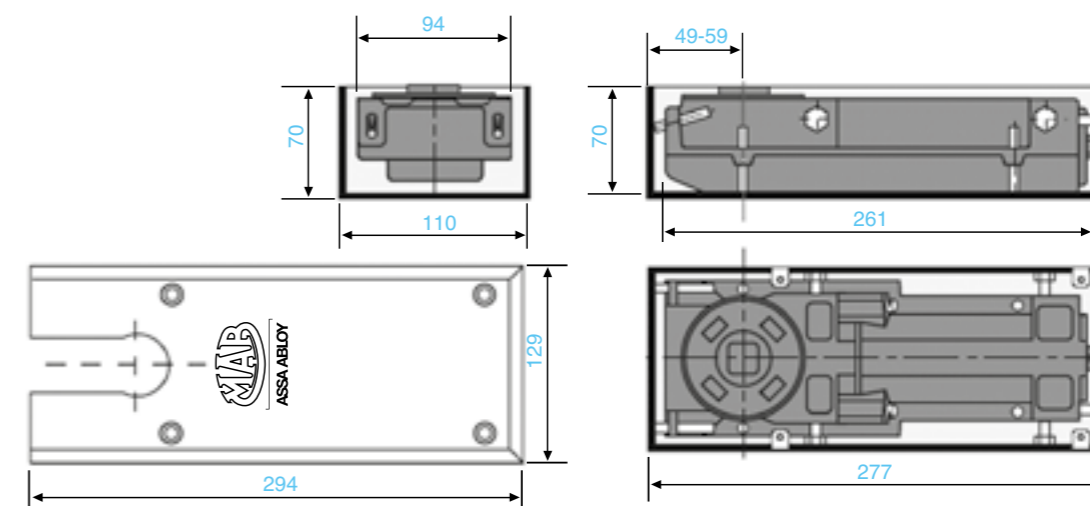



Heavy duty floor spring 750

Adjustable power for large and very heavy doors

Features:

- Body in high duty cast iron.
- Adjustable power EN 3-6 by means of stepless governor which coupled with high efficiency allows a real personalization of opening/closing forces.
- Recommended for large and very heavy doors up to 300 kg thanks to large piston displacement that ensures a real hydraulically controlled damping action.
- Closing from approx 175° in both swings under hydraulic control. Handed version with control from 180° available on request.
- Two independent thermostatic valves for precise adjustment of general closing speed, final latch or final damping.
- Hold open at 90°, 105° or non hold open.
- Back Check effect.
- Overpressure relief valve to protect unit against abuse.
- Large range of adjustment within cement box to solve possible alignment problems on site without taking down the door.
- Cement box in hot zinc plated steel.
- Variety of available spindles: square Italian, square French, rectangular German.
- Interchangeable spindle from 0 to + 30 mm.
- Architectural finishes: coverplate in polished s/steel, satin s/steel, polished brass.
- Delayed closing action (optional) between approx. 175° and 80° controlled by hydraulic valve. With this option final latch is not performed.
- All models have quality certification EN1154. Version without Hold Open has CE conformity.

Specification text:

Heavy duty floor spring with stepless power adjustment EN3-6, certified CE, two closing speed valves with independent hydraulic circuits, interchangeable spindle, mechanical Back Check, overpressure relief valve, vertical adjustment of 9 mm within cement box, max. load 300 kg, MAB 750 series.



CE		ASSA ABLOY Italia S.p.A. Via Bovaresa 13 - 40017 San Giovanni in Persiceto (BO) Italy				04	
0425 D0. 0663	EN 1154:1996+A1:2002	3	8	3	6	1	4

Technical drawing

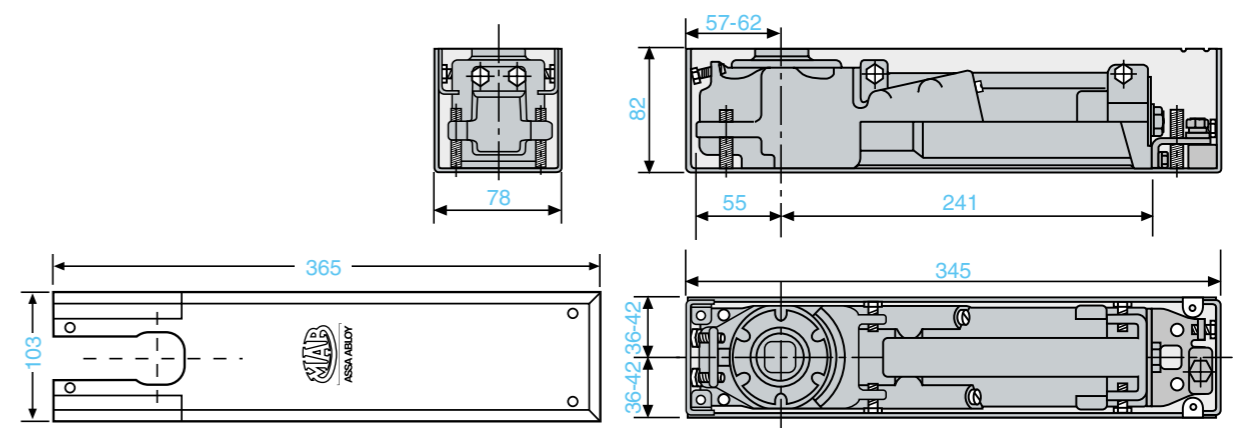

Floor Springs Accessories

Accessories for timber and metal door

Code

Bottom arm in steel for double action doors.
Square Italian spindle.

AC 213



max. 170

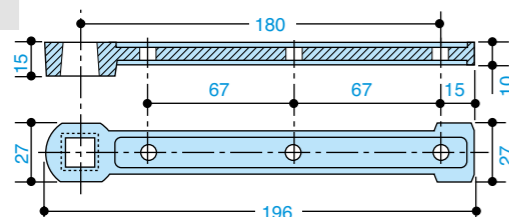

Code

Reversible bottom arm in steel for double action doors. Square Italian spindle

AC 115



max. 300

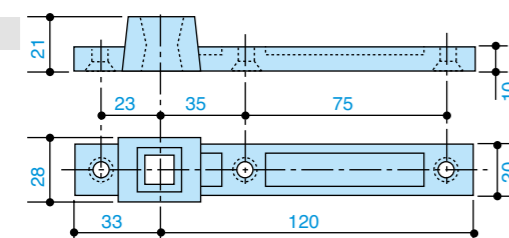

Code

Double acting top pivot.

AC 8

max. 300

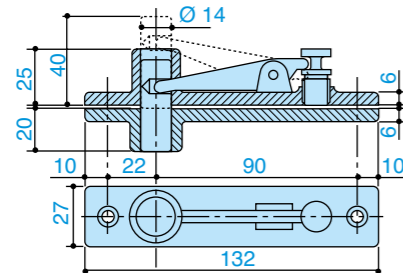

Code

Double acting top pivot. Adjustable pivot point.

AC 118

max. 170

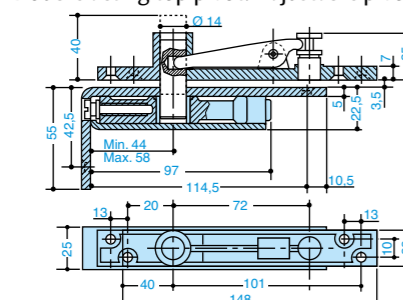

Code

Right and left bottom arm in steel for single acting doors, 36 mm offset.
Square Italian spindle.

AC 583



max. 300

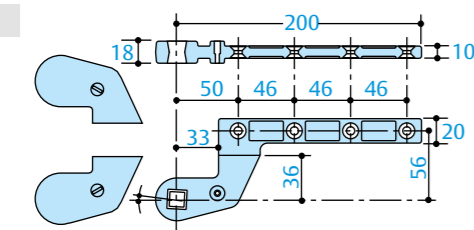

Code

Bottom arm in steel for double action doors.
Rectangular German spindle.

AC 298



max. 300

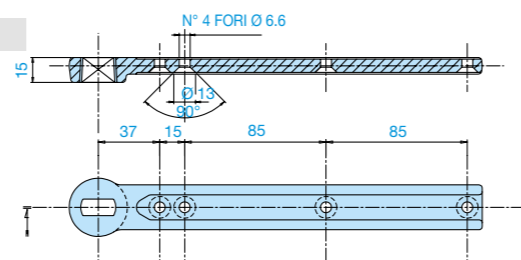

Code

Bottom arm in steel for double action doors.
Square Italian spindle.

AC 297



max. 300

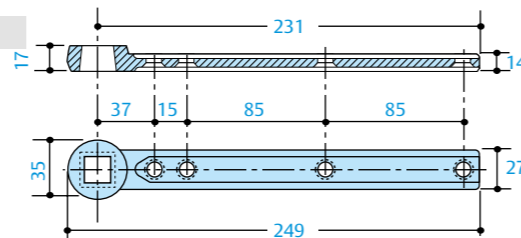

Code

Bottom arm in brass for double action doors.
Square Italian spindle.

AC 2

max. 100

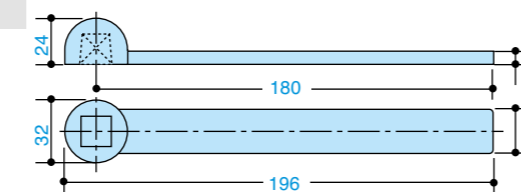

Code

Reversible bottom arm in steel for double action doors. Rectangular German spindle.

AC 393



max. 300

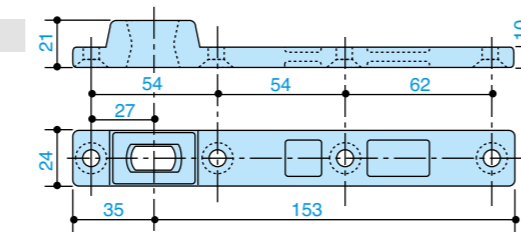

Code

Double acting top pivot in full steel with self lubricating bushing.

AC 375



max. 300

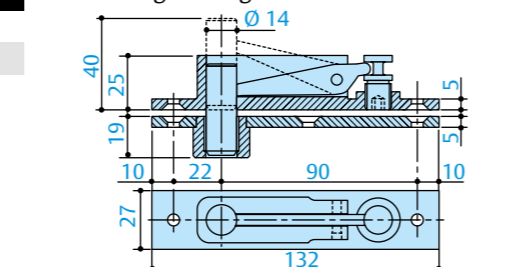

Floor Springs Accessories

Accessories for timber and metal door

Code

Top pivot in steel for left or right doors
36 mm offset.

AC 384



max. 300

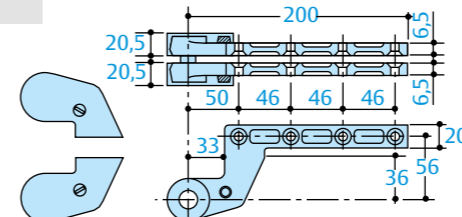

Code

Left bottom arm in natural brass for single acting doors. Square Italian spindle.

AC 3

max. 100

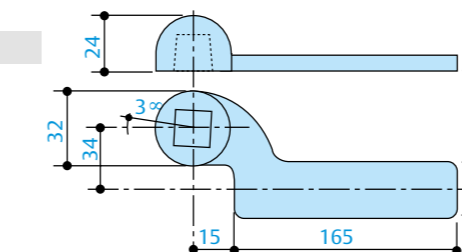

Code

Right bottom arm in natural brass for single acting doors. Square Italian spindle.

AC 1

max. 100

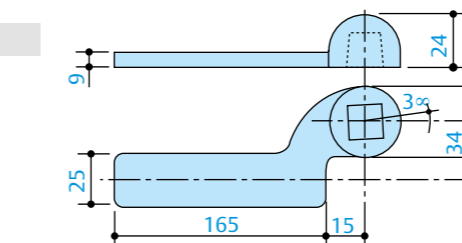

Code

Right and left bottom arm in steel for single acting doors, 36 mm offset. Rectangular German socket.

AC 392



max. 300

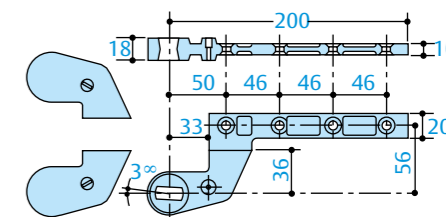

Code

Single acting top pivot in natural brass with ball bearing for right or left doors.

AC 7

max. 100

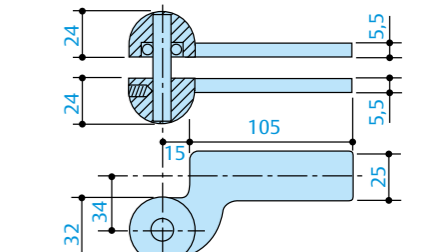

Detachable spindles

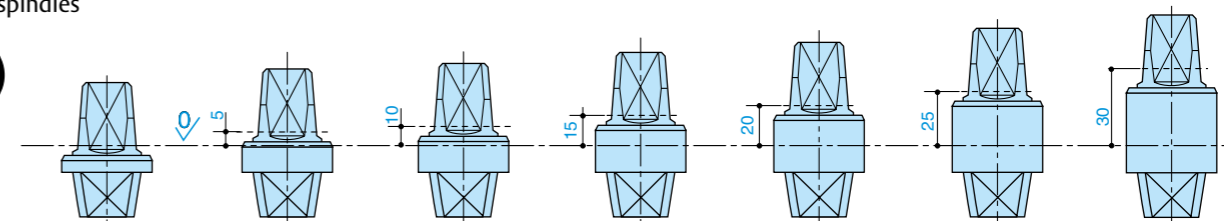

Code	Code	Code	Code	Code	Code	Code
AC 340	AC 341	AC 342	AC 343	AC 344	AC 345	AC 346
AC 360	AC 361	AC 362	AC 363	AC 364	AC 365	AC 366

Patch fittings for glass doors

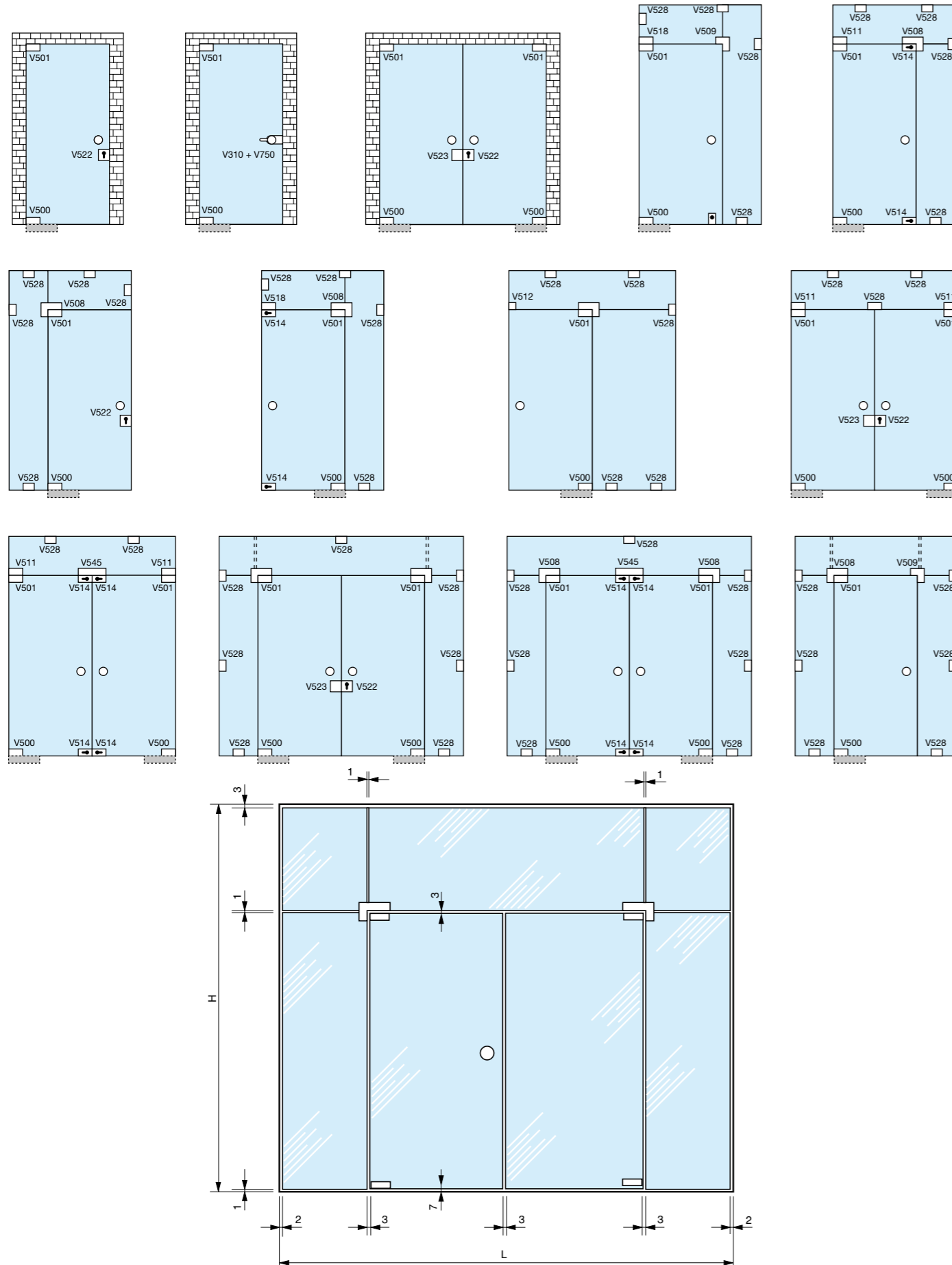

V 502

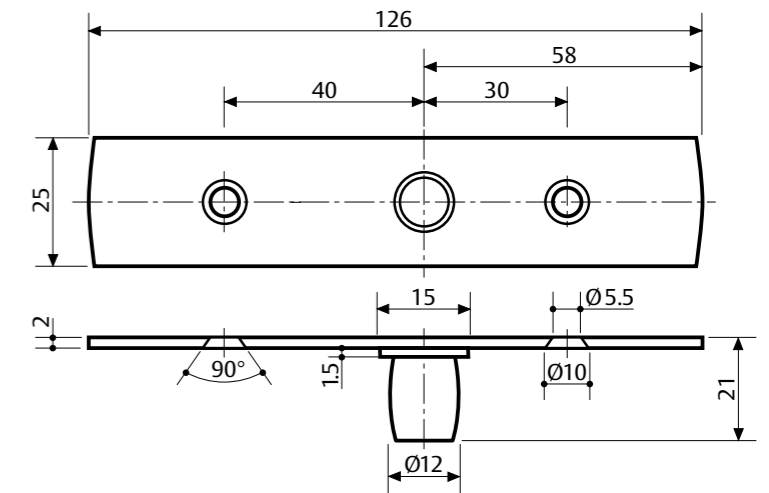
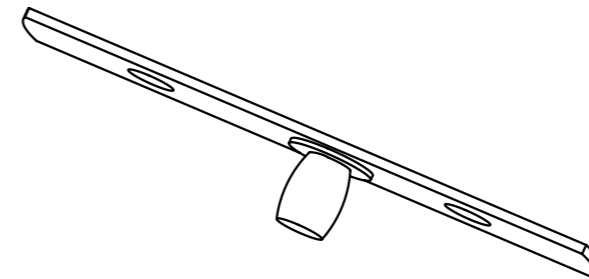
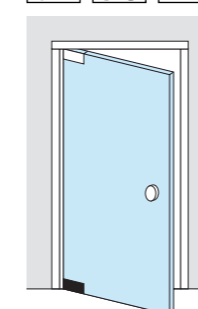
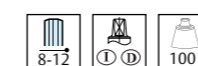
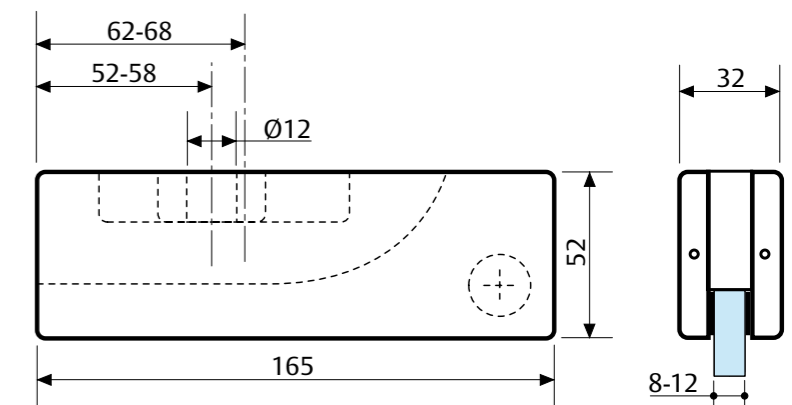
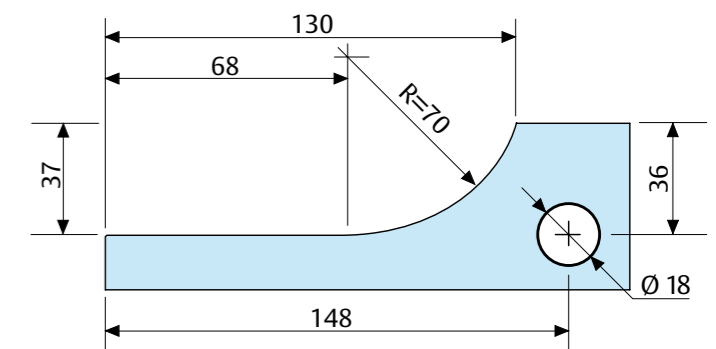
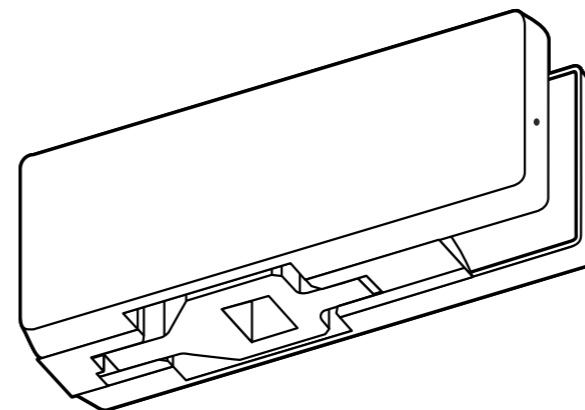

Plate with pivot for top hinge V 501

V 500



Bottom hinge for centre-hung doors



Satin S/Steel Polished S/Steel Aluminium anodized

V 501

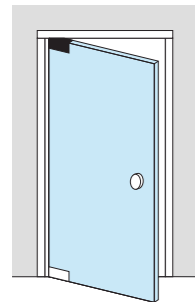
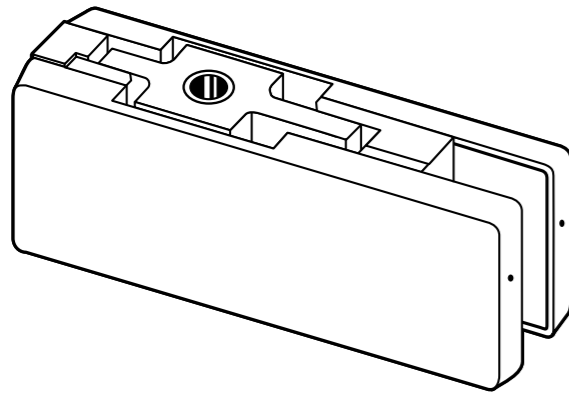

Top hinge for centre-hung doors



Satin S/Steel Polished S/Steel Aluminium anodized

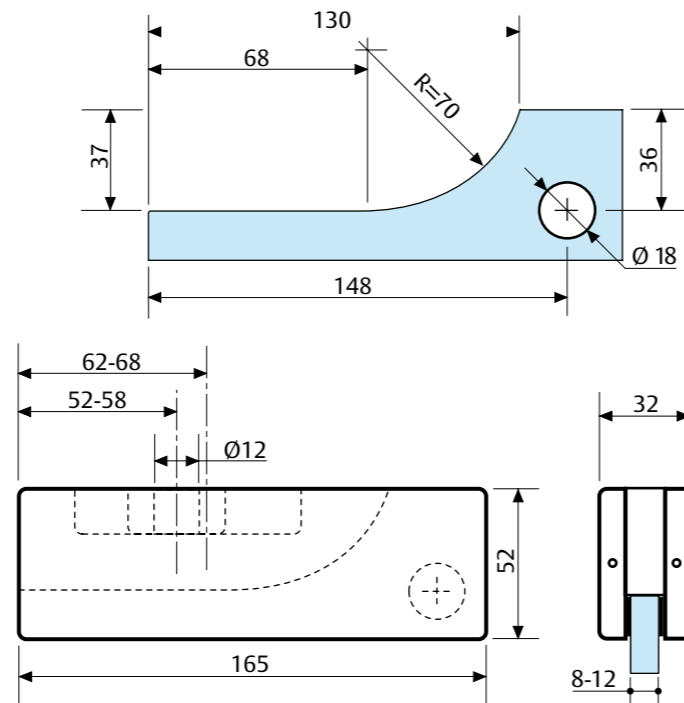

V 522

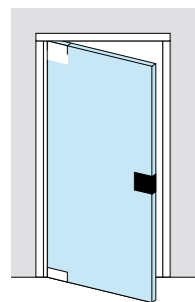
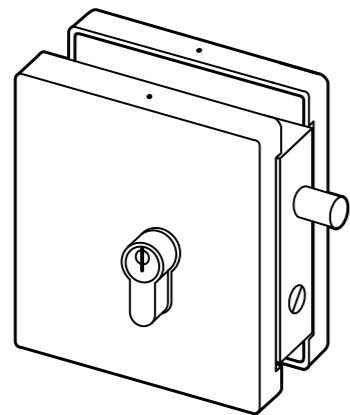

Centre lock (cylinder not included)



Satin S/Steel Polished S/Steel Aluminium anodized

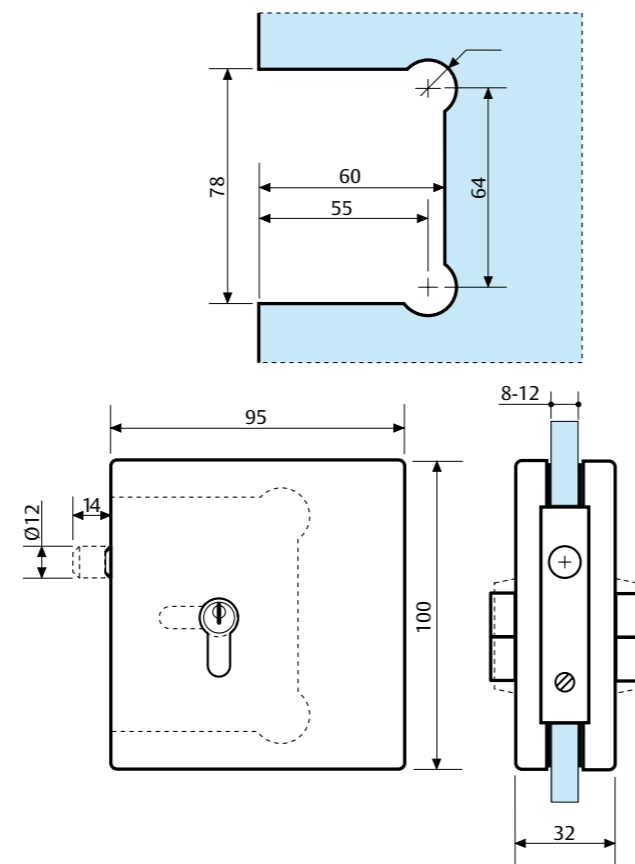

V 523

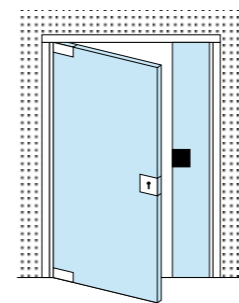
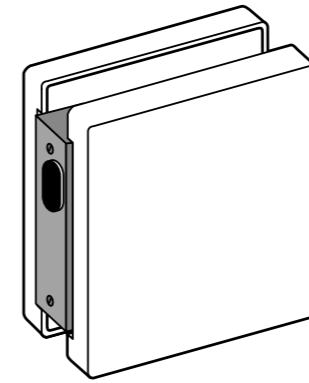

Strike patch for centre lock



Satin S/Steel Polished S/Steel Aluminium anodized

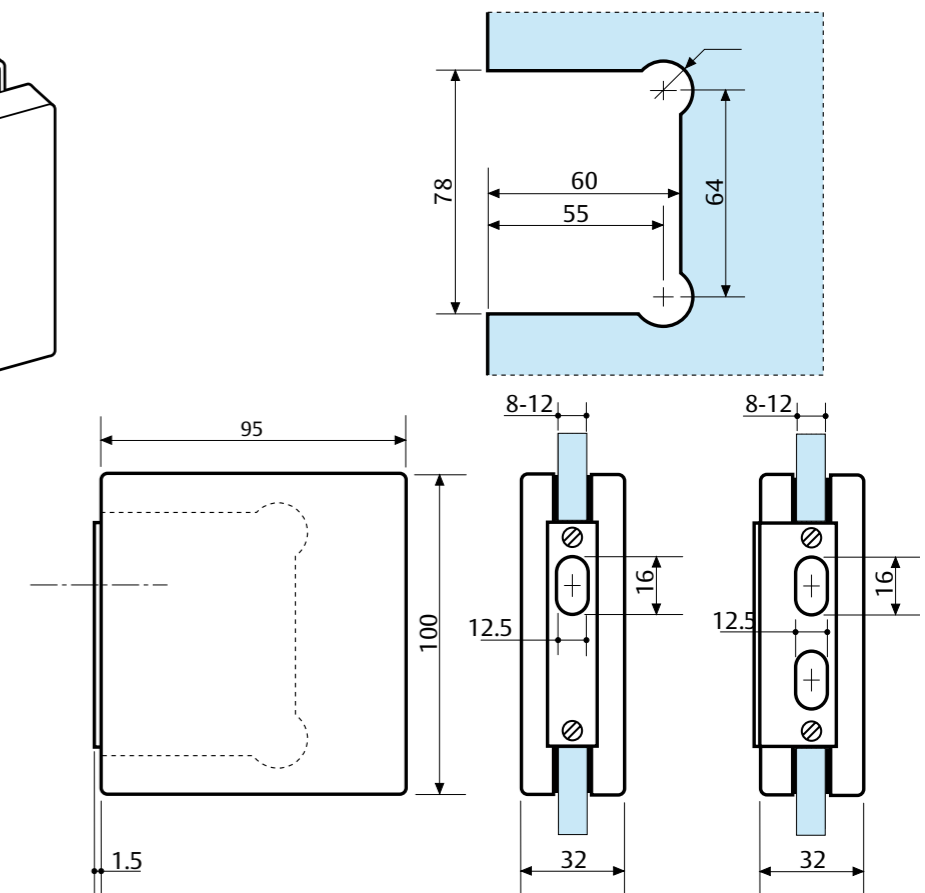

V 508

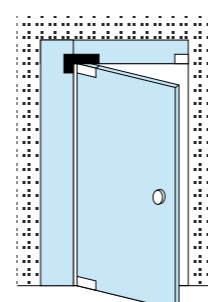
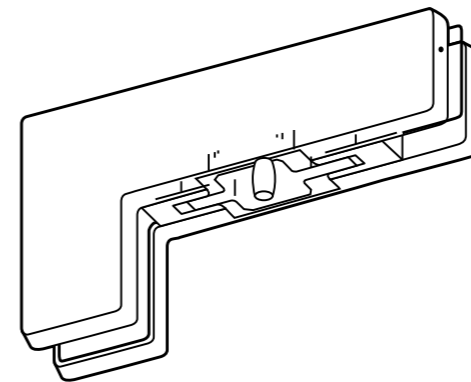

Transom and side panel ink patch (hinge side) with pivot



Satin S/Steel Polished S/Steel Aluminium anodized

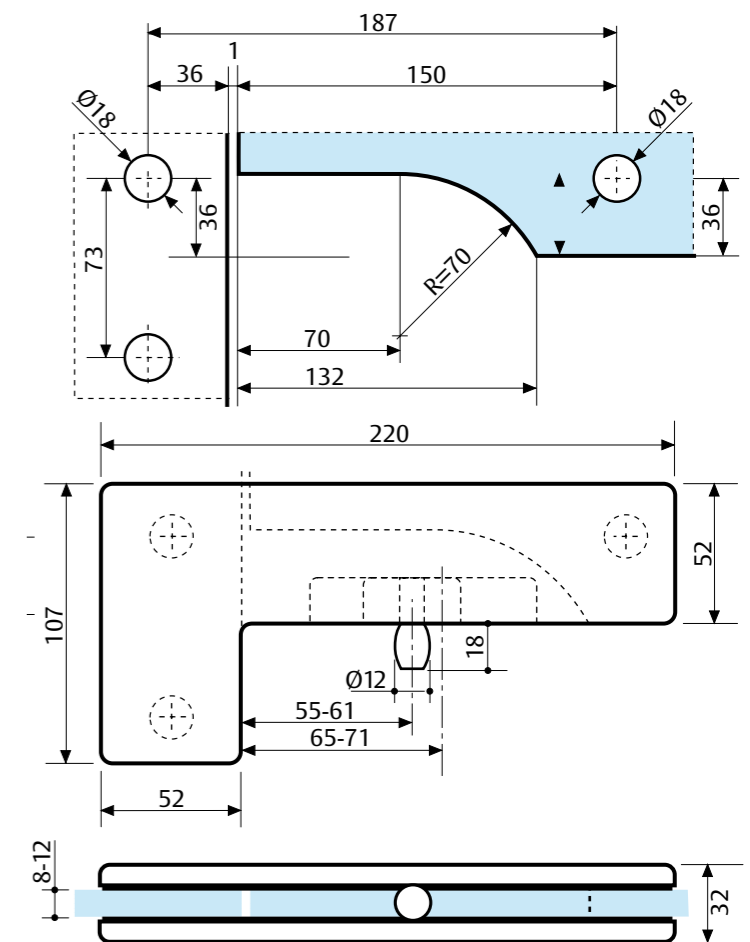



Transom concealed door closer 5600

Low opening force

Features:

- Body in high duty cast iron.
- High efficiency hardened steel mechanism.
- Low opening force.
- Two independent, non-critical closing speed valves.
- Fully adjustable final latch.
- One body size.
- Power sizes 1 - 2 - 3 according to EN / ANSI.
- Available with hold open at 90°, 105° or non hold open.
- Standard spindle height mm 21.

Specific features:

The high efficiency (min. 70%) and the particular design of the mechanism enable the door to be opened with low and constant effort from 0° through 90° in compliance with ADA (USA) and CEN TR15894 requirements for interior and exterior doors.

Power size 1 (for interior doors): max opening force through 90° less than 17 Nm.

Power size 2 (for exterior doors): max opening force through 90° less than 29 Nm.

Specification text:

Overhead concealed closer for centre hung doors, power sizes EN 3, with low opening force, ADA and CEN TR 15894 compliant, MAB 5600 series.



Technical drawing

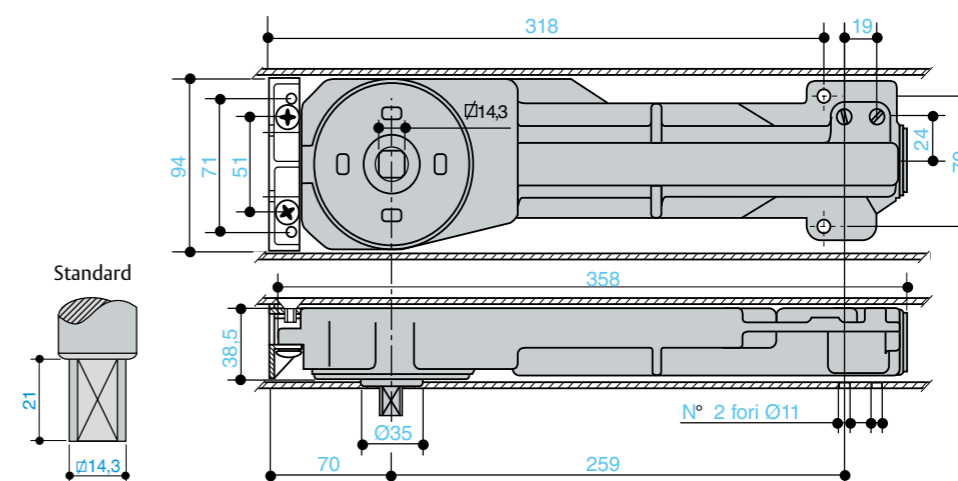



Overhead concealed closer

Adjustable power spring

Features:

- High grade cast iron body.
- High efficiency, hardened steel mechanism.
- Minimum power setting meets ADA ext. requirements.
- Two independent, non-critical closing speed valves.
- Fully adjustable final latch.
- Closing power adjustable size 2 - 5 EN / ANSI.
- Totally interchangeable with MAB 5600.
- Available with hold open at 90°, 105° or no hold open.
- Standard spindle height 21 mm. Optional 16 mm.

Specific features:

The adjustable power makes it a universal closer. One model suitable for a large variety of door sizes and variable field conditions:

- SIMPLIFIES specifications.
- REDUCES stock requirements.
- ALLOWS a totally customized opening or closing force.
- MINIMIZES on-site problems.

Adjusted to minimum power (size 2), the door closers of this series allow a low effort door opening from 0° to 90° in compliance with ADA (USA) requirements for exterior doors.

Power size 2: Max opening force through 90° less than 29 Nm.

Specification text:

Overhead concealed closer, with adjustable power EN 2-5, with low opening force, MAB 5750.



Technical drawing

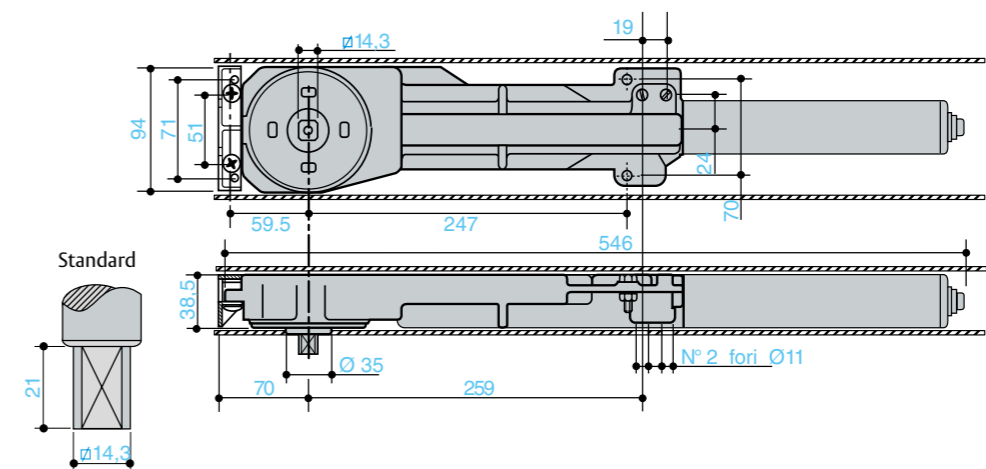



Gate closer 620 C

To make sure that the gates are closed at all times

Features:

- Body in high duty cast iron
- Fixed size EN1, for gate width up to 1000 mm
- Two closing speeds independently controlled by thermostatic valves
- Pinch free sliding arm & rail for safe use
- Soft opening and strong closing
- Suitable for gates with or without protruding bars
- Extremely easy to install (No welding needed)
- Equipped with all mounting screws and accessories
- Coated with strong resistance corrosion paint
- Finish: black, silver and white

Specification text:

Gate closer with sliding arm, for gate width up to 1000 mm, MAB 620C series



Technical drawing

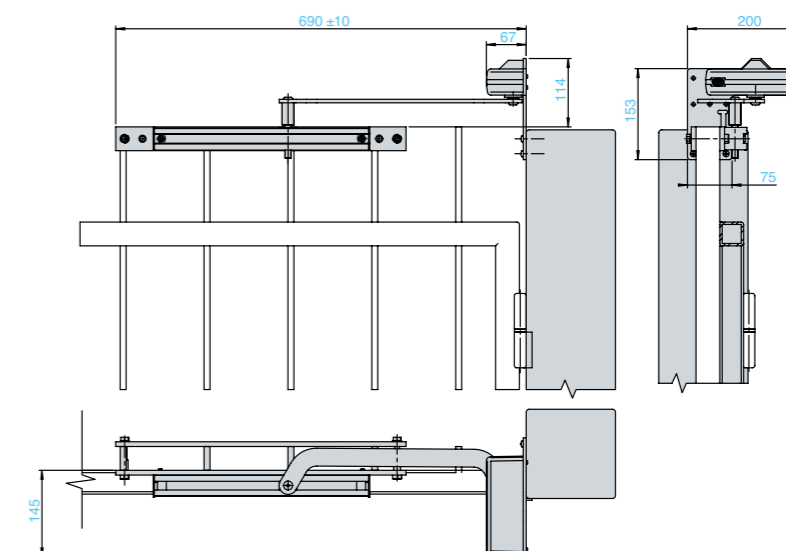



Gate closer 650 C

To make sure that the gates are closed at all times

Features:

- Body in high duty cast iron.
- Fixed size EN2, for gate width up to 1250 mm.
- Two closing speeds independently controlled by thermostatic valves.
- High thermal stability ensured at different temperatures.
- Pinch free sliding arm & rail for safe use.
- Soft opening and strong closing.
- Suitable for gates with or without protruding bars.
- Extremely easy to install (No welding needed).
- Equipped with all mounting screws and accessories.
- Coated with strong resistance corrosion paint.
- Finish: black, silver and white.



Specification text:

Gate closer with sliding arm, for gate width up to 1250mm, MAB 650C series.

Technical drawing

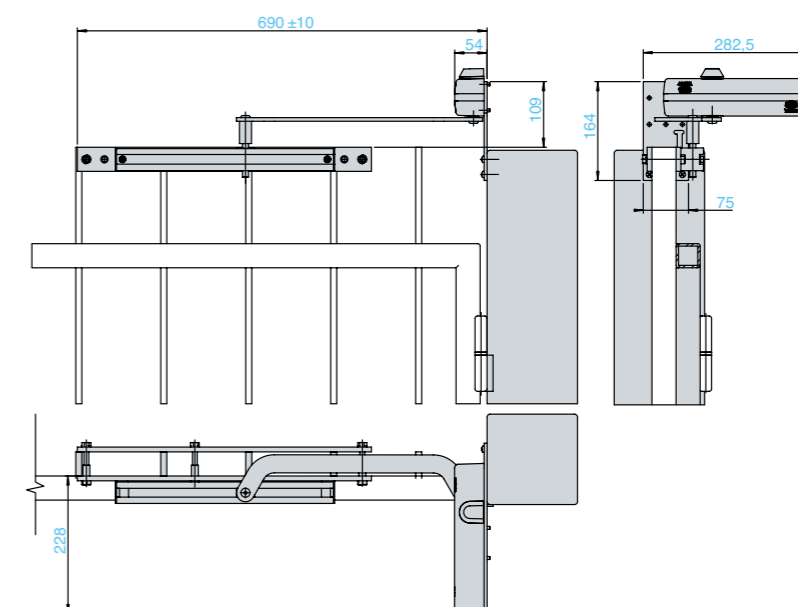



Gate closer 680 C

To make sure that the gates are closed at all times



Features:

- Body in high duty cast iron.
- Adjustable size EN1-3, for gate width up to 1400 mm.
- Two closing speeds independently controlled by thermostatic valves.
- High thermal stability ensured at different temperatures.
- Pinch free sliding arm & rail for safe use.
- Soft opening and strong closing.
- Suitable for Gates with or without protruding bars.
- Extremely easy to install (No welding needed).
- Equipped with all mounting screws and accessories.
- Coated with strong resistance corrosion paint.
- Finish: black, silver and white.



Specification text:

Gate closer with sliding arm and adjustable size EN1-3, for gate width up to 1400 mm, MAB 680C series.

Technical drawing

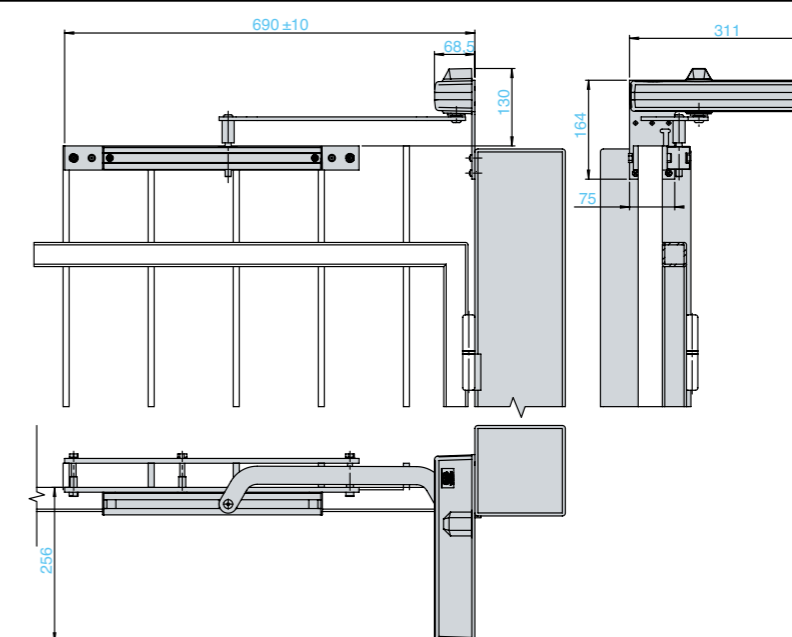



Note

ASSA ABLOY is the global leader in door opening solutions, dedicated to satisfying end-user needs for security, safety and convenience.

ASSA ABLOY Italia S.p.A.
Via Salvatore Quasimodo, 136 - 00144 Roma
Tel.: +39 051 6812411 - Fax: +39 051 827486

info@assaabloy.it - www.assaabloy.it